



The AMERICANS

Quality Cruising Yachts

JOHNSTON - McINTOSH YACHT SALES
2244 WEST PACIFIC COAST HIGHWAY
NEWPORT BEACH, CA., 92660
(714) 642-1922 (714) 642-1292

22

Available for Delivery
Sept., 1976

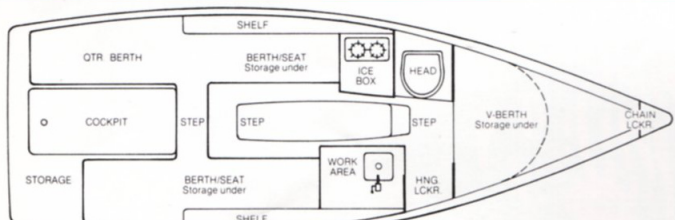

SPECIFICATIONS

L.O.A. . . . 22'0"
L.W.L. . . . 20'0"
Beam . . . 7'10"
Maximum Draft . . . 26"
Freeboard to Bow . . . 40"
Transom Height
& Freeboard . . . 33"
Transom Width . . . 6'
Cabin Headroom approx. 6'
Displacement . . . 2,800 Lbs.
Internal Lead Ballast
800 Lbs.
Sail Area . . . 200 Sq. Ft.
Jib . . . 120 Sq. Ft.
Main . . . 80 Sq. Ft.



24

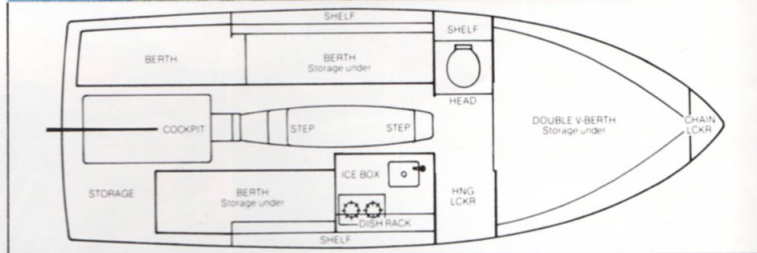

SPECIFICATIONS

L.O.A. . . . 23'8"
L.W.L. . . . 21'8"
Beam . . . 7'11 1/4"
Maximum Draft . . . 28"
Freeboard to Bow . . . 42"
Transom Height
& Freeboard . . . 36"
Transom Width . . . 7'
Cabin Headroom approx. 6'
Displacement . . . 3,500 Lbs.
Internal Lead Ballast
1,000 Lbs.
Sail Area . . . 220 Sq. Ft.
Jib . . . 120 Sq. Ft.
Main . . . 100 Sq. Ft.



The Extraordinary Americans . . .

designed for people who simply want to enjoy the soothing delights of sail-cruising to the fullest; people who have dreamed of finding a boat that is small enough to be easily managed yet stable in the water and with uncramped accommodations for family or guests.

The ideal cruising sailboats . . .

appreciated by the novice and experienced sailor alike; economical to enjoy and maintain with sturdy, simple rigs; fully covered stand-up headroom below; modern galleys; head compartments; plenty of storage; comfortable bunks; roomy cockpits; shoal draft; dry, sea-easy and ruggedly constructed; even trailerable to permit quick access to a variety of widely separated cruising areas.

Impossible dream?

American Mariner Industries has dramatically reduced the number of compromises cruising enthusiasts have always had to weigh. It is no longer necessary to choose between rail-down tenderness and a

bothersome centerboard swinging below. No longer must you ruefully accept cramped quarters and head-banging sitting-headroom as part of the "fun" of sailing.

Here is a selection . . .

cruising yachts which are revolutionary in many meaningful ways yet not the least bit bizarre. The Americans have a comfortable, reassuring, sturdy appearance and behavior with responsive "stand up" sailing in weather that with many another sailboat might give cause for apprehension.

Hull conformations permit maximum stability and interior roominess. The original, patented (Patent Nos. 394819 and 239375) stabilizer keel, recessed inside, provides stand-up covered headroom without recourse to a pop-up-top or excessive freeboard. In addition to solving the headroom problem, the keel allows the boats to ride low on a trailer, retain shallow draft characteristics and eliminate the usual centerboard with its problems and awkward trunk in the cabin. Molded as an integral part of the hulls, lead is bonded into the keel providing

26

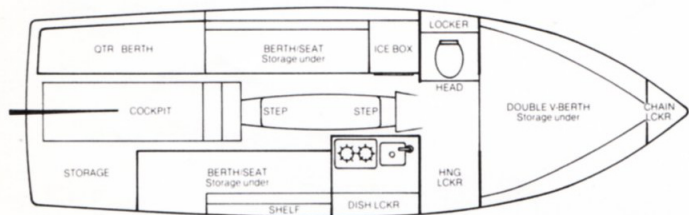

SPECIFICATIONS

L.O.A. . . . 26'6"
L.W.L. . . . 23'6"
Beam . . . 7'11 3/4"
Maximum Draft . . . 28"
Freeboard to Bow . . . 44"
Transom Height
& Freeboard . . . 38"
Transom Width . . . 7'
Cabin Headroom approx. 6'
Displacement . . . 4,500 Lbs.
Internal Lead
Ballast . . . 1,200 Lbs.
Sail Area . . . 280 Sq. Ft.
Jib . . . 150 Sq. Ft.
Main . . . 130 Sq. Ft.



28

MOTOR-SAILER

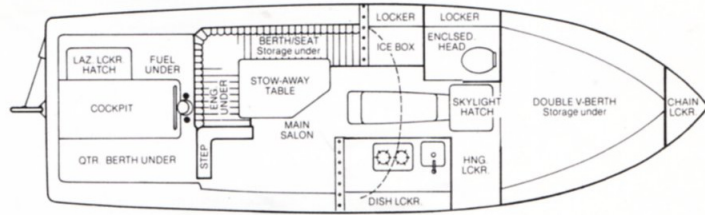

SPECIFICATIONS

L.O.A. . . . 27'6"
L.W.L. . . . 24'6"
Beam . . . 7'11 3/4"
Maximum Draft . . . 28"
Freeboard to Bow . . . 44"
Transom Height
& Freeboard . . . 42"
Transom Width . . . 7'
Cabin Headroom approx. 6'
Displacement . . . 5,500 Lbs.
Internal Lead
Ballast . . . 1,400 Lbs.
Sail Area . . . 240 Sq. Ft.
Jib . . . 140 Sq. Ft.
Main . . . 100 Sq. Ft.



the many advantages of interior ballast.

In trailering to your favorite sailing areas, your ocean-going sloop becomes a comfortable, economical, self-sufficient motor home. In launching, the American's hull configuration gives a buoyancy aft which makes floating off the trailer trouble free. Retrieving is equally simple because of their shoal draft. Padded guide-ons correctly position the keel on the trailer for quick, easy recovery.

"Rudder struggle" is eliminated in launching the Americans. No straining to set the rudder in place after launching. Simply set the rudder before launching or just leave it in position—even for trailering.

The American's hull design permits exceptional under-power performance while utilizing the most economical of auxiliary engines (6 to 10 h.p. outboard is adequate). Inboard auxiliary power is optional for the 22, 24 and 26 cruising sloops with safe, dependable and economical inboard diesel power featured as standard equipment in the 28 Motorsailer.

The very design characteristics which make the Americans so stable and sea-easy work absolute wonders to interior spaciousness.

One-piece molded fiberglass hull and cabin inner liners all but eliminate interior maintenance and condensation. Generous use of oiled teak bulkheads, cabinetry and trim blend with color-coordinated fabric cushions and carpeting to create a rich feeling of warmth and comfort. A multitude of practical design features make your cruising more enjoyable. Uncramped fully equipped galleys, each with stand-up headroom. Tables convenient to the galley, but completely stow-away when not in use. Large eye-level windows and rigid skylight forward hatches. Separate head compartments, hanging lockers, king size berths and maximum utilization of space for storage.

The Americans are built for rugged cruising. Sturdy construction techniques include hand-laid fiberglass hulls and plywood reinforced sandwich lamination in all cabin tops, decks, cockpits and transoms.

Join the Fleet of Americans . . .

sea-proven cruising sloops of many qualities seldom found combined in any sailboat. You will enjoy pride of ownership, safety, value, comfort and peace of mind.



Without compromise of interior spaciousness, cockpits are roomier and more comfortable than those of many larger boats. Large enough for the times when everybody wants to be in the cockpit and still accommodate cruising extras such as pedestal steering . . . a popular option available on all the Americans and featured as standard equipment on the 28 Motorsailer.

Standard Features and Equipment

Amenities included with each American are often found listed as options or are totally unavailable in many other sailboats of comparable sizes. The following standard features of the Americans are included at no additional charge:

One-piece white molded fiberglass hulls and decks ■ One-piece color-coordinated molded fiberglass hull and cabin inner liners ■ Exterior non-skid surface color selections ■ Hull-boot and sheer stripe trim color selections ■ Color selection of coordinated decorator interiors featuring fabric cushions, carpeting, window curtains and privacy drapes ■ Oiled teak bulkheads, interior trim, drawers and cabinetry. Spacious storage and hanging lockers ■ Complete stand-up galleys including stove, stainless steel sink and family size ice box ■ 20 gallon fresh water capacity with flush mount deck fills ■ Separate head compartments ■ Large family size berths ■ Spacious main cabins with standing headroom and large tinted windows ■ Complete 12 volt electrical and lighting systems including heavy

duty battery, fluorescent interior lighting, fused master panels and navigation lights ■ Watertight, rigid skylight forward hatches ■ Heavy duty anodized masts and booms with stainless steel rigging, halyards, chain, stem and backstay plates ■ Main and jib sheet blocks with tracks and cars ■ Mainsails and jibs complete with sheets, battens and sailbags ■ Solid teak handrails and exterior trim ■ Heavy duty removable rudders with stainless steel hardware and laminated hardwood tillers ■ Large anodized mooring cleats ■ Deep, spacious, self-draining cockpits with large storage lockers ■

In addition to the full range of standard items listed above, a wide selection of quality options are available for the American of your choice.

For detailed specification, price and optional equipment lists contact your local American dealer or AMI for additional information and the dealer nearest you.



American Mariner Industries

Manufacturers of Quality Fiberglass Boats

1945 Placentia, Costa Mesa, California 92627 • (714) 645-4050