

# BUCCANEER 270



## Manufacturer's comment:

If you like sailing, but hate being cramped-up, the Buccaneer 270 is for you. It's perhaps the largest trailerable cruising yacht ever built. With room for the entire family to sit around, without sitting on each other's laps. And room to stand up, too... 6'1" headroom in the cabin.

The Buccaneer 270 sleeps six, has a remarkable seven-foot long, king-sized berth aft, a full galley with two-burner alcohol stove, ice box, sink and fresh water. There's also a dinette that seats four, a privacy-cabin forward and an enclosed head complete with a stand-up shower.

Topside, there's a roomy cockpit and a clean, uncluttered deck. All gear for sailing comes as standard equipment on the 270, including main and jib sails, rigging, winches and lifelines.

Best of all, the Buccaneer 270 has a shoal-draft, fixed keel which provides the stability to cruise open water, yet requires only 2'3" of water to float. Trailerable: easy to launch and recover. As an added safety feature, the 270 has positive foam flotation built into the hull. You'll never see it, but it's comforting to know it's there.

When you think of it, the Buccaneer 270 is in a class by itself: spacious, safe, trailer-

able, easy to handle and fully equipped for immediate sailing. Available with inboard 10 hp diesel.

Two other Buccaneers are also available, the 210 and the 240. Both are superb boats and equipped comparable to the 270. Designed and built by Buccaneer Yachts, Division of Bayliner Marine Corporation. Plants in Arlington, Washington and Pipestone, Minnesota.

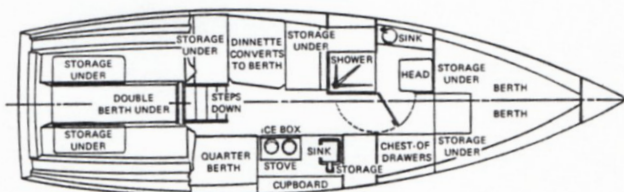

**BUCCANEER YACHTS**  
**Division of Bayliner Marine Corporation**  
**P.O. Box 24467**  
**Seattle, Washington 98104**  
**(206) 435-5571**

L.O.A. .... 26'8"  
 L.W.L. .... 23'4"  
 Beam .... 96"  
 Draft .... 2'3"  
 Sail Area: .... 285 sq. ft.

Ballast ..... 1,650 lbs.  
 Displacement .... 5,000 lbs.  
 Headroom .... 6'1"  
 Water Capacity .... 24 gal.