

CS Merlin 36

36'

CS Yachts has gracefully combined excellent performance with a host of luxurious amenities. The result is a superb performance cruising yacht . . . the CS Merlin.

A true tricabin, the CS Merlin sports a modern-sculpted deck with ergonomically designed seating, proper halyard organizers, and a clever, well organized winch layout for optimum shorthanded use.

Inside, the CS Merlin is a model of elegance, featuring spacious saloons and cabins with special attention given to good lighting and ventilation. The galley abounds with space and worktop surface, featuring a pair of deep sinks and a host of luxurious extras that must be seen to be believed.

The CS Merlin—optimum performance, classic elegance,

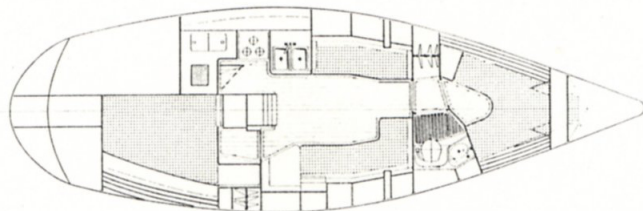

and impeccable craftsmanship. Yachting will never be the same.

L.O.A.	36' 3"
L.W.L.	29' 2"
Beam	11' 6"
Draft:	
Deep Keel	6' 3"
Shoal Keel	5' 0"
Ballast	5,590 lbs.
Displacement	13,000 lbs.
Sail Area:	
100% Foretriangle	605 sq. ft.
Designer	Tony Castro

CS Yachts Ltd.
79 Bramsteele Rd.
Brampton, Ontario L6W 3K6
CANADA
(416) 457-6713
TLX: 06-97537