

**CROSS 50**

**50**

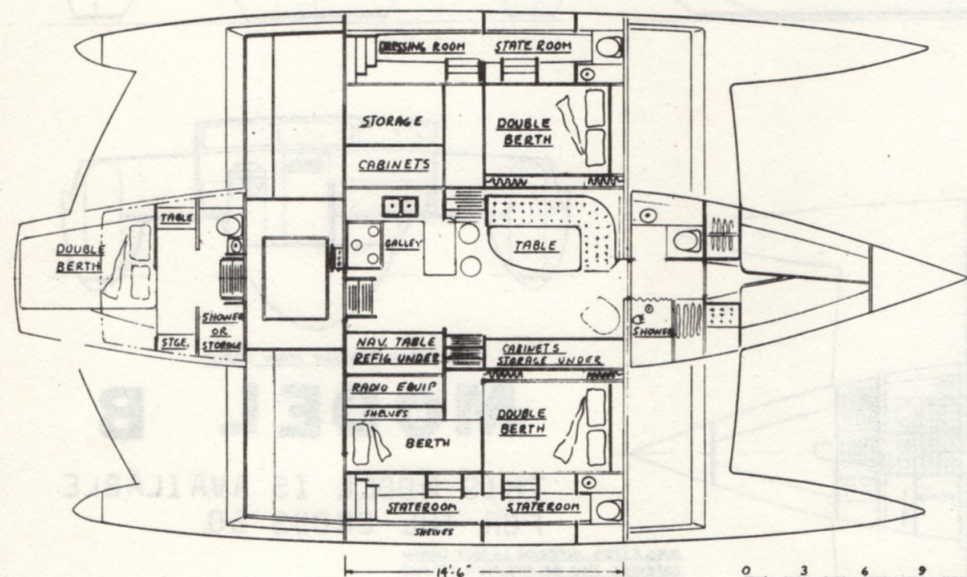
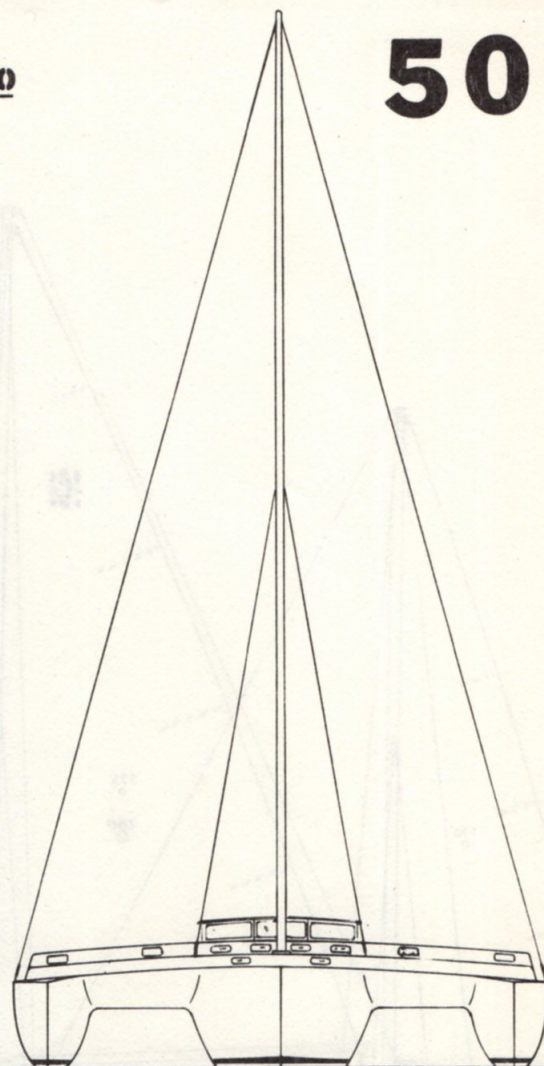
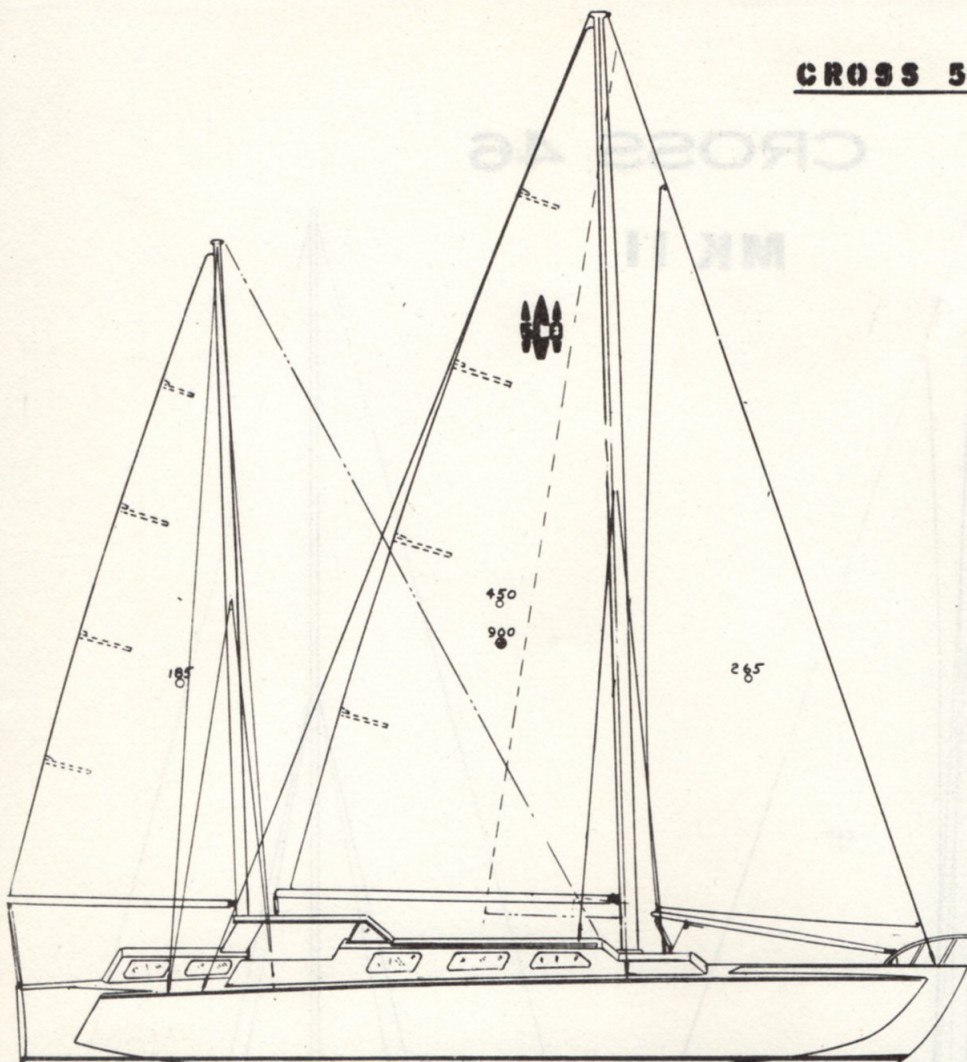

**SPECIFICATIONS**

Length Overall	49' 9"
Length Waterline	45' 8"
Beam	27' 0"
Draft	4' 8"
Sail Area	900 sq. ft.
Displacement	24,000 lbs.
Auxiliary Power	55 H. P.
No. Berths	10
Headroom	6' 3"
Hulls	Round bottom, double diagonal ply.

**CROSS 50 TRIMARAN**  
 ALTERNATE LAYOUT  
 DRWG. NO. 1050-1A SCALE 3/8"=1'  
 DESIGN BY N. A. CROSS  
 4326 ASHTON SAN DIEGO CALIF.

**MODEL C**



# CROSS 50

## CROSS 50

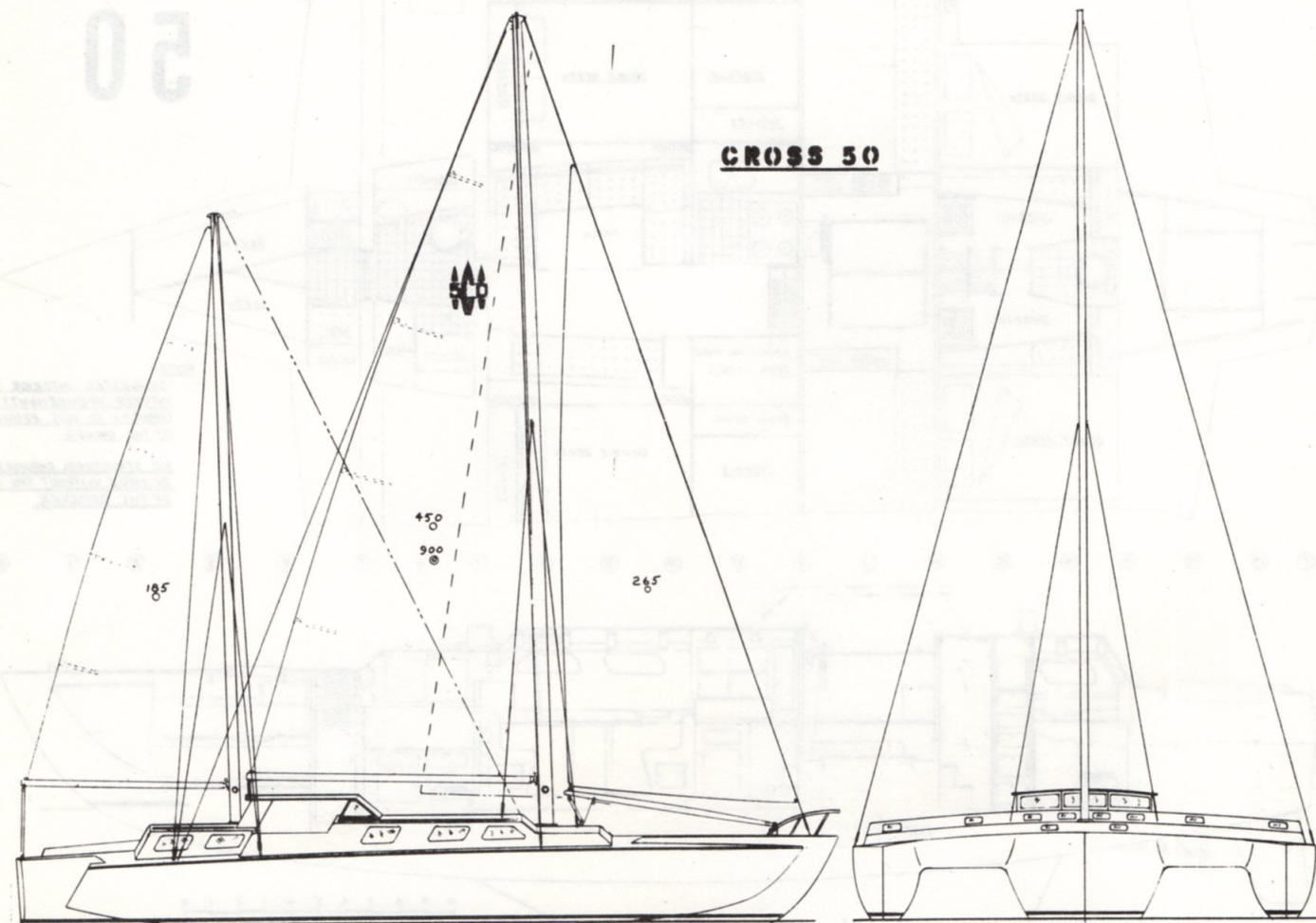

### SPECIFICATIONS

LENGTH OVERALL	49' 9"	DISPLACEMENT	24,000 lbs.
LENGTH WATERLINE	45' 8"	PAYLOAD	8,000 lbs.
BEAM OVERALL	27' 0"	AUXIL. POWER	55-65 H. P.
DRAFT (Fin Keel)	4' 8"	No. BERTHS	8 - 10
SAIL AREA (Working)	900 S. F.	HEADROOM	6' 3"

### DESIGN FEATURES

The CROSS 50 is an ideal boat for CHARTER WORK, LIVE ABOARD or CRUISING with comfortable accommodations for 8 to 10 persons.

Privacy, which is so essential, is assured in the five double staterooms, two of which have their own private head.

The main cabin is 12 1/2' long and 8 1/2' wide and has ample room for the galley and dinning areas.

A large head and shower area is located forward of the main cabin.

The two aft staterooms are separated by a common head and lockers.

Two cockpits are provided, one midship for helmsman and guests and is the full width of the boat, the other is in the stern for recreation such as swimming, fishing, skin diving, etc.

There is plenty of storage space located throughout the boat.

The combination of long waterline and light displacement should provide a hull that is easily driven, under power or sail, at a cruising speed of 8 to 10 knots.

The ketch rig with moderate working sails will be easily handled and sail area can be increased for light winds by the addition of a genoa and mizzen staysail.



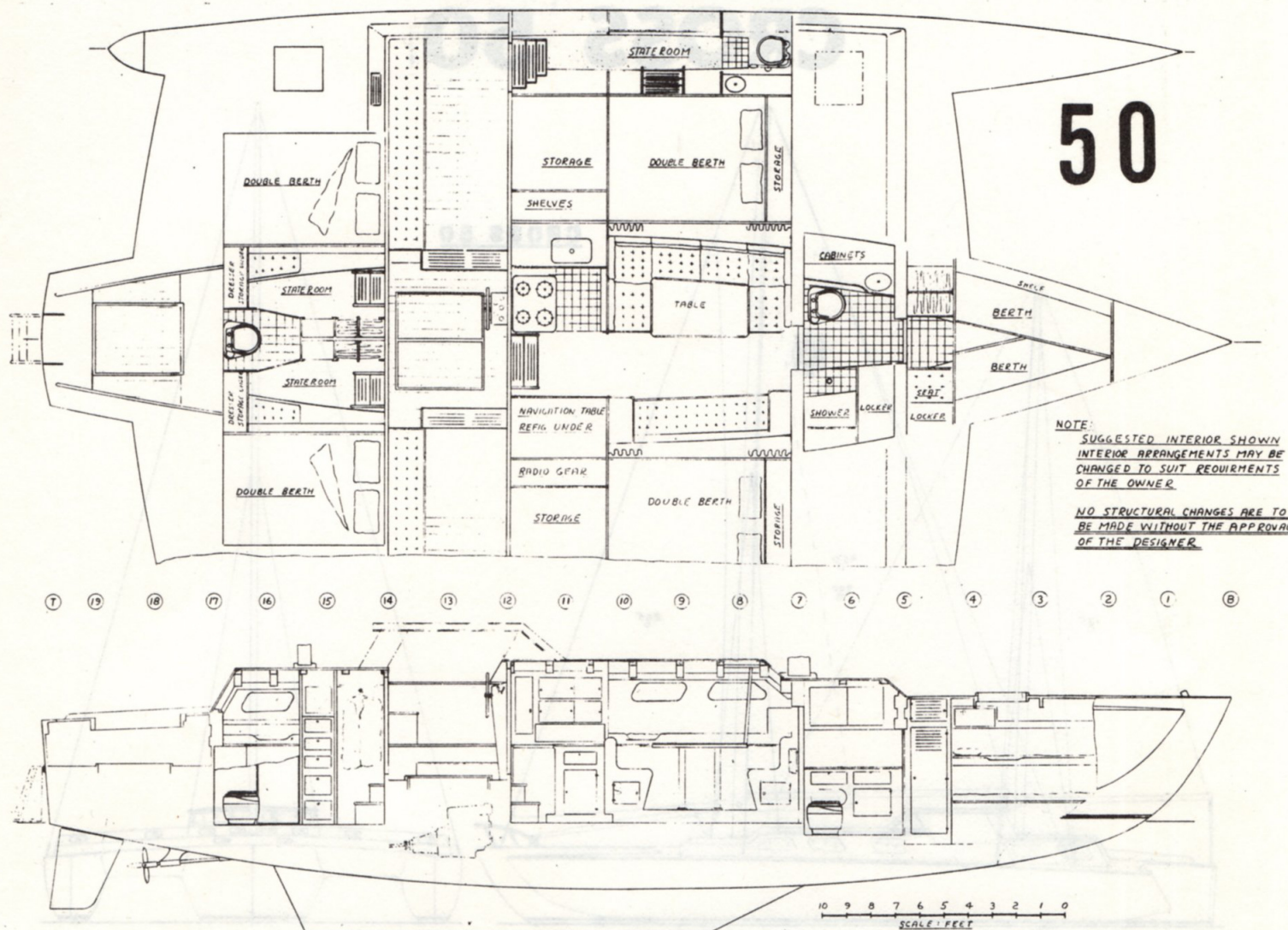

### CONSTRUCTION

The hulls are of the round bottom type using the double-diagonal strip plywood planking. Frames are laid out on and cut from sheet plywood. Bulkheads are plywood and Douglas fir ( or other suitable boat building lumber). Beams are marine plywood and Douglas fir. Stringers and longtitudinals are Douglas fir (or other suitable boat building lumber). Deck, cabin and fin keel are plywood. Fastenings are bronze Anchorfast nails, staples (for planking) and marine glue. All exterior surfaces are covered with fiberglass, dynell or vectra. Spars are of spruce spar stock, Aluminum optional. Standing rigging and fittings, stainless steel or bronze.

COST OF PLANS..... \$650.00  
 COST OF STUDY PLANS.....\$5.00  
 APPROX. COST TO BUILD.... \$24,000.00  
 (less sails & power)  
 APPROX. MAN HOURS TO BUILD.....4300

ORDER PLANS FROM:  
 NORMAN A. CROSS  
 4326 ASHTON  
 SAN DIEGO, CALIF. 92110  
 PHONE: (714) 276-0910

AS OF JANUARY 1975 THERE WERE 17 CROSS 50 TRIMARANS BUILDING OR SAILING