

FINNSAILER 34

Design Hans Groop

LOA	10,40 m
LWL	8,36 m
B _{max}	3,45 m
Draft	1,58 m
Displacement	6 t
Sail area	45,3 m ²
Engine	49 BHP
Berths	7

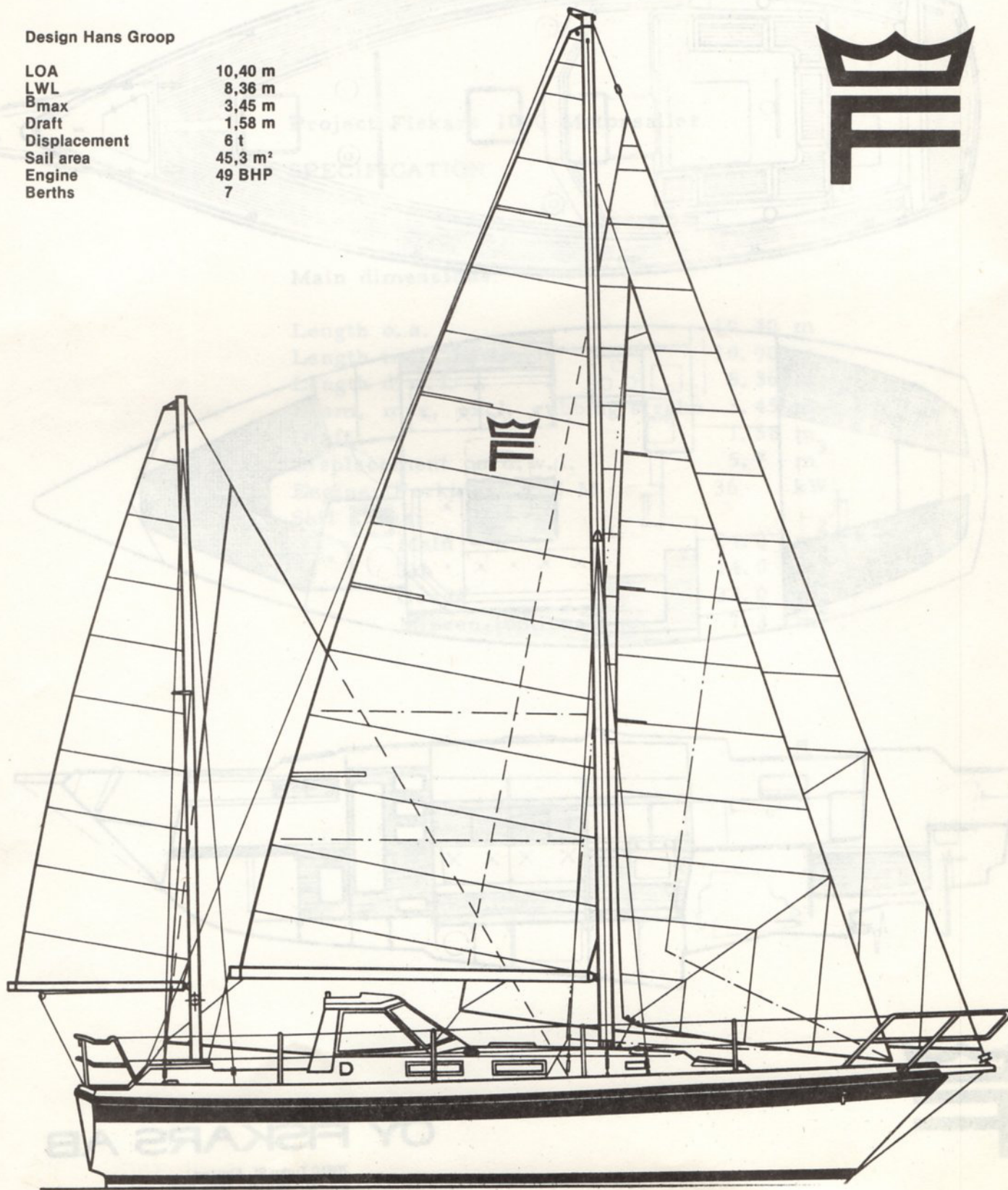

FINNSAILER 34

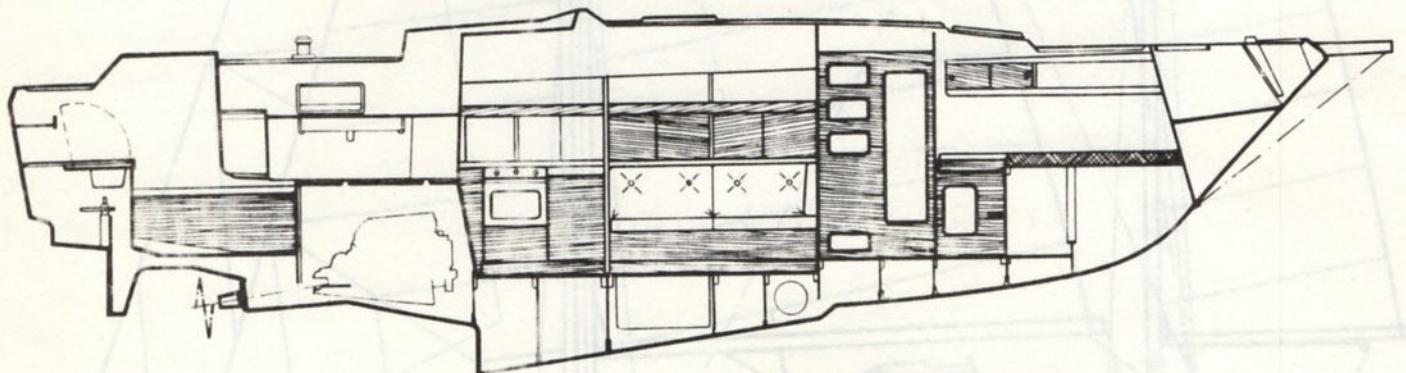
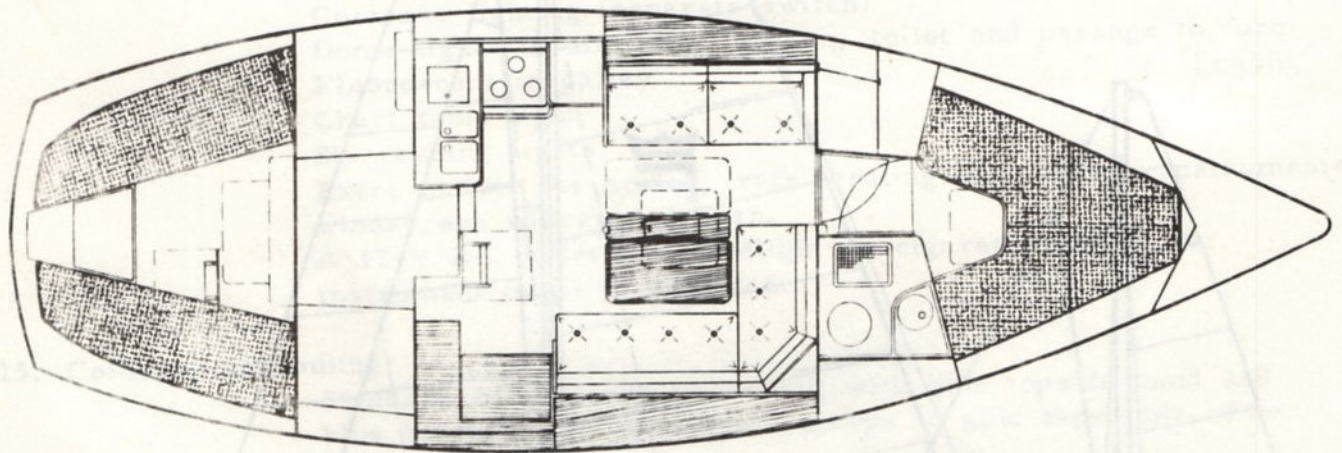
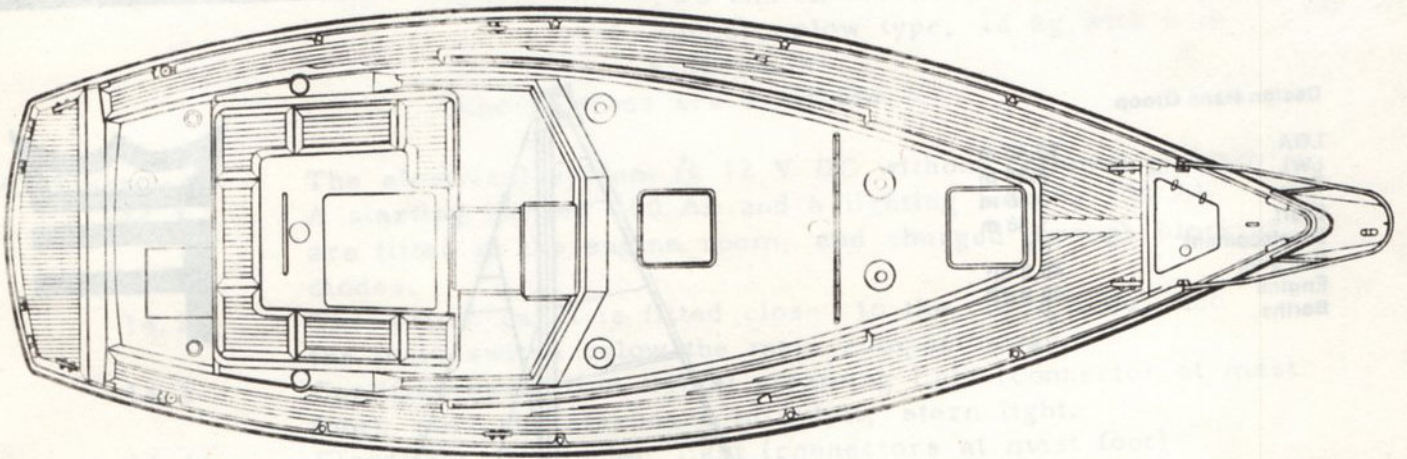

OY FISKARS AB

20810 Turku 81, Finland
Tel. 921-359100 Telex 62311 tuve sf

Project Fiskars 1040 Motorsailer

SPECIFICATION

Main dimensions:

Length o. a.	10.40	m
Length incl. bowsprit	10.90	m
Length d. w. l.	8.36	m
Beam, max, excl. rubbing strake	3.45	m
Draft	1.58	m ³
Displacement on d. w. l.	5.7	m ³
Engine: Perkins 4.108 M	36	kW
Sail areas:		
Main	24.0	m ²
Jib	14.0	m ²
Genoa	33.0	m ²
Mizzen (optional)	7.3	m ²

- 0 Classification
- 1 Hull
- 2 Deck
- 3 Keel
- 4 Rudder and steering
- 5 Engine
- 6 Fresh- and seawater systems
- 7 Bilge pump
- 8 Ventilation, hatches, portholes
- 9 Deck fittings
- 10 Rigging, standing and running
- 11 Sails
- 12 Accommodation
- 13 Loose equipment
- 14 Electric installation
- 15 Colours and antifouling

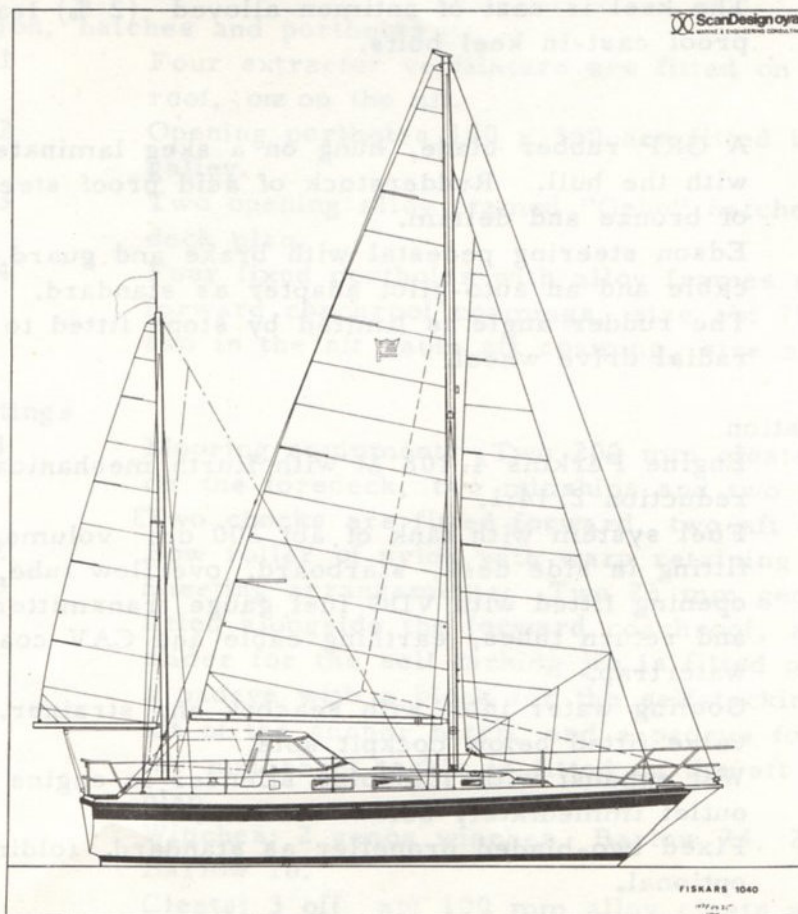

0. Classification The hull and deck is delivered with an individual Hull Moulding Release Note, issued by Lloyd's Register of Shipping.

The boat shall also comply with the Nordic rules for pleasure boats.
1. Hull
 - 1.1 Hand laminated throughout of glassfiber cloth, mats and rowings, with longitudinal stringers stiffening the hull sides and transverse floors stiffening the bottom.
 - 1.2 Special reinforcement at top shroud and main bulkhead joint, mast support, keel aft end and engine bed.
 - 1.3 Hull and deck joint in principle according to our drawing 347.013-52P3.
2. Deck
 - 2.1 Hand laminated, with partial balsa sandwich stiffening.
 - 2.2 As an option, teak can be laid on the decks as shown in the deck drawing.
3. Keel
 - 3.1 The keel is cast of antimon-alloyed (2 %) lead, with acid proof cast-in keel bolts.
4. Rudder
 - 4.1 A GRP rubber blade, hung on a skeg laminated integrally with the hull. Rudderstock of acid proof steel, bearings of bronze and delrim.
 - 4.2 Edson steering pedestal with brake and guard plate, pull cable and an auto-pilot adapter as standard.
 - 4.3 The rudder angle is limited by stops fitted to the Edson radial drive wheel.
5. Engine installation
 - 5.1 Engine Perkins 4.108 M with Hurth mechanical gear box, reduction 2.14:1.
 - 5.2 Fuel system with tank of abt 200 dm³ volume, with filler fitting in side deck, starboard, overflow tube, inspection opening fitted with VDO fuel gauge transmitter, fuel supply and return tubes, earthing cable and CAV coarse filter/watertrap.
 - 5.3 Cooling water inlet with seacock and strainer. Vacuum valve fitted below cockpit sole.
 - 5.4 Wet exhaust with standpipe silencer in engine room, and outlet immediately below transom.
 - 5.5 Fixed two-bladed propeller as standard, folding propeller optional.

- 5.6 Engine controls, single-lever Morse fitted in cockpit, Engine stop push-button in instrument panel.
- 5.7 Engine instruments comprise tachometer, oil pressure and water temperature gauges and warning lights for oil pressure, water temperature and charging.

6. Fresh and seawater systems

- 6.1 The fresh water tank of abt 150 dm³ capacity is situated between the floors in the bilge, and a second tank is fitted below the port settee in the saloon. The tanks are made of stainless steel or HD polythene. The filler fitting is in the side deck. A pressure water system with outlets in the fwd toilet, galley and aft cabin is fitted. Optional shower outlet on deck.
- 6.2 The galley is prepared for optional seawater hand pump.
- 6.3 A Raritan calorifier of 22 dm³ capacity can be fitted as an option with outlet in galley, toilet and aft cabin.

7. Bilge pump

- 7.1 The Henderson chimp bilge pump is fitted in the cockpit locker, with handle in cockpit. Discharge in hull side. The Lavac discharge pump can also be used as an additional bilge pump.

8. Ventilation, hatches and portholes

- 8.1 Four extractor ventilators are fitted on the forward coachroof, one on the aft.
- 8.2 Opening portholes 160 x 350 are fitted in the toilet and galley.
- 8.3 Two opening alloy framed "Gebo" hatches are fitted as per deck plan.
- 8.4 Four fixed portholes with alloy frames are fitted in the forward coachroof coamings, size abt 750 x 150/190, and two in the aft cabin aft coaming, size abt 650 x 180.

9. Deck fittings

- 9.1 Mooring equipment: Two 200 mm cleats are fitted forward on the foredeck, two midships and two on the aft deck. Two chocks are fitted forward, two aft as per plan.
 - 9.2 Bow roller of nylon with warp retaining pin.
 - 9.3 Sheetting arrangements: Two 25 mm genoa tracks are fitted alongside the forward coachroof, an X-track with slider for the self-tacking jib is fitted on the coachroof, a padeye with a block for the self-tacking jib is fitted right aft of the anchor hatch, and a padeye for the lower end of the mainsheet tackle is fitted on the aft coachroof as per plan.
- Winches: 2 genoa winches Barlow 24, 2 spinnaker winches Barlow 16.
- Cleats: 3 off, abt 100 mm alloy cleats are fitted on the aft coachroof.
- Two double turning blocks are fitted as per plan.
- Two winch handle holders are fitted in the cockpit, one on the mast.

- 9.4 Spinnaker boom deck fittings are optional.
- 9.5 Double lifelines are fitted, 610 mm high, with bow and aft pulpits of double tube type. Bathing steps are fitted on the transom.
- 9.6 Windscreen and hardtop are fitted and a cockpit tent delivered as per plan.
- 9.7 The engine room hatch in the cockpit sole is sealed with rubber gaskets and fitted with locks.
- 9.8 Scuppers: Two \varnothing 40 mm scuppers from the cockpit and four \varnothing 20 mm from the decks are led to two common seacocks.

10. Rig

- 10.1 The boat is delivered as a sloop as standard. An optional ketch rig can be delivered using an identical main mast as in the sloop rig.
- 10.2 The main mast is of aluminium alloy, silver anodized, with single spreaders and double lower shrouds, an inner forestay (jibstay) and backstay. Rigging screws are fitted on all shrouds and stays, with toggles on top shrouds and fore-and backstay. Mast fittings:
- Sound deadening
 - Two halliard winches Barlow 16
 - 6 alloy cleats
 - 1 main halliard
 - 1 jib halliard
 - 1 foresail halliard
 - 1 spinnaker halliard
 - 1 spinnaker boom lift (optional)
 - 1 main boom topping lift
 - 2 eyes for spinnaker booms
 - Steaming light
 - Floodlight as an option
 - Mast step with kicking strap attachment
- 10.3 Main boom of silver anodized aluminium alloy. Boom with gooseneck, mainsheet bail at outer end, kicking strap attachment, two jiffy reef blocks, reef winch and cleat, clew outhaul, topping lift bail.
- 10.4 Mizzen mast and boom as per plan; optional.
- 10.5 Standing rigging of 7 mm dia 1 x 19 stainless steel wire. Bobstay of 10 mm dia 1 x 19 wire.
- 10.6 Running rigging:
- Main halliard 5 mm dia 7 x 19 wire with 12 mm dia rope tail
 - Inner jib halliard 5 mm dia wire, with 12 mm dia rope tail
 - Outer jib halliard 5 mm dia wire with 12 mm rope tail, attached to the wire with a shackle
 - Spinnaker halliard 12 mm pre-stretched (optional)
 - Spinnaker boom lift 12 mm (optional)

Sheets: Mainsheet, jib sheet 12 mm dia, Genoa sheet 14 mm dia. Mizzen sheet 12 mm dia (optional). Topping lift for main and mizzen (optional) 6 mm dia, staysail sheet and halliard 10 mm dia (optional). Spinnaker sheets and guys, 12 mm dia (optional).

Flag halliards: eyes for flag halliards below spreaders.

White plastic shroud rollers on the top shrouds.

11. Sails

The sails are made of Dacron and Nylon to normal standards. The following sails can be delivered:

- Mainsail 300 g/m²
- Self-tacking jib 300 g/m² as standard,
- and
- Storm jib
- Furling genoa, alternatively double sail of "Unisail" type, to be used instead of spinnaker on a run,
- Spinnaker
- Mizzen
- Mizzen staysail
- Jib (on inner forestay)
- Genoa - " -

as options

Mainsail with two reefs, four battens and Cunningham. The self-tacking jib is fitted with a clew reinforcement with three clew cringles, three battens and pistol hanks.

The storm jib is fitted with a wire tack pennant and hanks.

Furling genoa luff to suit furling gear type; standard option is Rotostay with forestay profile.

12. Interior

The interior is built in varnished mahogany, with floorboards of teak faced plywood.

- 12.1 A gas stove with oven and three burners is installed in the galley on the port side, as well as an ice box, which can be fitted with refrigeration, a stainless double sink, fresh water tap and drawers and lockers as per plan.
- 12.2 The flap of the chart table to starboard lifts to reveal chart drawer below. A fixed seat and shelves are fitted as per plan.
- 12.3 Toilet with Lavac WC washbasin, hand shower, mirror and necessary clothes and towel hooks. GRP floor with teak grating over sump.
- 12.4 Mattresses forward and aft 100 mm thick.
- 12.5 Settees in saloon are 80 mm thick with 35 mm thick fiberfill on top, cloth covered.
- 12.6 Hull sides in fore and aft cabins covered with carpet, with vinyl covering in ceiling and on bulkheads. The engine room is sound insulated with an absorbant foam on top of a heavy mat.
- 12.7 Floorboards in saloon, fore cabin and aft cabin covered with carpets.

13. Loose equipment

Standard: - Flagpole
Extra: - Fenders
- Boathook
- Two genoa sheet blocks with sliders
- Two snatch blocks Lewmar
- Anchor, plow type, 12 kg with 6 m
5/16 chain

Other options are available

14. Electrics

The electrical system is 12 V DC without common ground.

14.1

A starting battery 100 Ah and a lighting battery 100 Ah are fitted in the engine room, and charged through blocking diodes.

14.2

The switch panel is fitted close to the chart table, and the main switch below the main companionway.

14.3

Certified navigation lights: steaming light (connector at mast foot), port and starboard in pulpit, stern light.

14.4

Floodlight and anchor light (connectors at mast foot)

Instrument light in cockpit

Compass lighting (separate switch)

Dome lights in aft cabin, saloon, toilet and passage to fore
Fluorescent in galley [cabin]

Chart table light

Six reading lights

Extra outlets for heater, refrigerating unit, radio, instruments
windscreen wipers and horn.

A 12 V DC outlet for floodlight or cigarette lighter in
instrument panel is provided.

15. Colours, antifouling

Standard colours are white hull with blue topside band and
blue boottopping, builder's logotype in gold tape. Off-white
deck.

Blue antifouling (optional).