

Gulf-32

SPECIFICATIONS

L.O.A. 32'
L.W.L. 25'
BEAM 10'
DRAFT 5'2"

Displacement Sailaway:

Approx. 15,000 lbs.
Hull Fiberglass
Spars Aluminum
Sail Area w/stysl ... 555 sq. ft.
J 12'2½"
I 39'
P 33'
E 13'1"

Some items shown are optional.

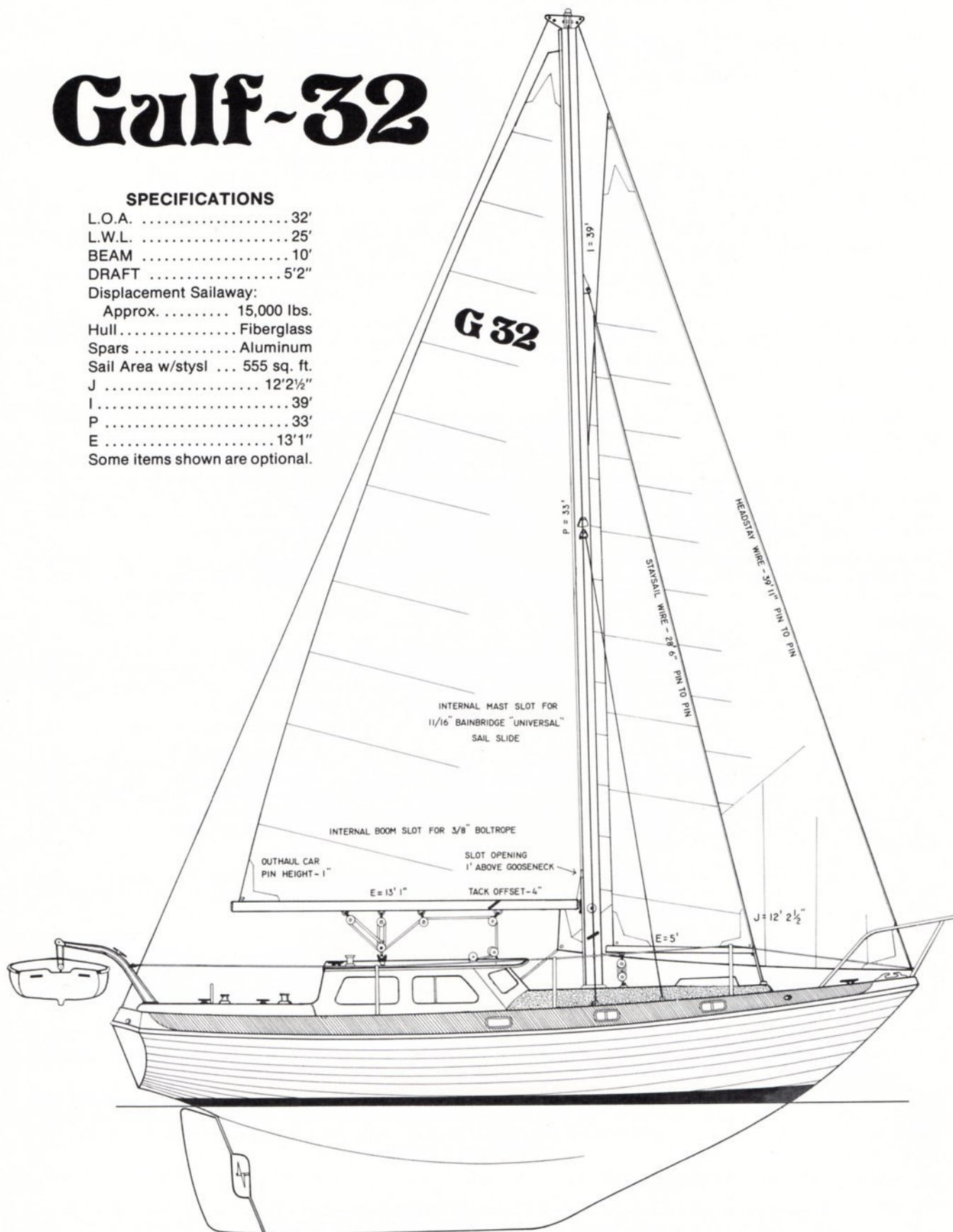

GULF-32 THE CLASSIC CRUISER

SPECIFICATIONS AND STANDARD EQUIPMENT

- 3 or 4-CYLINDER DIESEL
- WHEEL STEERING W/PEDESTAL CONTROLS
- BOW PULPIT W/MID RAIL & STERN PULPIT
- DOUBLE LIFELINES W/GATES
- FOUR PORTS
- MANUAL BILGE PUMP
- TEAK COAMING TOPS IN COCKPIT
- TEAK HANDRAILS ON PILOT HOUSE TOP
- CENTER MAINSHEET W/ROLLER BEARING SLIDE CAR
- 5 WINCHES - 3 SINGLE SPEED, 2 - TWO SPEED
- 3-BURNER STOVE W/OVEN (ALCOHOL)
- MANUAL SHOWER W/FOOT PUMP
- TEAK AND HOLLY CABIN SOLE
- DOUBLE SINK IN GALLEY
- FOOT PUMPS IN GALLEY AND HEAD
- 12V ELECTRICAL SYSTEM, CABIN & RUNNING LIGHTS
- SLEEPS 6, 2 DOUBLES, 2 SINGLES
- OWNER'S MANUAL AND SAFETY TOOL BOX
- 4" FABRIC CUSHIONS, CHOICE OF COLOR

DESIGN and CONSTRUCTION:

The Gulf-32 is a proven offshore cruising design with strong windward sailing characteristics. It has a pilot house deck which creates a light and airy cabin interior and allows the option of inside wheel steering.

The Gulf-32 has a full length keel with attached rudder for good tracking ability. The ballast is completely enclosed in the keel. The hull and deck are hand laid-up from the highest quality fiberglass and gel coat materials available. The deck is reinforced with core sections and plywood. The rudder is a one piece glass covered, high density polyurethane foam rudder with a stainless steel shaft.

DECK LAYOUT:

The pilot house has windows on all four sides providing 360° visibility when steering inside the pilot house. The roomy cockpit has three access seat hatches and full length teak coaming tops. The cockpit pedestal steering unit has engine controls and a space for an optional compass. There is an engine instrument panel in the cockpit. An emergency tiller is provided which fits the tillerhead behind the pedestal.

The roof of the pilot house extends out over the forward windows to shield off sun and spray. Two of the windows on the side of the pilot house and four of the six ports in the side of the deck slide open for ventilation. The companionway hatch slides on tracks. Two solid teak handrails are fastened to the top of the pilot house. The forward sliding hatch has a teak frame and translucent lucite top to allow extra light into the forward cabin. The foredeck is recessed for topside anchor and sailbag storage and has scuppers for drainage.

An optional stainless bow sprit with two anchor rollers extends out over the bow for easy anchoring. There is a pair of mooring chocks and cleats at the bow and stern of the boat. Optional stern mounted dinghy davits are available. An optional 8' fiberglass dinghy with flotation molded in and lifting eyes is also available to complement this cruiser.

RIGGING:

The standard Gulf-32 is rigged as a sloop with an optional club footed staysail for a cutter rig if desired. The mast, booms and airfoil spreaders are all heat treated aluminum. The main boom has a fixed gooseneck and a masthead boom lift. The standing rigging and chainplates are stainless steel. The mainsail is controlled with a mid-boom traveler bar with an adjustable slide car allowing easier sail trim adjustments. The jib or genoa is sheeted to snatch blocks riding on several feet of black anodized genoa track mounted on deck.

INTERIOR LAYOUT:

The Gulf-32 is designed to provide maximum comfort below decks in all weather conditions. The interior is divided into three areas. The first one from the cockpit is the pilot house. The starboard side of the pilot house has a sit-down chart table and shelves for the navigator. Behind the chart table is a large quarter berth. The optional inside steering station is located amidships alongside the chart table with its own set of engine controls, and compass. A station exchanger allows steering from either steering station with the other station disengaged. From the inside steering station, the helmsman has 360° visibility and complete control of the boat when under power while remaining protected from the elements.

The large galley is on the port side of the pilot house. Double stainless sinks with foot pumps drain to a thru-hull with an anti-corrosive gate valve. The large ice box has a teak grate and access lid and an ice fill from the port cockpit hatch. The ice box drain is connected to a manual bilge pump for direct overboard discharge. The three burner alcohol stove with oven is gimballed. A trash receptacle is built into the countertop. There are shelves, dish lockers and drawers throughout the galley area.

Forward and two steps down from the pilot house is the main cabin which has a full length settee berth on the port side and an L-shaped dinette which converts to a double berth on the starboard side. The dinette table stores out of the way against the bulkhead and folds down and out for easy serving. There are shelves and lockers above the berths and ample storage under the berths. An optional bulkhead mounted fireplace may be installed in the main cabin.

Forward of the main cabin on the starboard side is a large head compartment with grate floor, laundry hamper, shelves and lockers. There is a stainless sink and standard cold water shower operated by a foot pump. An ecology head system for your area is optional. Opposite the head compartment is a hanging locker, an oilskin locker for wet clothing and a series of large storage bins.

The forward cabin has over a 6 foot double berth to the starboard side with shelves surrounding it. To the port side is a large shelf with drawer units under it. A vanity seat for dressing doubles as a step to the forward bunk and has storage under it. There are a pair of overhead lockers with doors at the forward end of the cabin. Hinged doors provide access to the chainlocker. The hull sides are planked with teak and the cabin sole is teak and holly. The owner selects the pattern and color of the standard 4" fabric cushions.

MECHANICAL AND ELECTRICAL EQUIPMENT:

The Gulf-32 is powered by a three or four cylinder diesel engine. The two blade propeller is driven by a 1 1/8" shaft with a zinc collar. The engine is custom aligned with adjustable rubber mounts. There is top and side engine access for easy maintenance. Ventilation system.

Electricity is supplied by a 12 volt engine generator to one 12 volt battery in a support box. The master control panel has spare switch blanks and easy access. There is also a master safety shut-off switch. 12 volt lights are mounted throughout the interior and the running lights include a bow light on the mast. The 70 gallon water tank has a deck fill and shut-off valve. One aluminum baffled fuel tank holds 70 gallons.

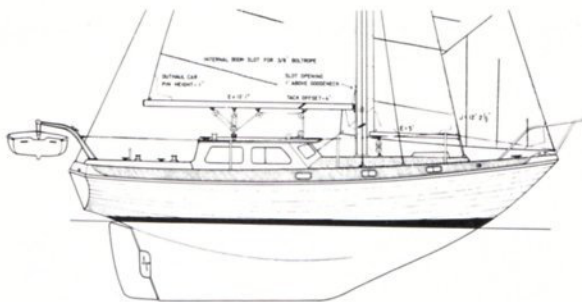

CAPITAL YACHTS, INC.
 NEWPORT • NEPTUNE • GULF
 25914 PRESIDENT AVENUE
 HARBOR CITY, CALIF. 90710
 (213) 530-1311

GULF 32 SUGGESTED PRICE LIST and ORDER FORM

HULL _____ DECK _____

TWO TONE _____ BOOT TOP _____ COVE STRIPE _____

BASE BOAT

_____ 1	Battery, Extra w/Box and Separate Shut-Off Switch	145.00	_____ 22	Exterior Cabin Color other than white	95.00
_____ 2	Bilge Pump - Electric	150.00	_____ 23	COLOR	
_____ 3	Boom Vang	195.00	_____ 24	Maststep Collar Plate	50.00
_____ 4	Bottom Paint: RED _____ BLUE _____	300.00	_____ 25	Masthead Light	95.00
_____ 5	Bow Sprit, Stainless with Anchor Rollers	225.00	_____ 26	Pressure Water (Cold)	250.00
_____ 6	Center Hatch-Pilot House Top	295.00	_____ 27	SAILS:	
_____ 7	Club-Footed Staysail Package, less sail ...	585.00	_____ 28	Main w/2 Rows of Reef Points, 7 oz.	850.00
_____ 8	Coaming Compartments	110.00	_____ 29	Heavy 150% Genoa w/Reef Points 5.5 oz. ...	850.00
_____ 9	Cockpit Cushions - 3"	195.00	_____ 30	Heavy 130% Genoa, 6 oz.	725.00
	COLOR		_____ 31	Staysail, Club-Footed, 4 oz.	475.00
_____ 10	Cradle	600.00	_____ 32	Sail Cover - Color	
_____ 11	Curtains (Pilot House Sides Only)	250.00		MAIN	125.00
	COLOR			STAYSAIL	110.00
	Cushions - 4" Fabric with Vinyl Bolster	Std.	_____ 33	Saltwater Pump in Galley w/Foot Pump ...	150.00
	COLOR		_____ 34	Shorepower System	300.00
_____ 12	Pillow Style (Main Cabin Only) Exchange .	295.00	_____ 35	Spinnaker Gear Complete (Less Winches) .	895.00
	COLOR		_____ 36	Spinnaker Gear - Partial: Track & Car on Mast, Top Lift Bail & Spin Bail	175.00
_____ 13	Davits w/Block & Tackle (exchange)	595.00	_____ 37	Spreader Combo Deck Light	85.00
_____ 14	Dinghy for Davits (Color to Match)	575.00	_____ 38	Transom Ladder, Stainless	125.00
_____ 15	Fireplace, Charcoal Type w/Stack and Deck Vent	495.00	_____ 39	Two Tone Deck	200.00
_____ 16	Front Opening Windshields (exchange) ...	295.00		Vents - 6" Cowl, Dorade Type Each	150.00
_____ 17	Head, Marine w/Holding Tank	450.00		Water Box (Depth Sounder)	75.00
_____ 18	Hot Water System w/Shower Mixer in Head	995.00			
_____ 19	Hull Color (Other than White)	400.00			
_____ 20	Inside Steering w/Station Exchanger, Inside Engine Controls, Ignition Panel and Instruments	1,995.00			
_____ 21	Knotmeter	235.00			

Freight & Commissioning

● FOR SPECIAL OPTIONS SUCH AS ADDITIONAL INTERIOR APPOINTMENTS ETC., CONSULT FACTORY.

SPECIAL INSTRUCTIONS: _____

DEALER _____ ADDRESS _____

DEPOSIT \$ _____ DATE _____ HULL # _____

CUSTOMER _____ ADDRESS _____

SALESMAN _____ DEALER SIGNATURE _____

DELIVERY DATE _____

ALL PRICES F.O.B. HARBOR CITY, CALIFORNIA

CAPITAL YACHTS has a policy of continuous improvements on its products and reserves the right to change materials, specifications and prices without notice after receipt of customers order, until final delivery to the customer. F.O.B. CALIFORNIA.

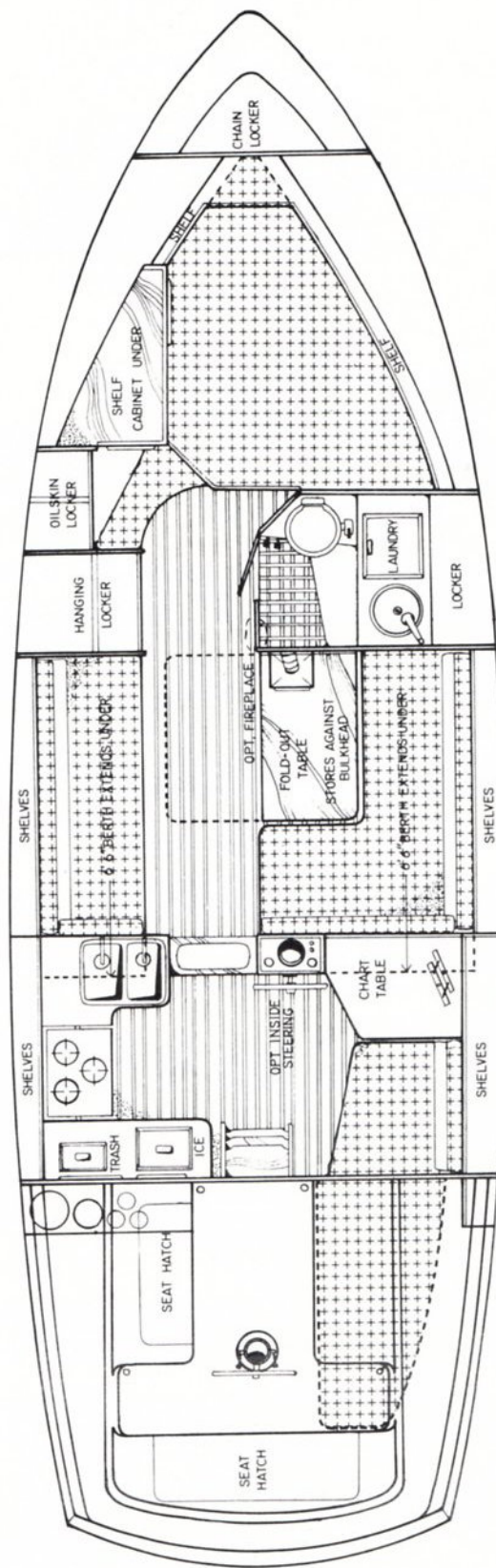
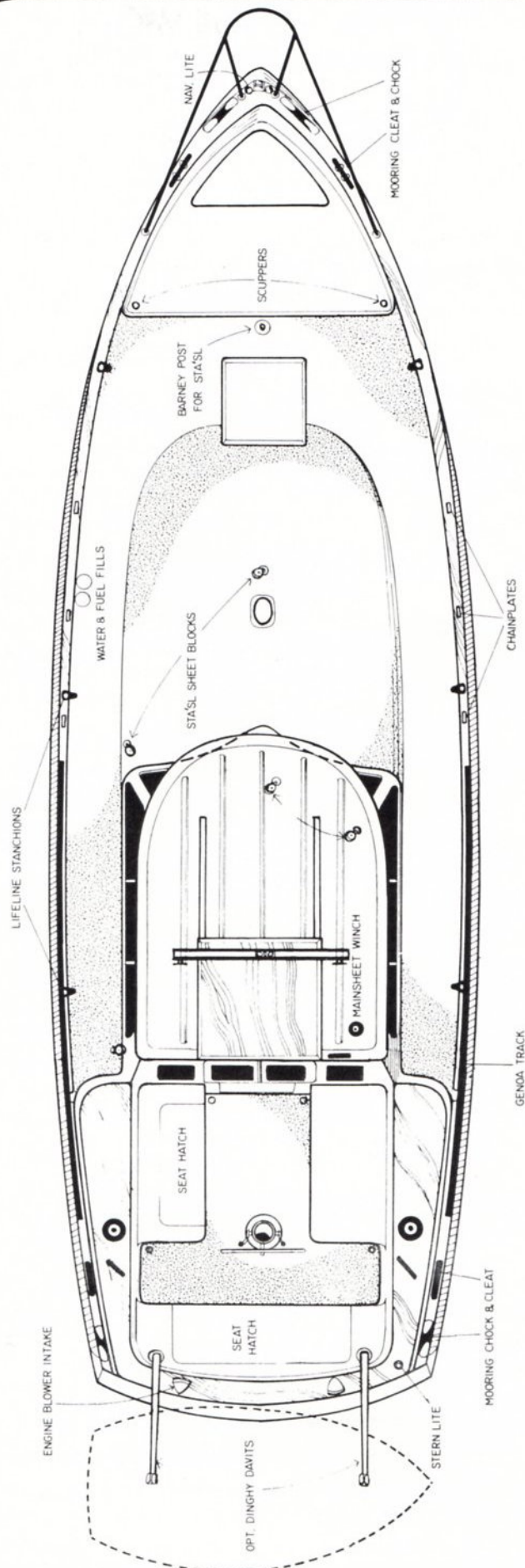

Some items shown are optional.