



HMS EIGHTEEN



THE MAKERS OF THE WEST WIGHT POTTER NOW BRING YOU A NEW EIGHTEEN FOOTER WHICH HAS ALL THE QUALITY AND SAFETY OF THE POTTER — FOUR LARGE BUNKS, AN AMAZING AMOUNT OF ROOM . . . PLUS A SPEED COMPARABLE WITH MANY LARGER BOATS.

a fantastic **18** feet

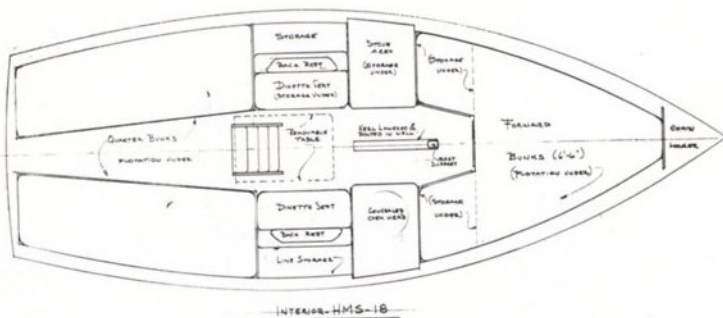

Specifications:

L.O.A.:	18'-3"
L.W.L.:	16'-0"
BEAM:	7'-6"
DRAFT:	12"
DRAFT KEEL DOWN:	3'-11"
KEEL WEIGHT:	410 lbs.
WEIGHT:	1400 lbs.
SAIL AREA: (Main)	83'
SAIL AREA: (Jib)	32'
SAIL AREA: (Lapper)	67'
SAIL AREA (Genoa)	98'
MAST ABOVE DECK:	22'-0"



DESIGNED BY
Herb Stewart

CONSTRUCTION

Hull, deck, cabin, and cockpit are quality built of no-maintenance molded fiberglass with locked-in choice colors and non-skid surfaces. Limited exterior wood surfaces are the finest teak. Fittings are of stainless steel and nylon or aluminum; sails of dacron. All rigging is stainless steel.

LAUNCH OR TRAIL

The HMS-18 is easily trailed by the smallest car, yet once afloat, you have a yacht that can be lived on most comfortably over weekends and those summer vacations. She also fits a standard garage. Keel is fully flush with bottom of hull when in trail position. A small removable winch that mounts forward of the hatch on deck raises and lowers keel as required.

NEW STANDARDS OF SPEED & QUALITY

Like the Potter, the HMS-18 is the most stable boat anywhere near her size. High free board makes her a dry sailer. Long clean underwater lines and light displacement make her very fast. She sails on her bottom which means very little heel — the answer needed to convince the wife that this is the only boat to own.

COMFORT PLUS

The most comfortable cockpit afloat. She has wide bench seats — chair height. Wide flat coaming to rest your arms on. Sloped cabin back so that guests can lean back in solid comfort. No bumping of knees in this spacious six-seater cockpit. Self-bailer is at rear which keeps your cabin dry. No more stepping from a wet cockpit into a dry cabin.

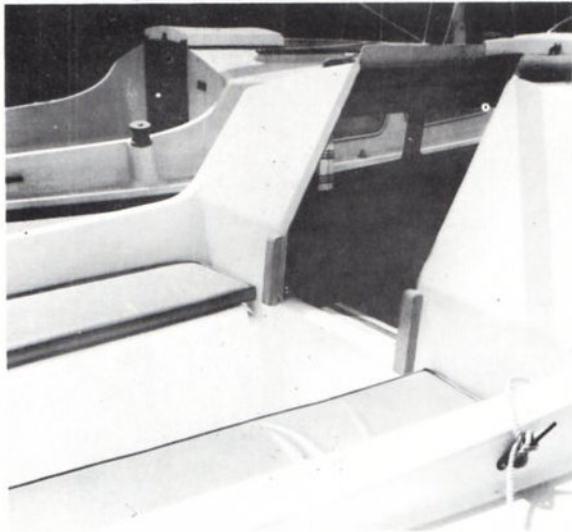

FOUR BIG BUNKS

The lovely, roomy interior has four 6'6" bunks, — mahogany cabinets — one for storage of cooking equipment and food and the other to conceal the marine toilet. There are two dinette seats with comfortable seat backs which allow space for four at the removable mahogany dining table. All cushions are 3" high density foam. You and yours can sleep comfortably in this boat — none of the back-breaking routine that is found in most boats up to 21'. Even the largest adult can roll over in our quarter berths. The HMS-18 has as large an interior as can be found in any boat up to 21' in length — with 5' head room.

— a beautiful **SHIP**



**A HOUSE TRAILER ON LAND — A
YACHT AT SEA — BEST OF BOTH WORLDS**

HMS-18

*(A Boat That You'd Design
For Yourself)*



QUALITY FEATURES ARE STANDARD EQUIPMENT

- FIBERGLASS** — Permanent, maintenance free construction. Molded-in non-skid surfaces.
- TRIM** — Choice teak outside trim.
- SAILS** — Top quality dacron. Dacron sheets, stainless steel rigging.
- FITTINGS** — All required deck, spar and boom fittings for working sails of stainless steel, aluminum or bronze as need, mast and boom of aluminum.

EXTRA OPTIONAL EQUIPMENT: 1. Set of 2 Vinyl covered poly-foam, cockpit cushions. 2. Set of four vinyl 4" foam bunk pads. 3. Genoa. 4. Lapper, Working Jib. 5. Whisker Pole. 6. Outboard Bracket. 7. Cockpit tent. 8. Curtains. 9. Bow rail. 10. Life lines.

FACTORY WARRANTY

All fiberglass parts are guaranteed against defects in workmanship for a period of 1 year from the date of shipment. This company will replace any part at its' option, FOB factory, such parts of our manufacture found upon factory inspection to be defective in material or workmanship. Such material, found defective, must be returned to the factory within 10 days from the date of claim. Ordinary use, wear, neglect or misuse are not covered by this warranty. We reserve the right to make changes and/or improvements upon our products without imposing any obligation upon ourselves to install the same upon our products theretofore manufactured.

Produced and sold in the U.S.A.

By:



MARINE, INC.,

904 W. HYDE PARK BLVD. - INGLEWOOD, CALIF. 90302 - PHONE: (213) 674-4540