

Manufacturer's comment:

The most different Irwin yet. Designed to drink 6 and sleep 4 and named "10/4" because of its 10'-4" beam.

The concept for the Irwin 10/4 was to design a 25 foot family cruiser that is easy to handle, functional for convenience, roomy enough to sleep no more than four and equipped as complete as possible.

One person can easily handle the Irwin 10/4 because there's an inboard engine, pedestal steering with engine controls at your fingertips, plus, working bow sprit with anchor roller chock plus all sheets, halyards and topping lifts are led aft to the cockpit.

The 10/4 is particularly adaptable to a wider variety of cruising waters because the keel/centerboard only draws 2'-9".

A full 5'10" headroom and 10'4" beam below deck certainly contributes to the unbelievable room a 25 footer offers. You further have 4 permanent berths along with an enclosed head compartment, the door of which also closes off the forward double berth from the rest of the main salon.

The galley is to starboard and adjacent to the companion-

way. Its abundant counter space and stowage area allow you to prepare full meals instead of one sandwich at a time. The icebox to port not only is conveniently accessible from the cockpit but also from below deck.

Stowage aboard the 10/4 is abundant and consists of a lazarette, not normally found on 25 footers, port & starboard sail lockers in the cockpit plus generous outboard lockers and shelves below.

The sail inventory consists of a mainsail (and cover) with reef points and a No. 2 genoa. Sail handling equipment includes two genoa sheet winches, mainsheet traveler, and all necessary sheets.

Not only does the new Irwin 10/4 offer a full page of standard equipment, it is also Package Priced that includes free delivery to any point in the Continental U.S.

New designs come and go but the Irwin 10/4 is a boat that will last for years.

IRWIN YACHT & MARINE CORPORATION
13055 49th Street North
St. Petersburg, Florida 33732
(813) 527-6471

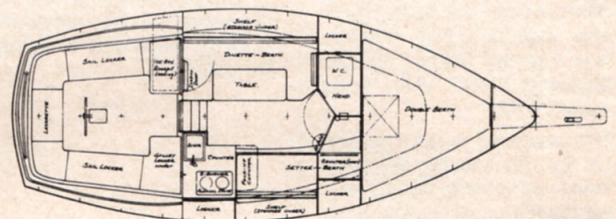
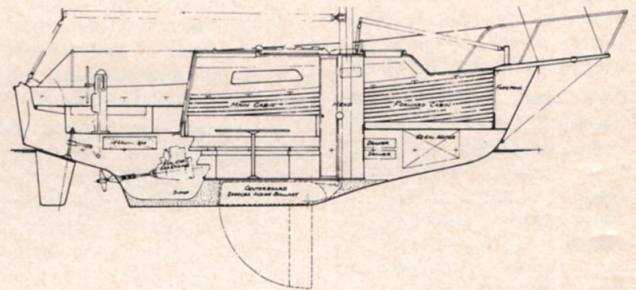

L.O.A. 25'4"
L.W.L. 21'10"
Beam 10'4"
Draft 2'9" to 6'8"
Sail Area: Main 185 sq. ft.
Rated Sail Area 395 sq. ft.
Hull Fiberglass
Spars Aluminum
Ballast 2,000 lbs.

Displacement 7,000 lbs.
Headroom (Main Cabin) 5'10"
Berths 4
Auxiliary
Gas 2 cylinder
Designer Ted Irwin
Price with main & #2 Genoa
\$14,950 (Package Priced)