

New for 1988, the J/34c cruising one-design is scheduled for her debut at the Annapolis Boat Show in October 1987.

The J/34c is an entirely new design created for the cruising sailor. (There is no relationship with the earlier J/34 IOR Three-Quarter-Ton race boat).

J/34cs are all equipped standard with Rod Johnstone's UFO (Underwater Flying Object) shoal draft lead keel, successfully tested on the J/37. The UFO keel is part bulb and part wing in design, with more mass and strength than a conventional fin keel to prevent damage in groundings. It is shaped to prevent snaring pots and weeds and provides exceptional upwind stability due to a low center of gravity—without sacrificing speed off the wind.

While cruising sailors are not generally motivated by organized racing, they are not adverse to competing in terms of "seamanship." It goes on all the time: docking, tacking up a narrow channel, playing the winds and currents. To have a responsive, fast, shoal-draft cruising boat with single-handed ease of operation is going to make the owner look very accomplished, indeed!

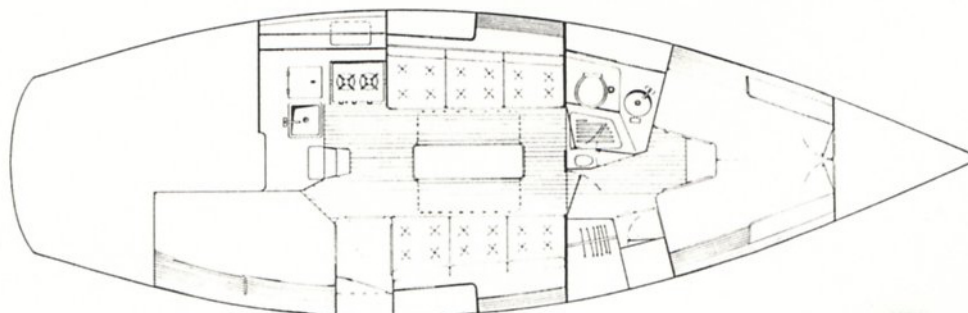
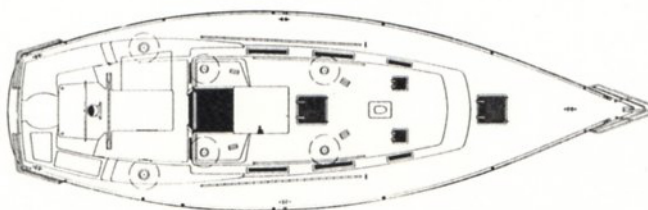
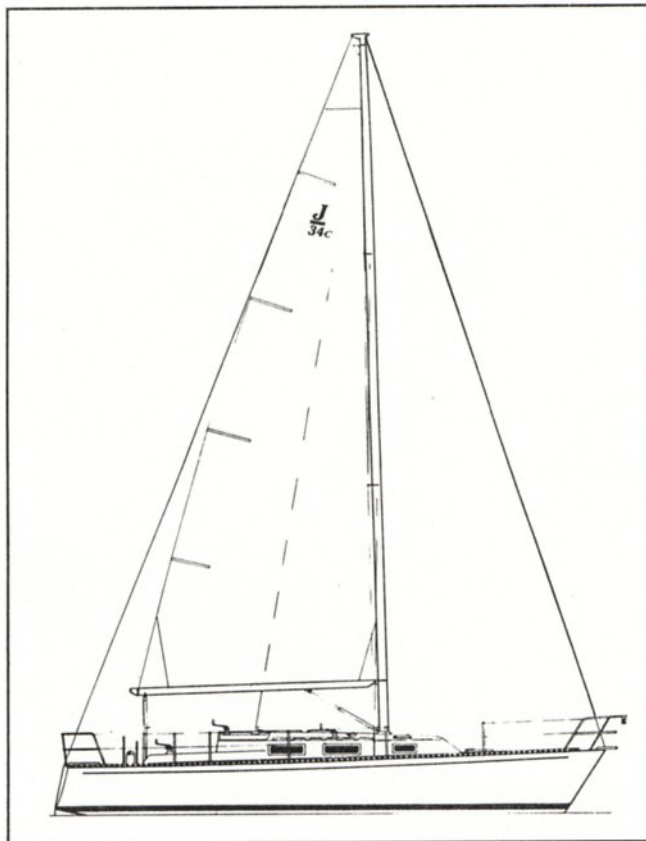

J/34c takes the next step, too! By strictly controlling the building specifications and weights and by using a structural Baltek sandwich laminate for hull-form rigidity, the sailing characteristics of each J/34c are identical. To insure that, whether cruising in company or during a class rendezvous, all boats have an equal chance of arriving in port at the same time.

The cockpit layout follows the innovative J/40 program with a 40" Edson destroyer wheel, 5" binnacle compass and guard, mainsheet system with dual self-tailing winch controls, and instrument pods for multifunction remotes within easy reach for the helmsman.

The interior features a J/40 style forward owner's stateroom, a dual access head, spacious main cabin, center drop-leaf table, slide-out double berth to port, sit-down navigation station, and a large quarterberth. Finish below is teak with cold-molded trim. See the J/40 interior for styling.

J/34c is covered by a 10-year guarantee on blister resistance.

L.O.A.	34' 5"
L.W.L.	30' 0"
Beam	11' 1"
Draft	4' 11"
Ballast	4,500 lbs.
Displacement	10,000 lbs.
Rig Dimensions	
Foretriangle:	
I (Height)	45' 8"
J (Base)	13' 6"
Main:	
P (Luff)	40' 6"
E (Foot)	15' 0"
No. of Berths	6
Auxiliary	28 H.P. Volvo
Designer	Rodney S. Johnstone
Year Introduced	1988

J

34c

J Boats, Inc.
Box 90, 24 Mill Street
Newport, RI 02840
(401) 846-8410

For More Information Circle No. 265