

**1984 LANCER 40**  
**MID COCKPIT CRUISING YACHT**



## **1984 LANCER 40 MID COCKPIT CRUISING YACHT**

The Lancer 40 Mid Cockpit Cruising Yacht is a development of the highly successful, Herb David designed, Lancer 40 which has proven herself to be a fast, seaworthy and comfortable vessel.

This unique hull form offers outstanding performance under sail, when compared to other cruising types. The Lancer 40's long water line length, high sail area to displacement ratio, modern N.A.C.A. shaped keel, and a high stability factor (1220 lbs. of righting moment at 1° angle of keel) contribute greatly to her all around sailing performance. Speeds under power with a single diesel engine, will be in the 7 to 8 knot range, up to about 10% faster than other cruising yachts about this size.

Sail handling has been simplified to the point where you can handle all halyards, reef lines for both reefs, boom vang, boom topping lift, and main sheet from the cockpit, using custom designed line stoppers and two standard Lewmar #30 self-tailing winches. You'll never again have to leave the safety of the cockpit to reef the mainsail.

The cockpit is quite roomy and includes a pedestal steerer with engine controls, a 5" compass with binnacle and pedestal guard and a teak fold-up cockpit table.

The interior accommodation plan is also quite unique for a sailing yacht of this size - a very large guest cabin is located forward. The cabin takes up the full width of the yacht and includes a queen size berth, 2 hanging lockers and four drawers.

The main salon includes two transom berths that convert to two doubles, a hanging locker, a folding teak table, 2 bookcase alcoves with hull ports - so that you can see out when seated in the salon and a teak and holley sole.

The owner's cabin is located aft and takes up the full width of the yacht. This cabin has a queen size berth, 2 hanging lockers, four cedar lined drawers and is adjacent to a head compartment with a separate shower stall.

The galley is a delight. Over 25 square feet of counter space provide the room to prepare meals for a large crew for an extended voyage. An electric refrigerator unit with freezer compartment is standard as is a propane stainless steel gimballed stove with oven, hot and cold pressure water and a deep double stainless steel sink.

All in all, the Lancer 40 Mid Cockpit should be an outstanding cruising yacht both under power and sail. Her fast, seaworthy hull and the ability to power in the 7 to 8 knot area encompasses performance parameters that few, if any cruising yachts can match.



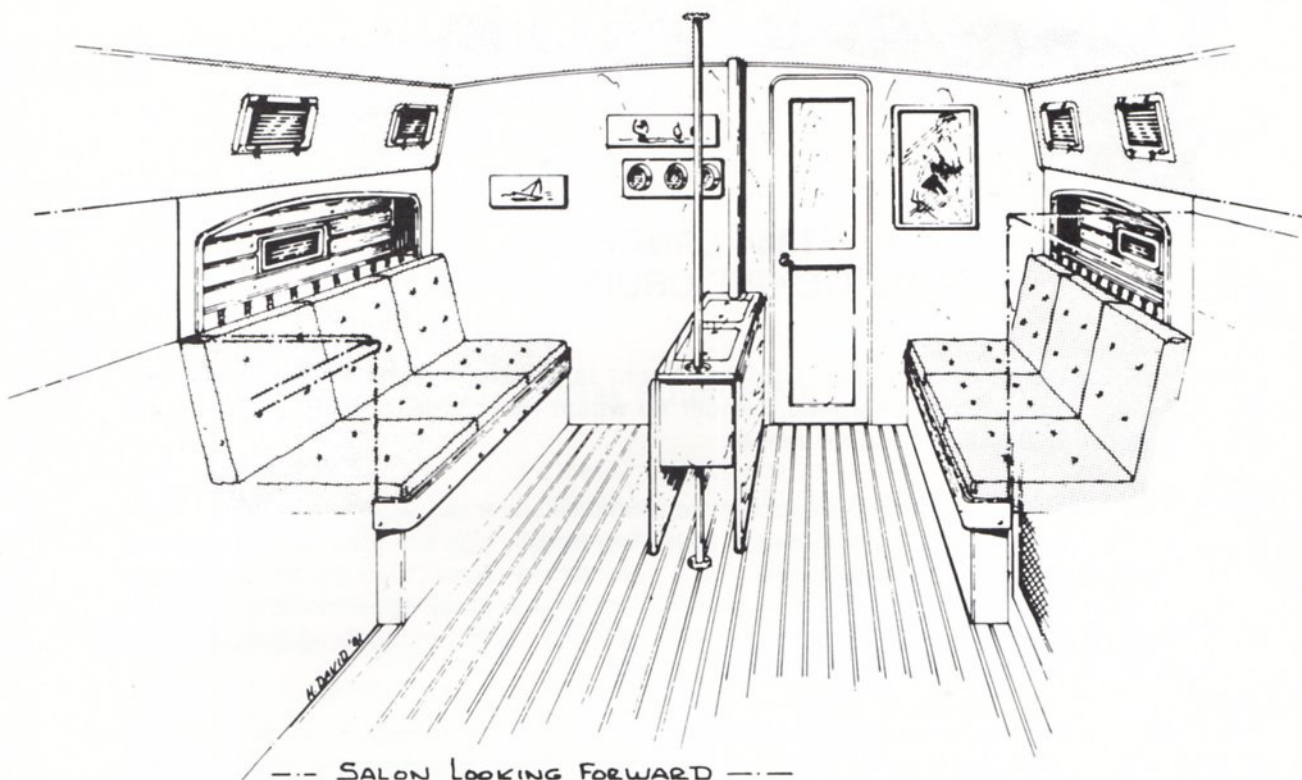

--- SALON LOOKING FORWARD ---

INTERIOR

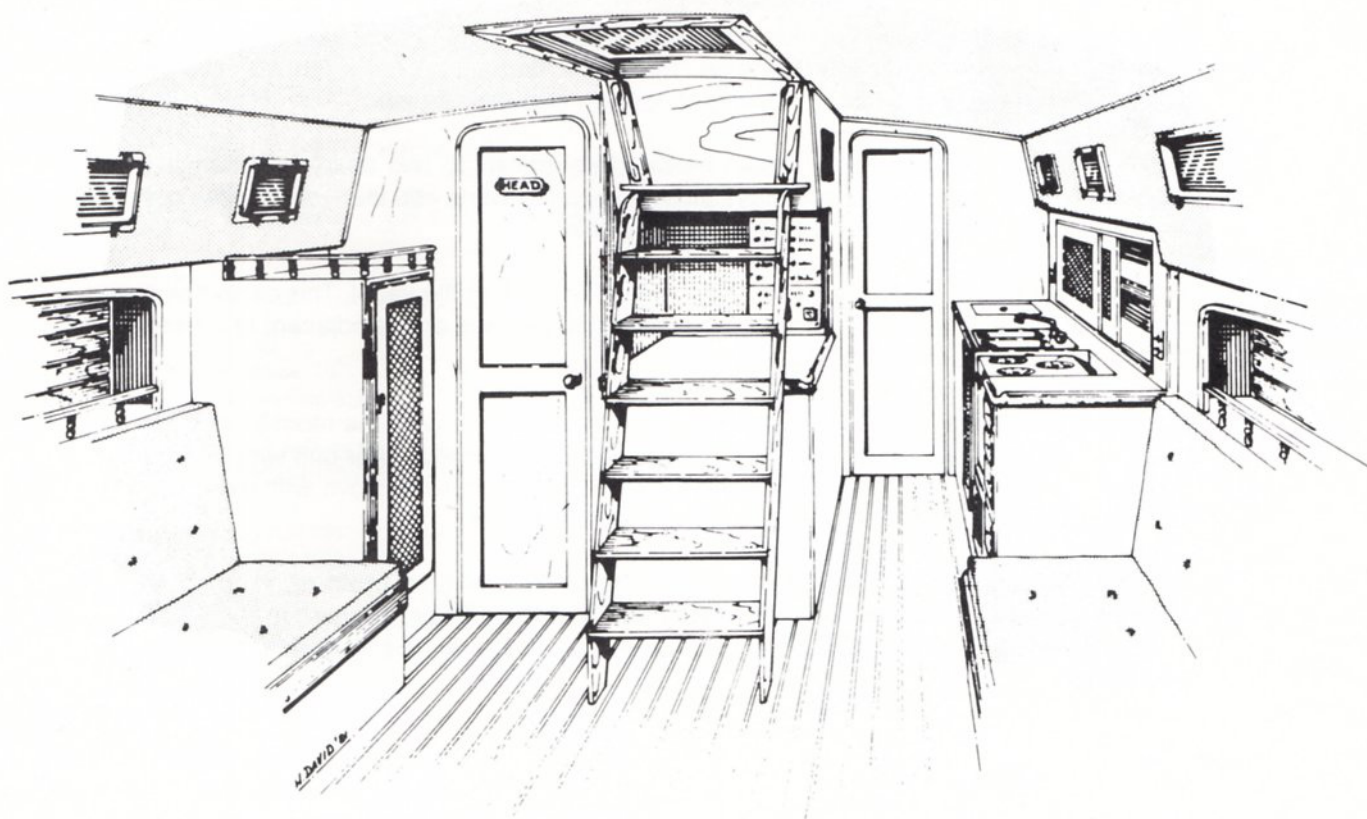

--- SALON LOOKING AFT ---

INTERIOR

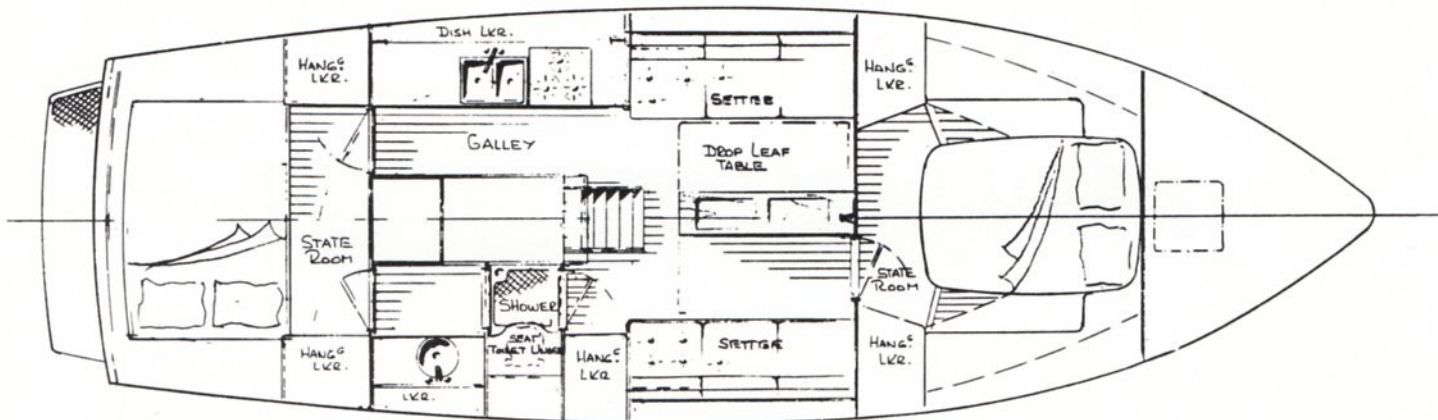
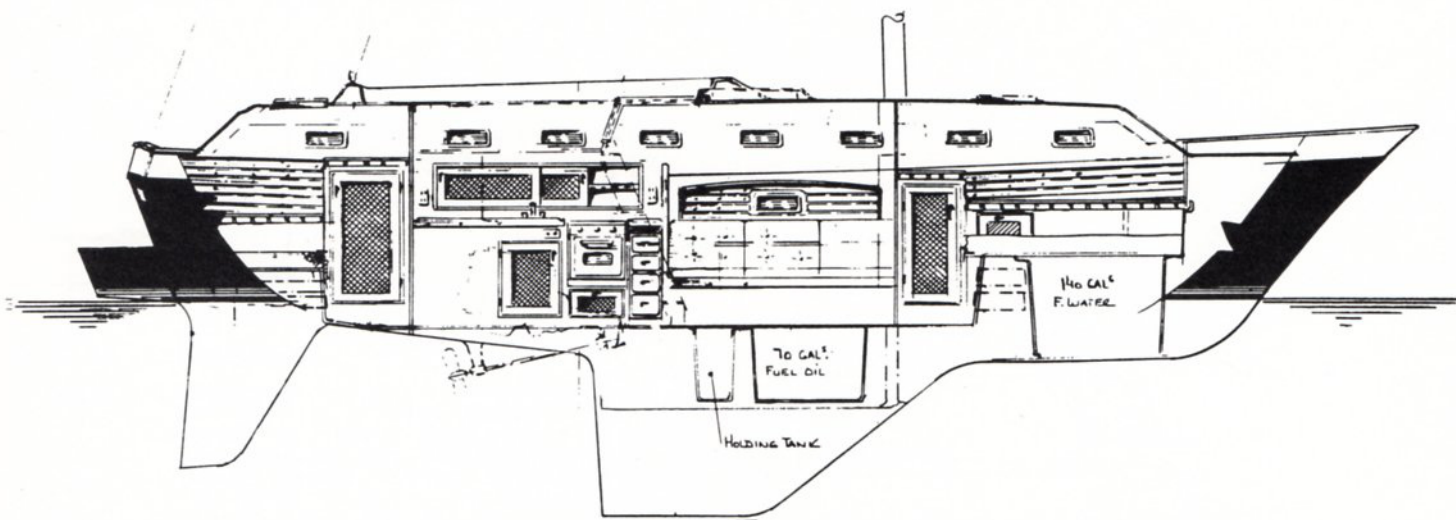
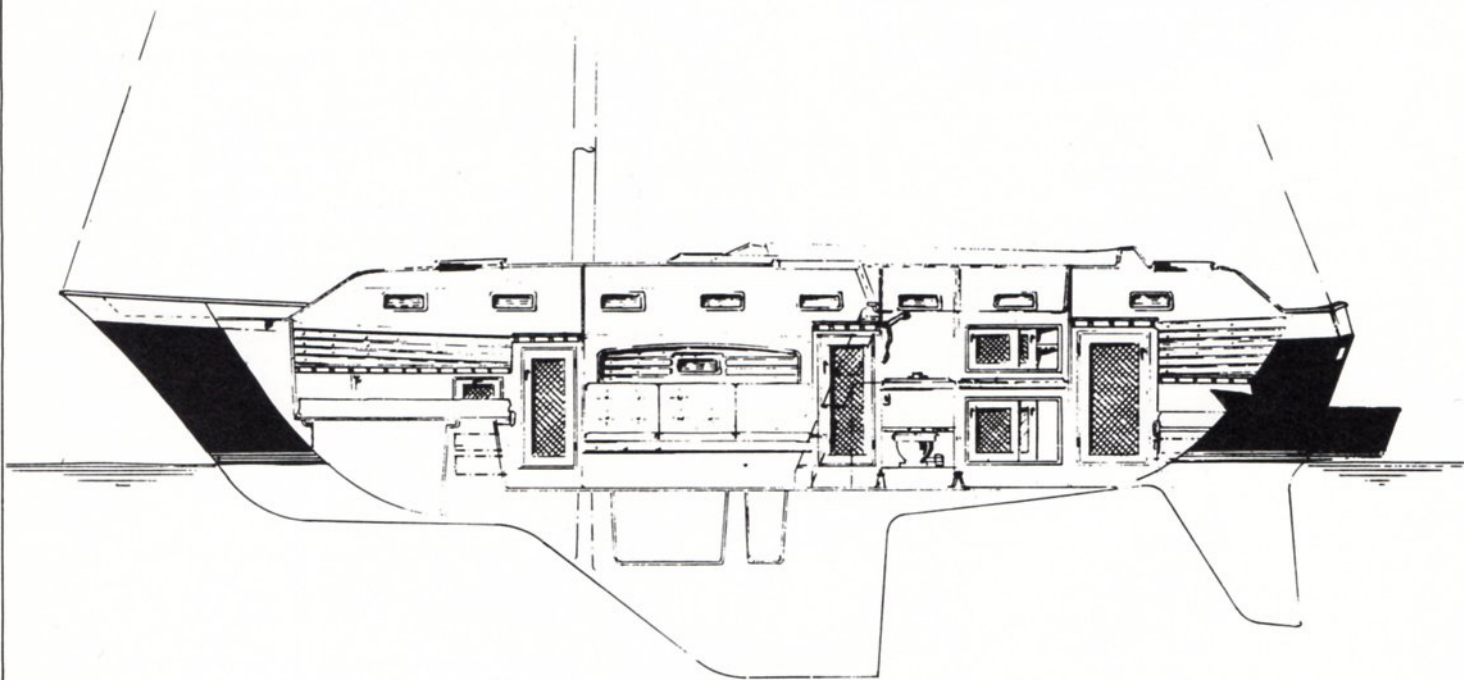





## 1984 LANCER 40 MID COCKPIT CRUISING YACHT

### STANDARD EQUIPMENT

### \$114,345.00

#### HULL

- Fiberglass with Hand Laminated Woven Roving - Full Balsa Core Sandwich Construction.
- Standard Colors - White Hull - Red, White & Blue Boot Top - Blue Sheer Stripe.

#### KEEL

- 4000 Lbs. of Internal Ballast Bonded Securely in Place.

#### RUDDER

- Schedule 80 S/S Rudder Shaft with Integral Steel Backbone - Surrounded with High Density Foam - Fiberglass Covered.

#### DECK

- One Piece Fiberglass - Plywood and Balsa Core Reinforced.
- Molded Non-Skid Surfaces.
- Large Self-Draining Cockpit.
- Sliding "Skylight Type" Main Hatch with Seahood.
- Locking Forward Cabin & Aft Cabin "Skylight Type" Aluminum Frame Hatches.
- Bow Roller for Anchor & Mooring Bit.
- Foredeck Self-Draining Anchor & Storage Locker.

#### STANDING AND RUNNING RIGGING

- Aluminum Boom & Mast with Air Foil Spreaders.
- Internal "Gib Hook Type" Tangs for Standing Rigging.
- Stainless Steel Chain Plates and Stem Fitting.
- S/S 1 x 19 Wire with Swedged Fittings Standing Rigging.
- Prestretched Dacron Running Rigging with Spliced on Fittings.
- Internal Main & Jib Halyards.
- Ball Bearing Main Sheet Traveler.
- Split Back Stay.
- Baked White Polyester Coating on Mast & Boom.
- A "Super Boom" with an Internal Outhaul and an Internal Reefing System for Two Sets of Reef Points.
- S/S Boom Vang Bails on Boom & Base of Mast & Boom Vang Tackle.
- All Halyards, Main Sheet, Boom Vang, Reefing Lines for Both Reefs, and Main Boom Topping Lift are Lead Aft to 2 Custom 5 Gang Line Stoppers and 2 Self-Tailing #30 Lewmar Winches with Handle.

#### ELECTRICAL

- 4-12 Volt Marine Batteries with Perko Selector Switch to Isolate Batteries into 2 Banks.
- Interior Lighting (12 Volt).
- Electric Marine Head & Holding Tank with an Electric Off Shore Pump Out System.
- 110 Volt Electrical System - Includes 10 Duplex Outlets, 20 AMP Battery Charger, Marine Deck Connector and Circuit Breaker.
- One Electric Bilge Pump with Automatic Feature.
- International Navigation Lights.
- Engine Room Lights.
- Hot and Cold Pressure Water System.

#### ENGINE

- Volvo Penta MD-11C/110S 2 Cylinder, 4 Stroke Marine Diesel Engine With Direct Injection and Sailboat Drive #110S, Shaft Output 23 H.P. - With Folding Propeller

#### TANKAGE

- One 70 Gallon Fuel Tank (Below Water Line).
- One 140 Gallon Water Tank.

#### INTERIOR

- Forward Cabin - Queen Size Double Berth with 5" Cushion,

- 2 Hanging Lockers with Cane Doors, 4 Cedar Lined Drawers, Teak Ceilings (Hull Covering) Teak & Holley Sole; 2 Bookcase Alcoves, 4 Opening Ports with Screens, "Sky Light" Ventilating Hatch, Full Length Mirror.
- Head Compartment - Opening Port with Screen, Vanity with Mirror, S/S Sink & Drawers, Separate Stall Shower Compartment with Hot & Cold Water - Shower Drain Pump and Seat.
- Galley-S/S Gimballed Stove with Oven - Propane System with 2 Aluminum Tanks and Solenoid Safety Shut Off System, Deep Double S/S Sink, Pressure Hot & Cold Water, Opening Ports with Screens, Sliding Storage Lockers, Drawers, Teak & Holley Sole, top Load 5 Cubic Foot Ice Box with Electric Drain Pump & Norcold 110 & 112 Volt Refrigerator with Freezer Compartment.
- Main Salon - 2 Berths that Convert into Doubles, 2 Bookcase Alcoves with Hull Ports, Hanging Locker, Plush 5" Color Coordinated Cabin Cushions, Upholstered Back Rests with Storage Lockers Behind, Teak & Holley Sole Solid Teak Table Measuring about 4' x 5' with Leaves Up.
- Owner's Cabin - Queen Size Double Berth with 5" Cushion, 2 Hanging Lockers with Cane Doors, 4 Cedar Lined Drawers, Teak & Holley Sole, 4 Opening Ports with Screens and a "Skylight" Ventilating Hatch & 2 Transom Ports.
- General - All Teak Interior, Beautifully Crafted Cane Panel Cabinet Doors for Superior Ventilation, Upholstered Headliner, Aromatic Cedar Lined Drawers in Galley, Head Compartment, Owner's & Forward Cabins. Teak & Holley Sole Throughout, 17 Opening Ports with Screens.

#### EXTERIOR

- Exterior Wood Trim and Handrails of Oiled Teak.
- 2 Bow, 2 Stern and 2 Amidships Mooring Cleats.
- Full Length Anodized Aluminum Toerail.
- Double Bow & Stern Pulpits & Double Life Lines with Gates Port & Starboard.
- Flip Down Boarding & Swim Ladder on Swim Platform
- Inboard Genoa Tracks with Wide Sheave Blocks.
- Pedestal Wheel Steering System with S/S Wheel, Danforth 5" Compass with Binnacle, Engine Controls, Pedestal Guard and a Solid Teak Fold-Up Cockpit Table.
- Tinted Translucent Forward, Aft and Main Companionway Hatches.
- Hasp on Main Hatch for Pad Lock.
- Main Sail with 2 Sets of Reef Points, Fiberglass Battens, Leach Line, Cunningham, Draft Stripes and Windowed Tell Tails.
- 120% Genoa with Windowed Tell Tails, Leach Line, Draft Stripes and Sail Bag.
- 2 Cockpit Storage Lockers with Sliding Covers.
- Flush Sliding Transparent Cover Over Cockpit Engine Instrument Panel.
- Integral Fiberglass Swim Platform

#### DIMENSIONS

Length Overall Including Std. Swim Platform	39'-6"
Length Water Line	33'-8"
Beam	12'-0"
Draft-Standard Keel	6'-3"
Draft-Shoal Draft Keel	4'-11"
Displacement (Average)	15,500 lbs.
Ballast	4,500 lbs.
Bridge Clearance	54'-0"
Designer	Herb David



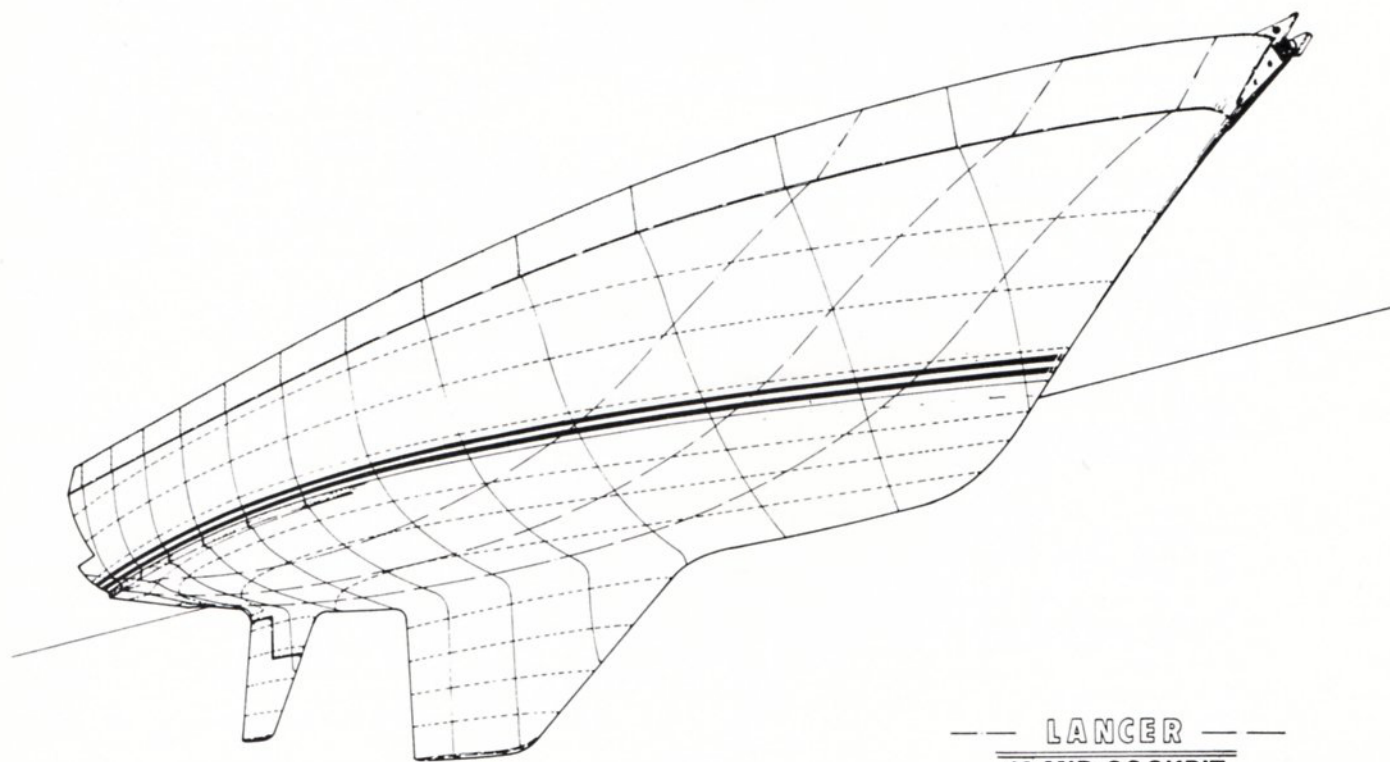
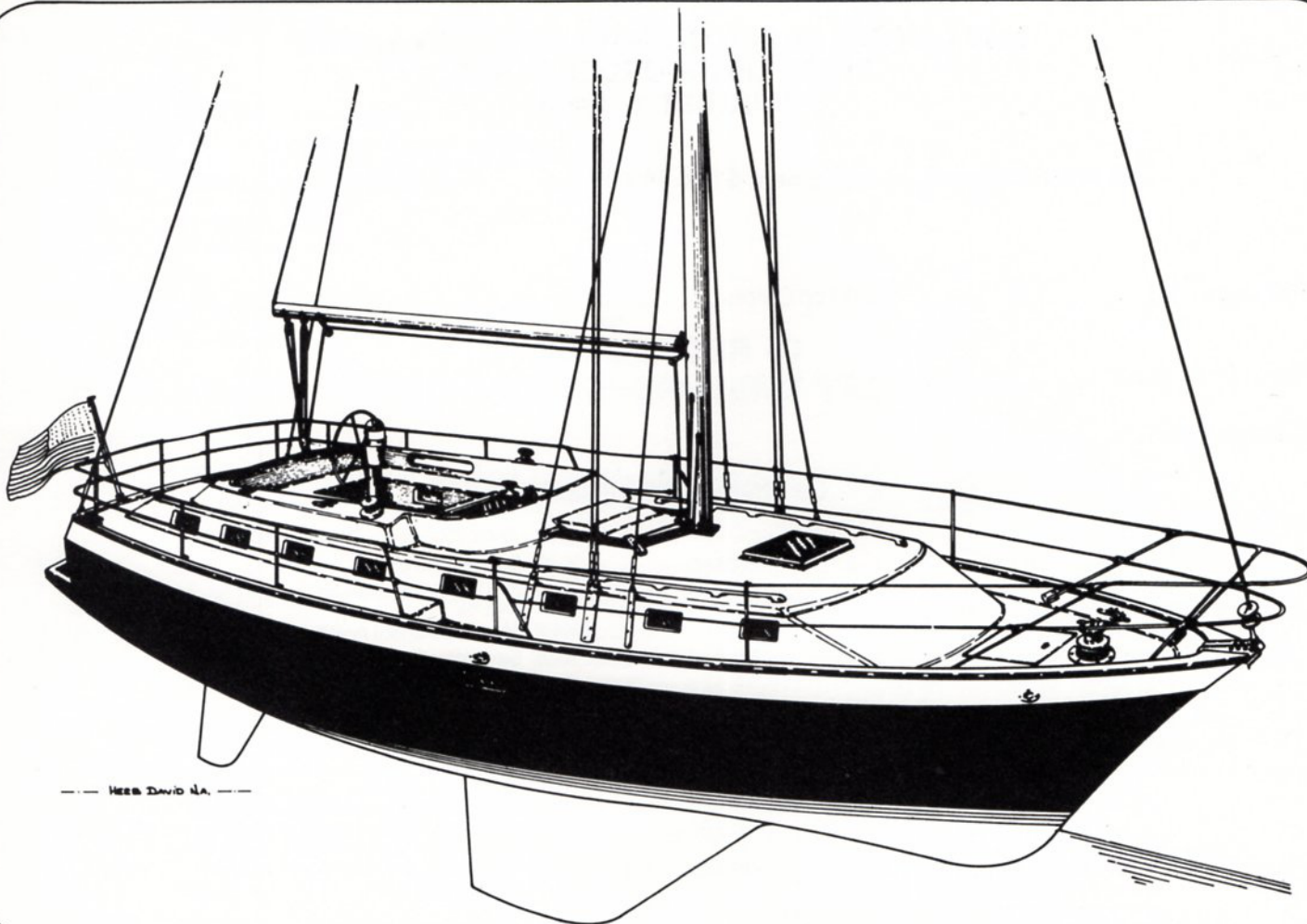

— LANCER —  
40 MID COCKPIT  
CRUISING YACHT

_____ K-30	2 Pod Instrument Housing .....	409.00
_____ K-31	3 Pod Instrument Housing .....	545.00
_____ K-32	4 Pod Instrument Housing .....	680.00
_____ K-33	Raytheon - Ray 53, 25 Watt VHF/FM Marine Radio Telephone-Solid State Circuitry, Fully Synthesized-All US VHF/FM Marine Channels, 54 Channel Transmit and 61 Receive - LED readout Shows Operating Channel - Four Weather Channels for Continuous Area Forecasts. Installed Complete with Mast Head Antenna (2 Year Warranty).....	888.00
_____ K-34	VHF Masthead Antenna with Coaxial Cable Wired to Navigator's Station .....	266.00
_____ K-35	Windex Masthead Wind Indicator .....	63.00
_____ K-36	Stereo System - AM & FM - Four Speakers & Tape Deck, 8 Track _____ Cassette _____ .....	623.00
_____ K-37	Seafire Automatic Fire Extinguishing System for Engine Room - Halon 1301 System Produces no Harmful Amounts of By-Products and no Residue. ....	655.00
_____ K-38	Backstay Adjuster Kit for Split Backstay- Includes 2 Wire Sheave Blocks, S/S Traingular Ring and 4 Part Tackle with Cam Cleat. ....	266.00



