

# Nonsuch 33

33'

**H**interhoeller Yachts is extending the revolution it created in developing the Nonsuch line of wishbone-rigged sailboats by introducing a fifth model, the Nonsuch 33, for the 1988 model year.

Following in the footsteps of other highly successful Mark Ellis-designed yachts, the Nonsuch 33 will feature the famous free-standing wishbone rig and the beamy catboat hull combination with a new tricabin layout, which includes two private staterooms.

"After so many successful years producing the Nonsuch, we know its rig or underbody achieve optimum performance; now by inserting the tricabin layout, we can add to the privacy of the belowdecks arrangement," said George Hinterhoeller.

The new Nonsuch 33 departs from its forerunners only in its increased privacy belowdecks. The 33 offers a family or two couples two spacious private cabins and a comfortable main saloon. The interior is complemented with a teak and holly sole and unusual 6'7" headroom throughout.

The forward cabin/owner's stateroom has a 6'9" double bunk, hanging locker, and

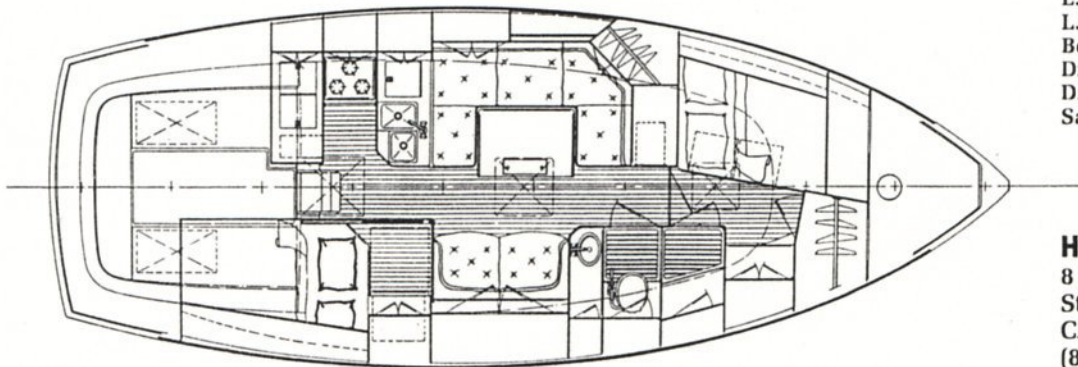
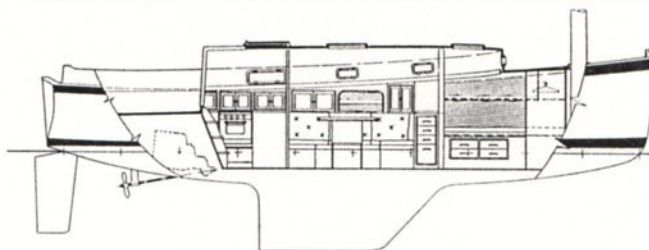
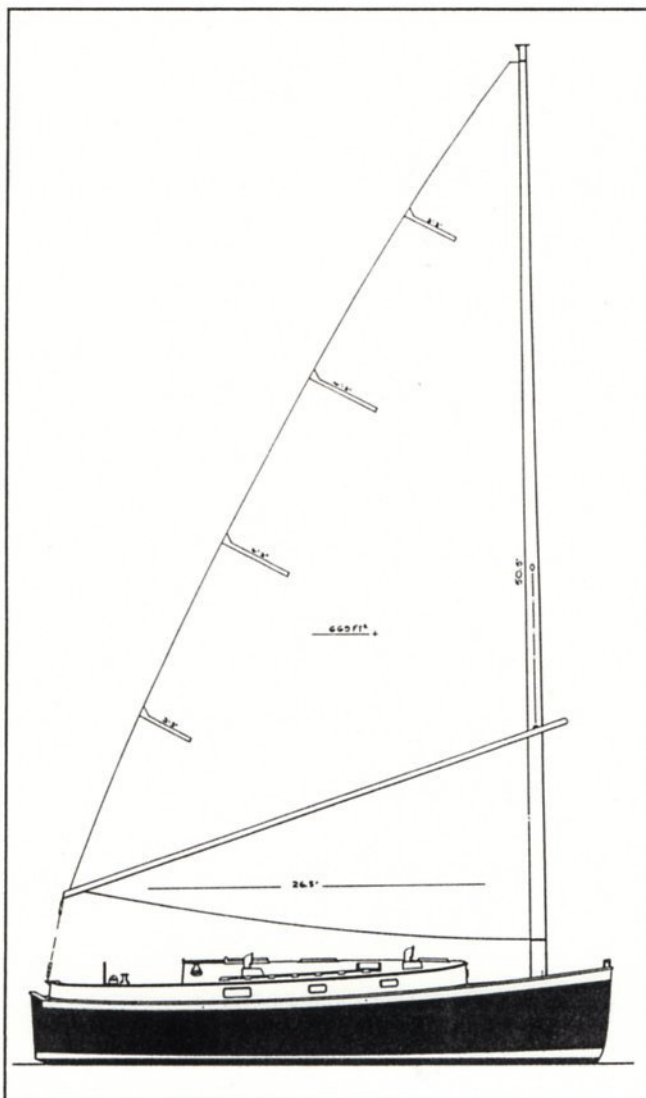

vanity with mirrored sliding door. Gear stowage is ample in the drawers under the bunk, lockers above the bunk, and outboard lockers along the hull. Two reading lights, a fluorescent light, and a skylight hatch provide plenty of light. Ventilation comes through a dorade, opening port, and of course, the skylight.

The head and shower compartment is accessed from the owner's stateroom or the main saloon. A shower curtain separates the shower stall from the head and vanity area. A large oval stainless sink with pressure water from a mixing faucet is situated in a large teak-fiddled vanity. A skylight hatch and opening port keep the head fresh and airy. A Lucite mirror is mounted on the bulkhead above the sink.

A C-shaped dinette in the main saloon converts into a 6'6" double bunk. Outboard lockers and shelving provide space for a library, entertainment center, and gear stowage. To starboard, a loveseat with swivel reading light can be converted into a child's bunk. A hanging locker forward and storage locker above are available for gear, books, and supplies.

The galley is to port of the companionway and features the standard C-format. A three-burner stove with oven, large and small stainless steel sinks, and a deep, hand-pumped icebox are all standard features. Dish and food stowage are located in outboard lockers and shelves aft of the icebox.

L.O.A.....	33' 5"
L.W.L.....	31' 6"
Beam.....	12' 6"
Draft.....	5' 4"
Displacement.....	15,350 lbs.
Sail Area.....	669 sq. ft.

**Hinterhoeller Yachts**  
8 Keefer Road  
St. Catharines, Ontario  
CANADA L2M 7N9  
(800) 556-7708  
(416) 937-4440