

The O'Day 35 is a refinement of the very popular O'Day 34. Several improvements have been incorporated to make the 35 more versatile and functional than her predecessor.

The design and engineering are by C. Raymond Hunt Associates of Boston, a firm with an international reputation for excellence and innovation in pleasure and commercial craft development.

Sailing performance is an important aspect of the O'Day 35. Although she is far from a flat-out race boat, the 35 is a good performer capable of doing well in club and PHRF events.

The transom platform is the most visible unique feature on the O'Day 35. This facilitates boarding and makes loading gear and supplies easier.

Both the deep-fin and shoal-draft keels are external lead ballast. This keel is bolted to a small keel stub molded into the hull. Heavy stainless steel bolts secure the keel through the stub to the transversal "floors" of the Uni Pan. Although this keel construction method is the most costly, it is also the best. External lead allows for a more efficient keel shape that can absorb the shock of an impact.

The O'Day 35 can accommodate six in comfort and seven if the quarterberth is used as a double. There is ample storage throughout the boat. Molded lift-out bins are under all berths for secure, dry storage of clothing, food, or equipment. Cockpit lockers to port are for sails and gear, a shallow gear locker is to starboard, and two lockers are aft for the propane tanks.

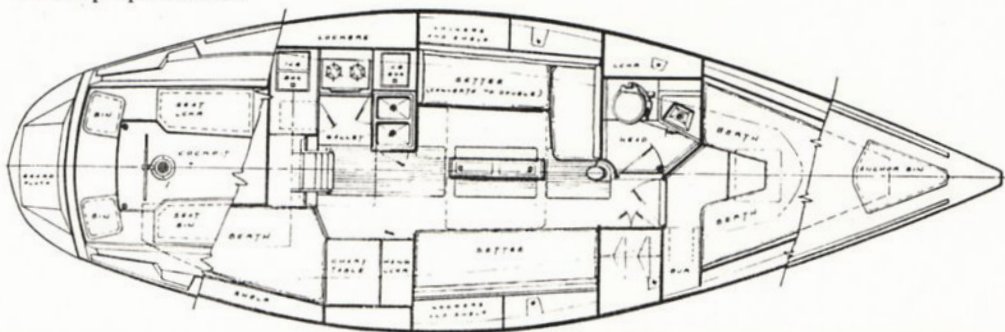
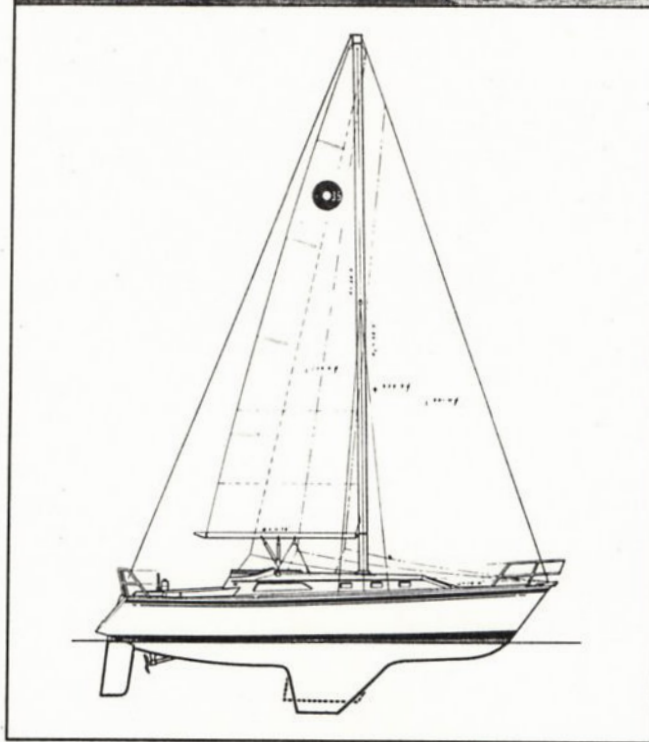
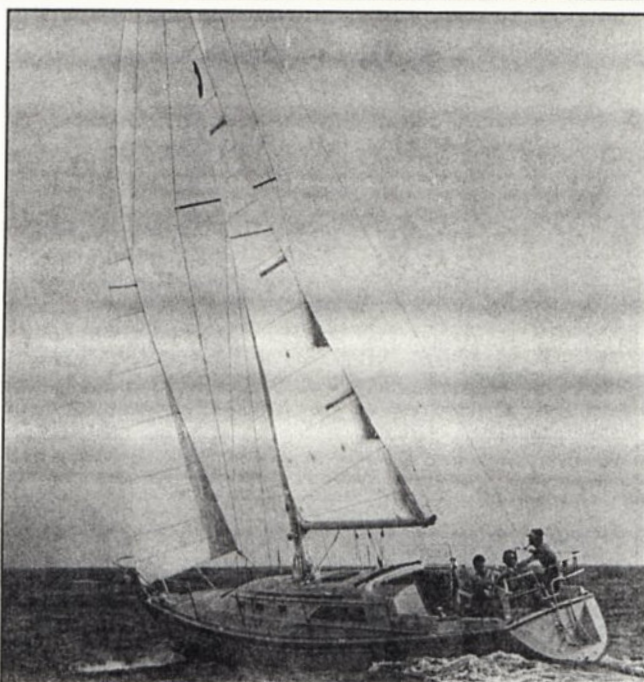

All the hardware, electrical and plumbing components, and machinery are readily available in the United States. If something breaks, you have the O'Day dealer network and the strength of a major American corporation standing behind your O'Day 35. Today's O'Day yachts are setting a new standard of quality.

1988 marks the 30th Anniversary of O'Day sailboats. In all, over 40,000 boats bearing the O'Day brand have been built. Current models include the Day Sailer 3 (17'), 192, 222, 272, 272LE, 302, 322, 35, and O'Day 40.

L.O.A.	35' 0"
L.W.L.	28' 9"
Beam	11' 3"
Draft:	
Deep Keel	5' 7"
Shoal Keel	4' 5"
Ballast:	
Deep Keel	4,600 lbs.
Shoal Keel	4,650 lbs.
Displacement	11,500 lbs.
Sail Area:	
100% Foretriangle	301 sq. ft.
Main	223 sq. ft.
Rig Dimensions	
Foretriangle:	
I (Height)	43' 0"
J (Base)	14' 0"
Main:	
P (Luff)	38' 0"
E (Foot)	11' 8"
No. of Berths	6
Water Capacity	50 gal.
Fuel Capacity	30 gal.
Auxiliary	21 H.P. Universal
Sails	Neil Pryde
Winches	Barlow
Designer	C. Raymond Hunt
Year Introduced	1984

O'Day

The O'Day Corporation
848 Airport Rd.
Fall River, MA 02720
(617) 678-5291

For More Information Circle No. 378