

The O'Day 40 is a fast, spacious cruiser employing modern design and construction with readily obtained American-made components available from a nationwide dealer network.

The interior features two large staterooms fore and aft. Forward is a large V-berth with two bunks and plenty of standing space. Adjacent to it is the head and hanging locker. Aft, the stern cabin has a huge double berth and is available with either locker and storage space or an optional head compartment with shower.

The main saloon has a U-shaped dinette and facing settee for comfortable seating and entertaining. Storage space abounds in overhead lockers, a bureau, and shelves with high seasails. Quality fabrics and a teak- and holly-sole lend a special ambiance. The navigation table is proportioned for full-sized charts with plenty of space for the latest electronics. Because the double-berth stateroom is well aft, the O'Day 40 main saloon is more spacious and open than those found on many larger boats.

The galley is suitable for liveaboard, charter, or pas-sagemaking. A 6-cubic-foot icebox (refrigeration is optional), propane stove with oven, and deep double sinks are all standard.

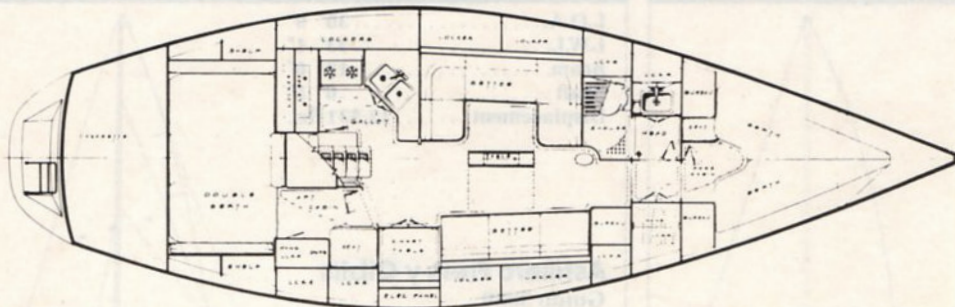
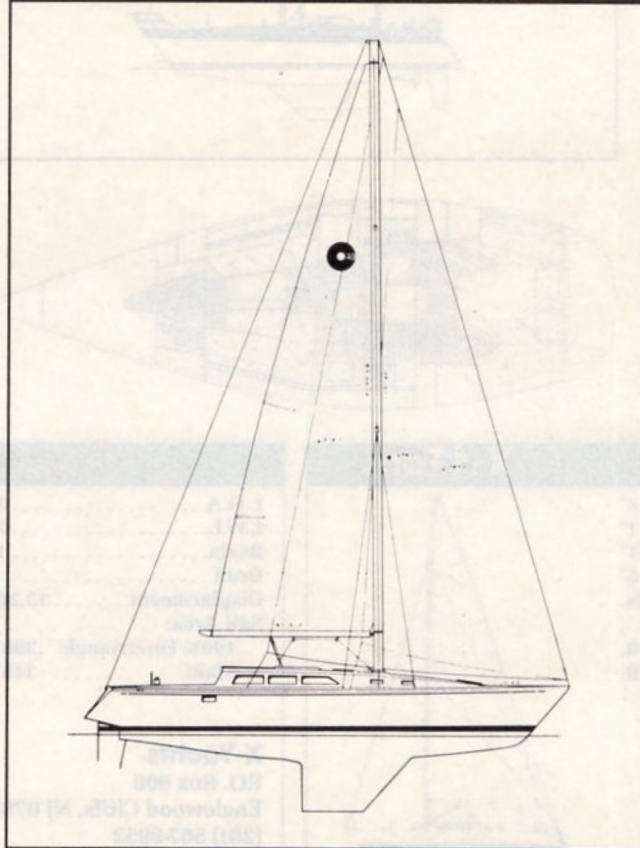

The cockpit is long and deep with comfortable contoured seating. The double-spreader rig is keel-stepped for added strength and stiffness. Halyards and mainsheet are led to self-tailing winches mounted on the cabintop.

The O'Day 40 hull is built of biaxial fabrics with a 3/4" balsa core, making it much stronger than a conventional, single-skin glass laminate. The hull and deck are joined and sealed with polyurethane adhesives as well as stainless steel bolts. Once in place they are further bonded with fiberglass mat and roving.

1988 marks the 30th Anniversary of O'Day sailboats. In all, over 40,000 boats bearing the O'Day brand have been built. Current models include the Day Sailer 3 (17'), 192, 222, 272, 272LE, 302, 322, 35 and O'Day 40.

L.O.A. 39' 7"
L.W.L. 33' 6"
Beam. 12' 7"
Draft:

Deep Keel 6' 4"
Shoal Keel 4' 11"

Ballast:
Deep Keel 6,600 lbs.
Shoal Keel 7,100 lbs.

Displacement:
Deep Keel 18,000 lbs.
Shoal Keel 18,500 lbs.

Sail Area:
100% Foretriangle 396 sq. ft.
Main 304 sq. ft.

Rig Dimensions
Foretriangle:
I (Height) 50' 7"
J (Base) 15' 3"

Main:
P (Luff) 44' 3"
E (Foot) 14' 2"

No. of Berths 7
Water Capacity 107 gal.

Fuel Capacity 42 gal.
Auxiliary ... 46 H.P. Westerbeke

Sails Neil Pryde
Winches Barlow

Designer C. Raymond
Hunt Assoc.

O'day

The O'Day Corporation
848 Airport Rd.
Fall River, MA 02720
(617) 678-5291