

O'Day Gold Medal Fleet '75

Fred Foucher

HOBIE CAT - CLIPPER - O'DAY
LONG BEACH
6400 E. Pacific Coast Hwy.
Long Beach, Calif. 90803
213/597-7755



The O'Day Story

Next port you enter, count the O'Day Sailboats. Newport, St. Petersburg, San Francisco Bay... wherever knowledgeable sailors anchor, you'll find O'Day's. Because O'Day builds sailboats for safe family sailing with a touch of exciting performance built in. We have since 1958.

Each O'Day...like the 40,000 before it...is built to fit special sailing lifestyles. Day Sailers with jumbo cockpits. Overnighters with cozy, cuddly accommodations. Family cruising models with plenty of living and entertaining room. And each and every one is designed to respond to your command...quick and sure... in all weather.



O'Day gives you cruising and performance advantages other skippers envy. They're durable, dependable, and safe...today and for years to come. With exceptional trade up or resale value. There's nothing average about an O'Day.

We invest considerable sums to develop designs and construct sailboats that are safe and kind to new skippers. With enough spirit for skilled salts. The ability to design a sailboat that performs with maximum efficiency on all points of sail is an art. When the wind is your only power...there's no room for trial and error designs. It's important, for your safety and enjoyment, that your sailboat be designed by a professional who has mastered the art of wind and sail. Men like Uffa Fox, Philip Rhodes, John Deknatel, Alan Gurney, Ian Proctor and Robert Baker. When you compare sailboats...consider the designer, ask when the model was first introduced, ask how many models have been built. The answers to these important questions will enable you to determine the overall value and potential resale market.

We retain the staff of C. Raymond Hunt Associates to design new models. To innovate. To constantly question, test, and re-test every manufacturing process and assembly technique. To test the durability of accessories and fittings...even the design of shipping cradles and delivery methods. They do more than just design for O'Day...they live and sail O'Day.



Added to their professional knowledge is the sailing experience of our 400 O'Day dealers, many of whom are exceptionally skilled sailors. And many who are weekend sailors. They all offer sound, practical ideas to improve the fun of sailors with limited hours. We want you to spend your time sailing, not repairing or replacing.

Now we don't pretend that every O'Day is custom built...it's not. They're not priced that way either. What we do claim is that we design and build sailboats to answer a variety of specific sailing lifestyles and budgets. We build them rugged and safe...like the Day Sailer for example...over 7,100 units delivered

during the past 17 years. And the Widgeon...over 3,300 units in 11 years. 1,223 O'Day 22's in just 2 years. And the O'Day 27 yacht is rapidly becoming a family cruising and racing favorite. We use performance-proven hardware and accessories to insure your safety and enjoyment. And because you'll want to trailer your boat...mooring and trailing bow eyes are standard on most models. Tabernacles are also standard on our cruising models. Non-corrosive or stainless steel hardware, non-skid decks, thru-bolted cleats, swaged terminals...all standard, for safety and enjoyment.

And to help keep your O'Day looking racy new for years ahead...hull and deck colors are molded in. So is the waterline stripe. The mast and boom are gold anodized for added distinction. O'Day's



list of standard equipment for each model is shown on pages 22 & 23...we strongly urge you to review and compare the completeness of each boat. And remember, the cost of each item is included in the base boat price...it's not extra.

Every time you trim your sails on an O'Day...a reputation that took 16 years to build goes on the line. And we back every O'Day model with a solid 2 year warranty. At O'Day, we accept reputation challenges more often than any other sailboat manufacturer because we are the world's largest producers of our size sailboats. We currently have manufacturing facilities at three locations...coast to coast. Our head-quarter's plant in Fall River, our mid America facility in Topeka, Indiana and on the West Coast at Costa Mesa, California.

O'Day...for safe family cruising or day sailing...climb aboard.

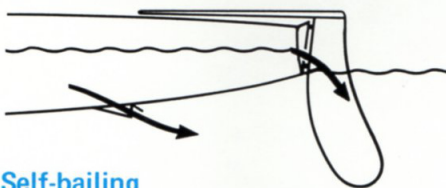

Self-bailing

Most O'Day Gold Medal sailboats have self-bailing cockpits. Very simply, it's a gravity system that allows any water accumulated to flow from the cockpit and then out through the hull. Your cockpit is always dry. The O'Day 25, O'Day 22, O'Day 20, Mariner, Day Sailer II and Javelin are all self-bailing.

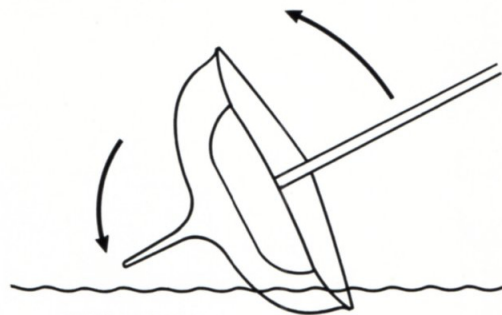

Self-righting

The O'Day 25, O'Day 22, O'Day 20 and Mariner are all self-righting. In a normal knock down, the hull will float on its side, high and dry...then the weight of the ballast will right the boat to its normal floating position...automatically.

Positive Foam Flotation

The O'Day 22, O'Day 20, Mariner, Rhodes, Day Sailer II, Javelin and Widgeon all have positive foam flotation that keeps them from sinking. Even if the hull is under water or damaged.

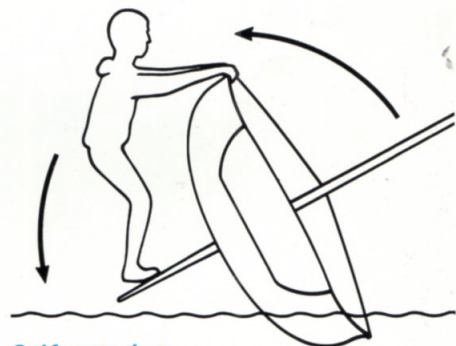

Self-rescuing

Like O'Day's self-righting models, the self-rescuing models are unsinkable. When capsized, they'll float so high that the weight of the crew standing on the centerboard will right the boat to its normal floating position. The O'Day Day Sailer II, Javelin and Widgeon are all self-rescuing.



O'Day 25 25

Length: 24'10"

Beam: 8'0"

Draft: Centerboard up 2'3",
down 6"

Sail Area: 272 sq. ft.

Designer: C. Raymond Hunt Associates

Introduced: 1975

Standard Equipment List: Page 22

CONCEPT

Build the maximum-sized, trailer-able cruiser. For regular-sized autos. For family sailors. With good sailing performance for savvy sailors. Modern design. Sleep 5 adults. Separate cabins for privacy. 5'6" cabin head room.

Here's O'Day's newest...right off the drawing boards and testing facilities of C. Raymond Hunt Associates in production for fall deliveries.

This sweetheart invites you to far away cruising with every turn. Sleek and stylish, yet broad beamed for live-aboard comfort. Her wide, flat decks invite sunbathing...and add extra safety when racing. Once you see the cabin, you won't believe she's only 25'...even after several cruises. The galley is aft, under a spacious companionway hatch, to add the pleasure of sunshine and air to meal preparing. Hanging locker. Stowage space. Five berths. Enclosed head. Two separate cabins with 5'6" head room. It's truly a unique interior for a 25...we've made maximum use of space for "live aboard" comfort. It's all there for your family cruising fun.

Here's a 25 you can take with you on vacations, or trailer to far away regattas for some exciting racing. Her keel is molded with the hull. And we've added 1,500 lbs. of inside ballast. She's a great performer on all points of sail. With the centerboard up, she draws only 2'3". Her shallow keel and tabernacle make launching and stepping the mast a single-handed job for an experienced salt.

And when you're ready to race her...be ready for another surprise. She's lively in light weather. Responsive and racy looking. High aspect rig. Deep spade rudder. High aspect ratio centerboard for good windward performance. A sharp knuckled bow. Racy hull. And a powerful, flat stern for good downwind performance and stability. She's ready to answer a challenge from wind...from sea...or from naive skippers.

She looks as good as she sails...inside and out. O'Day's newest family cruiser...the O'Day 25. Backed with O'Day's 2 Year Gold Medal Warranty.

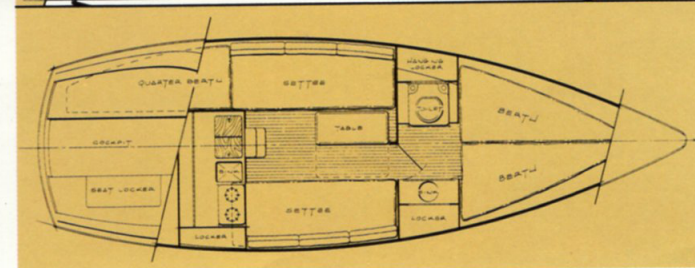



O'DAY GOLD MEDAL CRUISING FLEET

O'Day 22 22

Length: 21'8"

Beam: 7'2"

Draft: 23"

Sail Area: 196 sq. ft.

Designer: C. Raymond Hunt Associates

Introduced: 1972

Units Built to Date: 1,223

Standard Equipment List: Page 22

CONCEPT

Introduce a family cruiser with great style. Reverse transom. Light for trailering. Easy to rig. Plenty of safety features for family sailing...must be self-righting. Big boat luxuries.

Again C. Raymond Hunt Associates answered our call. First step was a unique, fool-proof keel design. It's long and shallow. Fixed. Draws only 23". A 600 lb. lead ballast is inside. She's self-righting. It's a design that already has been proven for safety and performance on over 1,000 O'Day 22's. Plus many copy attempts by other sailboat designers.

Her shallow 23" keel, tabernacle, and Hunt-designed rigging make launching, stepping the mast, and hauling a one "good man" task. Naturally it's easier with help from your crew.

For a 22, her cabin is jumbo sized. Bright and warm. Four full length adult berths. Carpet. Storage. Galley area. Private cabins. Head. New color-keyed interior design. Seats four for chow. Remove the galley table for extra space, cocktails, and salty tales. And to add that expensive, big-boat look, the cabin headliner is a

plush, textured fiberglass. Interior hull sides are covered with color coordinated vinyl. And rich teak trim throughout.

Here's a 22 that we invite you to compare to any other stock boat, up to a 25, for the same luxury and accommodations. And for performance...she'll respond quick and able to the most skilled skipper. Hard weather, fog, tricky channels...you can depend on the 22. It's O'Day built... better than it has to be.

For 1975, our designers have improved the main sheet system* by using a center cockpit arrangement of the backstay, thus eliminating the main sheet running to each side of the cockpit. It's more efficient. Quick and sure. The cockpit is self-bailing.

To keep up with her popularity, and to improve delivery, we build the O'Day 22 in 3 plants...California, Indiana, and Massachusetts. A family cruiser, rugged and safe... the O'Day 22. Backed with O'Day's 2 Year Gold Medal Warranty.



*O'Day's new main sheet system is not shown in these photographs. It is shown on Page 20.



O'DAY GOLD MEDAL CRUISING FLEET

O'Day 20 20

Length: 19'8"

Beam: 7'

Draft: Centerboard up 14",
down 4'5"

Sail Area: 175 sq. ft.

Designer: C. Raymond Hunt Associates

Introduced: 1973

Units Built to Date: 349

Standard Equipment List: Page 22

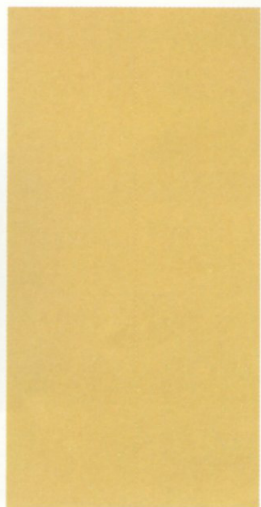

CONCEPT

Offer the "biggest" 20' family cruiser possible. Modern and stylish. Light for small car towing. A centerboard/keel design for good performance and shallow water cruising. Plus plenty of big boat amenities. And big boat safety...won't capsize or sink... must be self-righting.

Our designers, C. Raymond Hunt Associates, met our concept challenge. Then added a couple of their own ideas. They started off with a revolutionary design...the O'Day 20's long, thin, fixed keel. With the centerboard up, she draws only 14". This really makes trailering and launching a breeze. With the fiberglass centerboard down to its full 4'5"...she's a great competitor. Inside the keel is 400 lbs. of lead ballast to provide stability and insure self-righting.

The centerboard trunk is uniquely enclosed within the keel. Nothing protrudes into the cabin. Just usable space.

The cabin itself is a real wife pleaser...room to sleep and feed four adults. The galley table is removable for sunset get-togethers. Plus a textured fiberglass headliner to add that "big boat look".

Big as she looks, she's still easy to rig and sail. One man can step the mast. A new main sheet system* makes trimming easier, and keeps the cockpit free from lines. Like every good skipper, we're concerned with the safety of crew and guests. So are our Naval Architects. They designed a rugged structural fiberglass interior pan that is bonded to the hull for extra strength. The cockpit is self-bailing. And, for added safety, if knocked down, she'll right herself without aid from the crew.

The O'Day 20 is one of our newest and hottest...over 300 in the water today. To keep pace, and maintain quality, we build the O'Day 20 in California, Indiana, and at our headquarter's plant in Fall River. It helps keep delivery costs down and means you get faster warranty and parts service.

The O'Day 20...today's biggest twenty footer...backed with O'Day's 2 Year Gold Medal Warranty.

*O'Day's new main sheet system is not shown in these photographs. It is shown on Page 20.





Mariner 2 + 2

Length: 19'2"

Beam: 7'

Draft: Centerboard up 10"
down 4'11"

Sail Area: 185 sq. ft.

Designer: O'Day

Introduced: 1963

Units Built to Date: 2,795

Standard Equipment List: Page 22

CONCEPT

Use the proven hull of the Rhodes 19 to design a mini-cruiser with a jumbo cockpit. Cuddy cabin. Sink. Ice box. 4 berths. Provisions for head. Retain performance qualities of the Rhodes 19. Add safety features.

You don't "baby" the Mariner 2 + 2...you sail her hard. She's built to take heavy weather. And you know it the first time her hull slices into white water. Her hull is identical to our rugged, speedy Rhodes 19. In 1971, C. Raymond Hunt Associates redesigned the Mariner 2 + 2, making it safer and stylish. They also revised the cockpit. She's self bailing and she exceeds M.O.R.C. self-righting standards with the centerboard down. Her centerboard is a hefty 165 lbs., and there's 200 lbs. of lead ballast bonded to the hull. On an overnight, Mariner will sleep four in two forward and two quarter berths. Her cuddy cabin is cozy, with carpet, insulated ice box, and optional water pump and sink. There are even provisions for a pump out or portable, self-contained head. For 1975 we've redesigned her main sheet system* for easier handling.

Mariner's performance and size will reward you in all weather. Especially on those moderate-wind, blue-sky days. That's when six can relax in her exceptionally large cockpit...leaving the world to others for the day. Mariner's standard tabernacle allows you to step the mast single handed. Launching and hauling at day's end is no big problem; the draft is only 10", and we've provided a strong trailing bow eye.

Mariner...over 2,750 are in the water today. By far, one of today's best day sailers. And there's a very active national class association. Sail her as you wish...day sail or week-end...she's ready for trouble free fun.

Mariner 2 + 2...backed with O'Day's 2 Year Gold Medal Warranty.

For class information, contact:

Edward Rosenberg
26 Radial Lane
Levittown, N.Y. 11756



*O'Day's new mainsheet system is not shown in these photographs. It is shown on page 20.





Rhodes 19

Length: 19'2"

Beam: 7'0"

Draft: Centerboard up 10", down 4'11"

Keel model, 3'3"

Sail Area: 175 sq. ft.

Designer: Philip Rhodes

Introduced: 1959

Units Built to Date: 2,411

Standard Equipment List: Page 23

CONCEPT

Develop a strong day sailer and racing model with class appeal. Offer full racing options. Tapered mast. Strong hull. Offer choice of keel or centerboard models. And keep improving her. Year after year.

Excitingly different...keel or centerboard. The choice is yours. Whichever model you sail...you'll get great stability and performance on all points of sail. She's rugged and safe for family day sailing as well as spirited competition.

Test her in heavy seas. The Rhodes 19 hull is proven in heavy weather regattas. And her cockpit gives you working room. Even with 6 aboard, you'll have plenty of elbow room to handle your lines and halyards.

New main sheet system for '75 adds to her quick and sure handling. And, when you're ready to answer the racing call...go all the way...we've included a tapered mast and a full list of racing options for Rhodes 19. The optional spinnaker adds even more sailing versatility. Excellent for off-wind sailing.

Impressive boat...impressive credentials. Winner of the One Of A Kind Regatta. Selected for Mallory Cup Competition. We

know your satisfaction with your Rhodes 19 will help to spread the word. Over 2,400 have sailed her before you. She's part of the largest registered fleet in the Long Island Yacht Racing Association. That means good trade-up and resale potential.

Rhodes 19...designed for O'Day by Philip Rhodes. And backed by the O'Day 2 Year Gold Medal Warranty.

KEEL MODEL

You'll marvel at the stability of the Rhodes 19's thin, fixed keel. She draws only 3'3". You've made the right choice for all 'round sailing enjoyment. Heavy weather performance, or just leisurely "in-shore" cruising.

CENTERBOARD MODEL

Her speed and performance are remarkable. With the centerboard down, she's ready for any challenge.

With the centerboard raised, she draws only 10"...helps make launching and hauling easier.

For class association activities, contact:

Ira S. Cohen,
715 Shore Acres Drive
Mamaroneck, NY 10543





6625

O'DAY GOLD MEDAL DAY SAILING FLEET



Day Sailer II ^{DS}

Length: 16'9"

Beam: 6'3"

Draft: Centerboard up 7",
down 3'9"

Sail Area: 145 sq. ft.

Designer: Uffa Fox

Introduced: 1959

Units Built to Date: 7,162

Standard Equipment List: Page 23



CONCEPT

Design the best "all around" day sailer possible. A boat that 2 can handle, even in strong seas. Include a good sized cuddy enclosure. Make it easy to trailer. And build her good enough to become America's best selling day sailer.

Day Sailer II does it all...all day long. From the time you hitch your Day Sailer to the family wagon, or your son's sports car... 'til sunset, when you sail her right up to the beach...your Day Sailer II is proving her versatility. First time under sail, you'll know why she's become so universally popular since Uffa Fox designed her back in 1958. Over 7,000 owners at last count.

From coast to coast...more than 89 Day Sailer fleets make up America's largest class association. She draws a mini 7" with the centerboard raised, for easy launching just about anywhere. And in difficult winds, Day Sailer II's new mainsheet system*, new jib sheet system, and improved centerboard mechanism make trimming and handling sure and quick. You can handle all sheets and halyards from within the cockpit.

And when seas build, you and your crew will really appreciate O'Day's safety features...self-bailing cockpit, positive foam flotation, and non-skid decks and seats. If knocked down...the crew

can right her. For light air or docking help, mount up to an 8 h.p. outboard on her rugged, reinforced transom. There's dry shelter for gear, you, and your first mate in the cuddy enclosure. She has a built-in, insulated ice box. And a cuddy cabin door may be added for lockable storage.

Each time you furl your sails after a day of family fun, you'll appreciate your Day Sailer II's performance a little more. That's probably why her popularity continues to grow. She's well designed and soundly built. And, if you ever have to part, she'll reward you with generous resale price or trade-up allowance.

When you're ready for fun or competition...your O'Day Day Sailer II is ready...to do it all. Backed with O'Day's 2 Year Gold Medal Warranty.

O'Day has two Day Sailer models. The Day Sailer II and the original Day Sailer, available on special order. Both have Day Sailer Class Association acceptance.

For class information, contact:
Dolores Bayer,
2801 Raleigh Lane
Cincinnati, OH 45215



*O'Day's new mainsheet system is not shown in these photographs. It is shown on Page 20.



O'DAY GOLD MEDAL DAY SAILING FLEET



Javelin

Length: 14'0"

Beam: 5'8"

Draft: Centerboard up 6",
down 3'10"

Sail Area: 125 sq. ft.

Designer: Uffa Fox

Introduced: 1962

Units Built to Date: 3,254

Standard Equipment List: Page 23

CONCEPT

Design a gutsy, family day sailer. Big, big cockpit. Stable. Strong. Trailerable. With superior handling in all conditions. Lots of fleet appeal.

We turned to Uffa Fox to answer this demanding design challenge. He drew on years of solid, first-hand experience and came back with the O'Day Javelin. 14' of solid performance. It all started in 1962, and since then over 3,200 Javelins have been launched.

She makes an ideal family boat... especially for beginning sailors. She'll give you great response and handling in any sea. Javelin is a centerboarder with exceptional strength and durability. She has a 5'8" beam and overall hull weight of 475 lbs. to give her more strength than most boats her size.

She is easily trailered and can be launched by the skipper alone. For family day sailing safety and comfort, there's an unusually large cockpit. Nearly ten feet long...with room for six adults... oversized for day sailing comfort.

Beneath the foredeck, there's a lockable hatch and room for dry storage of gear, lunch and refreshments. An insulated ice box is built into the cockpit seat.

For 1975 O'Day has redesigned the Javelin's main and jib sheet systems* to make handling easier and more efficient. Standard safety features include positive foam flotation, self-bailing cockpit and non-skid deck and cockpit surfaces. She's also self-rescuing. Roominess, class, safety, and superior handling... all in the O'Day Javelin.

Sail her once and you'll quickly understand why Javelin was chosen for the 1974 North American Solo Championships. Javelin... the ideal family day sailer. Backed by O'Day's 2 Year Gold Medal Warranty.

For class information, contact:
Robert Mardt, Jr.
233 Benham Road
Groton, Conn. 06340

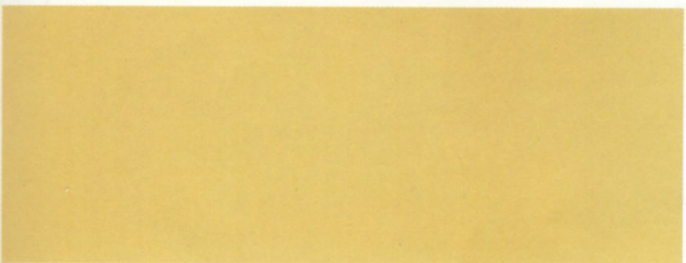

*O'Day's new main sheet system is not shown in these photographs. It is shown on Page 20.



O'DAY GOLD MEDAL DAY SAILING FLEET



Widgeon

Length: 12'4"

Beam: 5'

Draft: Centerboard up 5",
down 3'6"

Sail Area: 90 sq. ft.

Designer: Robert Baker

Introduced: 1964

Units Built to Date: 3,322

Standard Equipment List: Page 23

CONCEPT

Design the smallest adult-size sailboat. Planing hull. Include all the goodies...main, jib, spinnaker. Make it exceptionally durable for club and sailing programs. Make it safe and easy to sail for beginners. Car top and trailer. Build it to last.

She's safe and kind to new skipper...and adults still become excited with Widgeon's performance. She's spirited, even in light air. Sail her once and you'll know the reasons for her lasting popularity. Over 3,300 Widgeons are sailing today. Junior and Frostbite programs across the nation send their novice and most skilled sailors to compete in the safe and sturdy Widgeon. Positive foam flotation, non-skid decks, and self-rescuing cockpits keep them safe. With your Widgeon in shallow water you'll have no fear of costly damage caused by a daggerboard that will not swing up...we designed the Widgeon right...with a kick-up rudder.

For 1975, we moved the 2 jib cam cleats from the top of the centerboard trunk to locate them, one on each side deck. This greatly improves the jib sheet system and keeps the cockpit free of jib lines. We've also improved the centerboard mechanism. All to make sailing safer and more fun. Widgeon will plane in a favorable wind. She can be sailed cat or sloop rigged. Optional teak hatch covers are available to create a dry stowage area beneath the foredeck.

O'Day Widgeon...light enough to be car topped, strong enough to trailer. Launch her from just about anywhere to join the fun and challenge of Widgeon competition.



O'Day Gold Medal

Adjustable Mast Step...When rigging your boat you can precisely adjust your mast to your sails...and to your liking...by means of the adjustable mast step. Rake the mast forward to reduce weather helm. Aft to increase it.

Decorative Plaques...Handsome stainless steel half-model plaques permanently mounted on a walnut base. Profile line drawing of your class boat permanently etched on brushed steel finish.

Cockpit Cushions...These handsome, durable vinyl cushions make a trip more pleasurable for everyone as well as provide additional bunks when you rig the boom tent. (Not recommended with cockpit travelers.)

Trailers...Safe, rugged, long-lasting trailers designed to resist corrosion are available for most O'Day boats, so you can take your O'Day almost anywhere.

Compass...Built for O'Day by one of New England's best known manufacturers of navigation instruments. These compasses are specially gimballed for sailboat use...3" and 4" bracket or flush mounted. Plus a 4" bulkhead mount.

Genoa and Gear...A genoa adds tremendously to the speed of your boat. You can handle this bigger sail with ease thanks to a worksaving rig consisting of tracks with adjustable lead blocks, winches and jam cleats.

Spinnaker and Gear...For your boat there's a spinnaker and gear engineered for maximum ease of handling and boat speed. Gear includes spinnaker pole, mast fittings, leads for sheet and guy and all other necessary equipment.

Lifting Sling...Haul the boat faster, safer and with all strain well distributed by this extra-strength sling especially designed for your boat.

Roller Reefing Claw...It's blowing a gale. You reduce the size of your main by rolling part of it around the boom...a process called roller reefing. Then, instead of having to control the mainsheet from the end of the boom, you can "grab" the boom at its center with this claw especially designed to be set and removed in seconds without tearing the sail.

Masthead Flotation Device...Here's a lightweight, positive-acting flotation balloon that's actuated by immersion. Even the best-designed boat can "turn turtle" under extreme conditions. In the event of a capsize, a rubber balloon fills with CO₂ to help keep mast at water level.

Cockpit Cover...The cockpit cover can be used regularly when the boat is at the mooring or for extra sleeping shelter.

For 1975 we've made several modifications designed to improve sail handling.

Jibsheet system...for the Javelin and Day Sailer...makes single handed sailing more convenient. The new system uses a fair lead cam action jam cleat on a slide. It's adjustable and eliminates the need for the jam cleat on the centerboard trunk. This cleans up the cockpit and makes for more efficient sail handling.



1. Cowl Vent...With everyone snug in the forward bunks, the cowl vent provides excellent ventilation. It also helps keep your boat fresh smelling and dry.

2. Translucent Hatch...Optional on the O'Day 20 and 22 is a translucent hatch that provides additional ventilation and light for forward areas, extra access for gear, and more safety.

3. Sail Covers...A sturdy fabric cover to keep your main clean and protected. These covers are especially designed to fit the booms.

4. Tabernacle...A special adaptation for your mast. It makes it safer and easier to rig and unrig the boat. Mast can be lowered to the horizontal without danger of the lower end "kicking out".

5. Whisker Pole...You're running "wing and wing" before the wind with your jib out to the opposite side from your mainsail. You insert one end of the whisker pole in the clew of the jib and attach the other end to the mast. Thus your jib keeps maximum sail area exposed to the wind.

6. Spinnaker "Turtle" Bag...Your spinnaker rides neatly and compactly in this lightweight nylon bag that attaches to the sidestay or headstay ready to hoist on an instant's notice.

7. Cockpit Awning...A custom fitted, rugged fabric cockpit awning for cool on-deck activities, custom fitted for the O'Day 20, 22, 25 and 27.

8. Tiller Extension...When sailing single handed, it's like another arm because it allows you to move forward to adjust lines without letting go of the tiller.

9. Block-Action Outhaul...By letting off on the clew outhaul you slack the tension along the boom. When you trim for a beat, you tighten on the outhaul and the foot is taut again. This outhaul has 2 blocks for faster more effortless adjustment.

10. Hiking Straps...For better racing performance and when a gust hits, you can keep your boat flat in the water by hiking out. These foot straps running fore and aft on both sides of the cockpit enable you to get more weight outboard...quickly...and safely.

11. Working Jib Furler...When you set a spinnaker you want the jib out of the way fast. When you douse the spinnaker you want the jib back just as fast. The jib furler gives you the quickest, neatest way to do both without even touching a halyard. When sailing single handed or in very heavy wind you can reduce your jib area or eliminate it without having to go to the foredeck. For optimum performance luff wire should be 1 x 19 type.

12. Outboard Motor Bracket...A strong, lightweight bracket of anodized aluminum with a sturdy wooden pad to accommodate up to a 12 h.p. outboard motor. Available for the O'Day 20, 22, 25 and 27.

13. Boom Vang...With the mainsheet out, wind pressure against the sail tends to lift the boom. To keep the boom level you take up on the boom vang. You preserve your projected sail area and thus your speed.

Shown Left

Mainsheet system...for the Mariner, Rhodes, Day Sailer, and Javelin, we're now using a center cockpit fitting. This eliminates running the line near the aft end of the cockpit. It's more efficient, cleaner and it's out of the way of the outboard engine.

Shown Right

Mainsheet system...for the O'Day 20 and 22...we've instituted a simpler, more efficient system. It's a three-part system that runs off the back stay so there's no hardware mounted on the deck for the main sheet. Again, a cleaner cockpit. Quick and sure response.

Accessories for '75

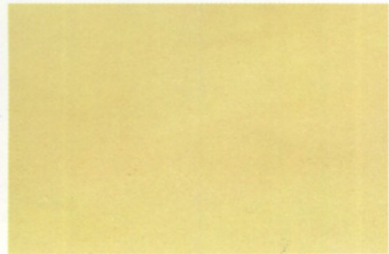
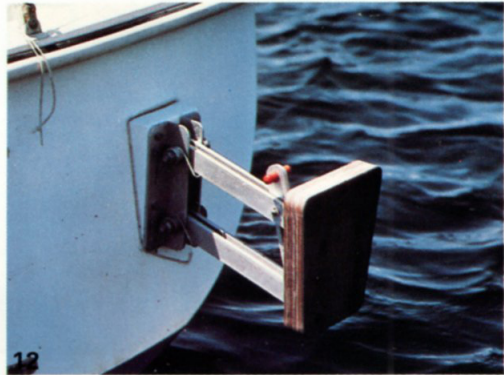

STANDARD EQUIPMENT	25	22	20	M
PLEASURE GROUP				
All hardware non-corrosive or stainless steel	X	X	X	X
Built-in insulated ice box				X
Forward cabin door	X	X		
Carpet				X
Dinette table	X	X	X	
Forward Hatch	X			
Galley Unit (stove area, ss sink, pump, water tank, insulated ice box and storage compartment)	X			
Hanging locker	X	X		
Kick-up rudder				X
Mainsheet traveler	X			
Mooring and trailing bow eye		X	X	X
O/B gas tanks' storage locker	X			
Storage locker	X	X	X	
Storage shelves	X			X
Tabernacle	X	X	X	X
Transom designed for outboard				X
2 year warranty	X	X	X	X
Vinyl gunwale guard	X	X	X	X
ACCENT GROUP				
All colors molded in	X	X	X	X
All exterior wood is teak	X	X	X	X
Fiberglass centerboard trunk cap				X
Gold anodized mast and boom	X	X	X	X
Gold racing stripe	X	X	X	X
Molded in waterline stripe	X	X	X	X
Varnished Philippine mahogany trim (Inter.)				X
SAFETY GROUP				
Automatic cockpit drain	X	X	X	X
Mast is sealed for flotation				X
Non-skid deck and seats	X	X	X	X
Positive foam flotation		X	X	X
Roller reefing	X	X	X	X
Self-bailing cockpit	X	X	X	X
Self-righting	X	X	X	X
Stainless steel rigging with swaged terminals	X	X	X	X
Thru-bolted mooring cleats		X		
Thru-bolted mooring and stern cleats	X			X
HIGH PERFORMANCE GROUP				
Adjustable jib sheet leads				X
Best dacron running rigging	X	X	X	X
Full masthead rig	X	X	X	
Inside lead ballast	X	X	X	X
Quick release cam cleat for main sheet	X	X	X	X
Quick release cam cleats for main & jib sheets				X
Stainless steel rigging with swaged terminals	X	X	X	X
Stainless steel wire halyards with dacron tail	X	X	X	X

GOLD MEDAL SPECIFICATIONS	O'Day 25	O'Day 22	O'Day 20	Mariner C/B
Overall Length	24'10"	21'8"	19'8"	19'2"
Waterline Length	21'	19'	17'4"	17'9"
Beam	8'	7'2"	7'	7'
Draft Minimum	2'3"	1'11"	14"	10"
Draft Maximum	6'	1'11"	4'5"	4'11"
Sail Area	270	196	174	185
Max. Recom. H.P.**	12	12	12	10
Mast Length	29'	22'9"	22'9"	24'8"
Mast Weight	60	42	42	40
Boom Length	9'	8'6"	8'6"	10'4"
Boom Weight	10	10	10	10
C/B - Keel Material	Lead	Lead	Lead	Iron & Lead
C/B - Keel Weight Approx.	1500	600	400	165 & 200 ballast
Rudder Type	Fixed	Fixed	Fixed	Kick up
Rudder Material	FG	FG	FG	W
Seating	6	6	6	6-8
Weight Complete Ap.	3600	1800	1600	1305
Safety Features	SB, SRT	SB, SRT	SB, SRT	SB, SRT

SS — Stainless Steel FG — Fiberglass W — Wood C/B — Centerboard
AL — Aluminum SB — Self-Bailing Cockpit SR — Self-Rescuing
SRT — Self-Righting
**Long Shaft Model

All prices and specifications are subject to change without notice. Prices F.O.B. Fall River.

O'DAY 25

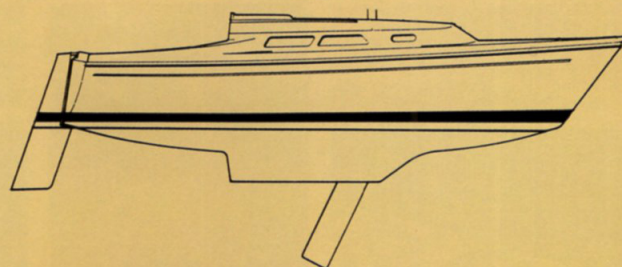
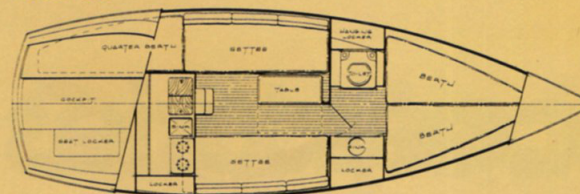

O'DAY 22

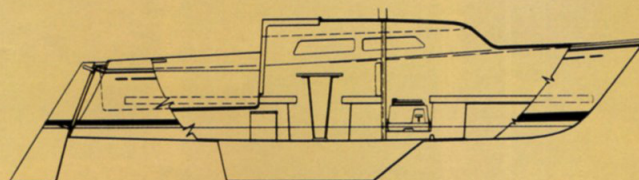
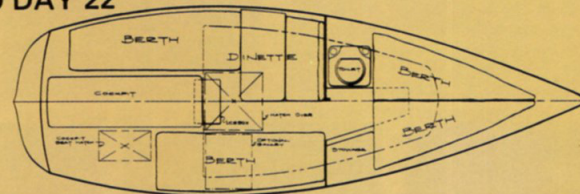

O'DAY 20

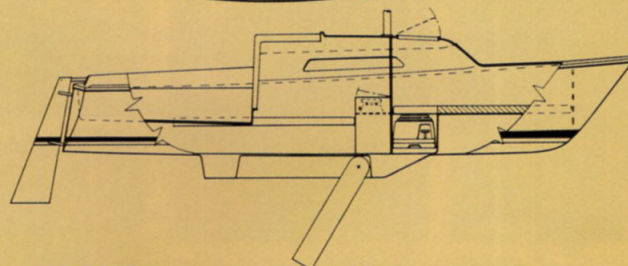
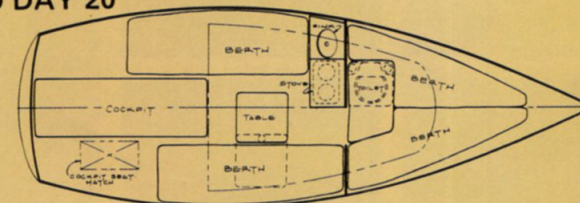

MARINER

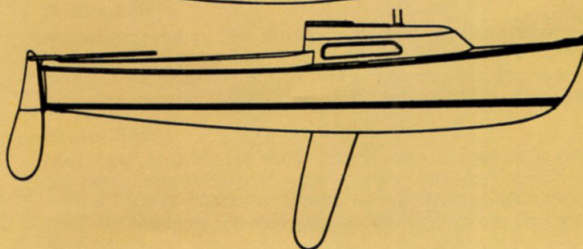
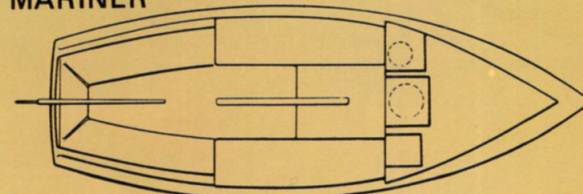

STANDARD EQUIPMENT	R19	D.S.	J	W
PLEASURE GROUP				
All hardware non-corrosive or stainless steel	X	X	X	X
Boom crutch	X	X	X	
Built-in insulated ice box		X	X	
Cockpit drain plug	X	X	X	X
Kick-up rudder (C-B Model)	X	X	X	X
Mooring and trailing bow eye (C-B Model)	X	X	X	X
Outboard motor well	X			
Rear storage rack	X			
Bow storage locker	X	X	X	
Storage shelves	X			
Transom designed for outboard		X	X	X
2 year warranty	X	X	X	X
Varnished Philippine mahogany floorboards	X			
Vinyl gunwale guard	X			
ACCENT GROUP				
All colors molded in	X	X	X	X
Fiberglass centerboard trunk cap	X			X
Gold anodized mast and boom	X	X	X	X
Gold racing stripe	X	X	X	X
Molded in waterline stripe	X	X	X	X
Two-tone cockpit color		X	X	X
Varnished Philippine mahogany trim	X			
SAFETY GROUP				
Automatic cockpit drain		X	X	
Mast is sealed for flotation		X	X	X
Non-skid deck and seats	X	X	X	X
Positive foam flotation	X	X	X	X
Roller reefing	X	X	X	
Self-bailing cockpit		X	X	
Self-rescuing		X	X	X
Stainless steel rigging with swaged terminals	X	X	X	X
Thru-bolted mooring and stern cleats	X	X	X	
2 cockpit inspection/bailing ports		X	X	
HIGH PERFORMANCE GROUP				
Adjustable jib sheet leads	X	X	X	
Best dacron running rigging	X	X	X	X
Internal mast halyards	X			
Quick release cam cleats for main & Jib sheets	X	X	X	X
Stainless steel turnbuckles	X	X	X	X
Tapered mast	X			

GOLD MEDAL SPECIFICATIONS	R-19 C/B & R-19K	Day Sailer II	Javelin C/B	Widgeon
Overall Length	19'2"	16'9"	14'	12'4"
Waterline Length	17'9"	16'	13'2"	11'6"
Beam	7'	6'3"	5'8"	5'
Draft Minimum	10"	7"	6"	5"
Draft Maximum	4'11"††	3'9"	3'10"	3'6"
Sail Area	175	145	125	90
Recom. Max. H.P.**	10	8	8	4
Mast Length	28'4"	24'3"	23'1"	18'8"
Mast Weight	42	27	23	18
Boom Length	10'4"	10'4"	10'4"	8'4"
Boom Weight	10	10	10	5
C/B - Keel Material	Iron	FG	Galvan. Steel	FG
C/B - Keel Weight Approx.	165***	21	49	15
Rudder Type	Kick up †	Kick up	Kick up	Kick up
Rudder Material	W	FG	FG	FG & AL
Seating	6	6	6	4
Weight Complet Ap.	1030 †††	575	475	285
Safety Features	—	SB, SR	SB, SR	SR

SS — Stainless Steel FG — Fiberglass W — Wood C/B — Centerboard
 AL — Aluminum SB — Self-Bailing Cockpit SR — Self-Rescuing
 SRT — Self-Righting
 *R-19K — 3'3" †R-19K — Fixed
 **Long Shaft Model ††R-19K — 3'3"
 ***R-19K — 415 †††R-19K — 1355

RHODES 19

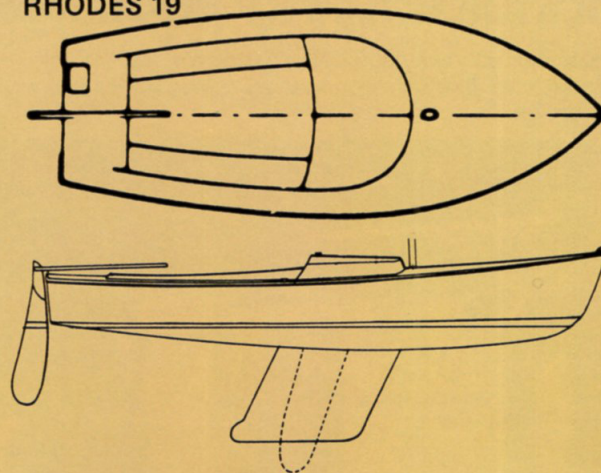

DAY SAILER

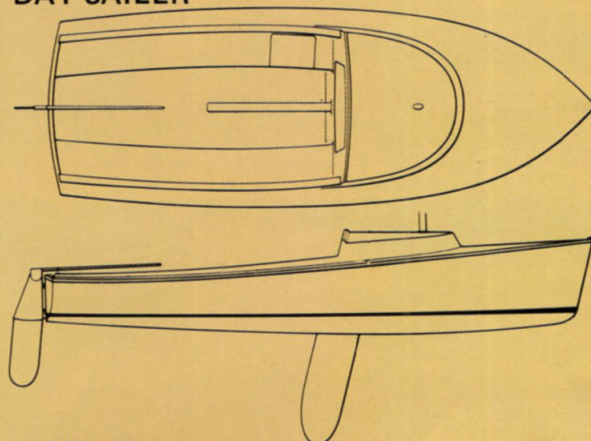

JAVELIN

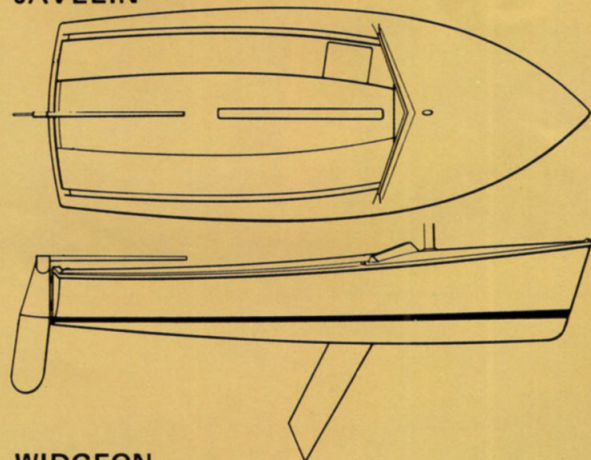

WIDGEON

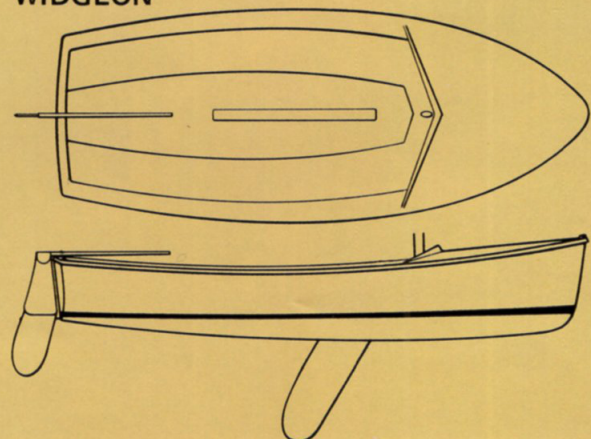

3 Manufacturing Facilities

O'Day sailboats are manufactured in California, Indiana and Massachusetts for shipping economy, parts availability and prompt service.



Headquarter's Plant, Fall River, Massachusetts. Currently building all models from the O'Day 32 to the Widgeon.



Mid-America Plant, Topeka, Indiana. Currently building the O'Day 22, O'Day 20, Day Sailer II, Javelin and Widgeon.



West Coast Plant, Costa Mesa, California. Currently building the O'Day 27, O'Day 22, O'Day 20, Day Sailer II and Widgeon.

2 Year Warranty

Every item manufactured by the O'Day Company is warranted to be free from defects in material and workmanship at the time of factory shipment from O'Day's plant. O'Day will repair or replace any item which was defective at the time of shipment from O'Day's plant provided O'Day is promptly notified within thirty (30) days after the date of discovery of defect by the original user but in no event shall this warranty extend beyond a period equal to 24 months from the date of purchase or factory shipment, whichever is sooner, and, if requested by O'Day for purposes of verification of any claimed defect, the item is returned to O'Day for examination. Any cost of returning the item shall be paid by the owner. In no event shall O'Day's liabilities for defects for any item manufactured by O'Day exceed O'Day's replacement cost. This warranty is VOID if: 1) repairs are attempted by anyone other than O'Day or its authorized designees, 2) repairs are needed due to normal wear and tear or lack of maintenance, 3) for replacement of a part which is a normal maintenance item. This warranty does not apply to accessories manufactured by others but furnished with O'Day's equipment as they are usually warranted by their respective manufacturers. THERE ARE NO WARRANTIES, EITHER EXPRESSED OR IMPLIED, OF MERCHANTABILITY, FITNESS OR OTHERWISE, WHICH EXTEND BEYOND THE WARRANTY EXPRESSED HEREIN. O'Day accepts no responsibility or liability for any representations, acts or omissions of retail or wholesale dealers relating to the preparation and/or sale of O'Day's products to original users.

You're Invited

Visit the O'Day plant in Fall River for a firsthand look at proud craftsmen building sailboats in the O'Day tradition... "Everthing better than it has to be" for safety and performance.

Contact your O'Day dealer for a VIP Plant Tour Pass. Visitors are welcomed Monday through Friday from 11 to 11:30 A.M. and 3 to 3:30 P.M.

Oday



A BANGOR PUNTA COMPANY

O'Day/848 Airport Road/Fall River/Massachusetts 02720