

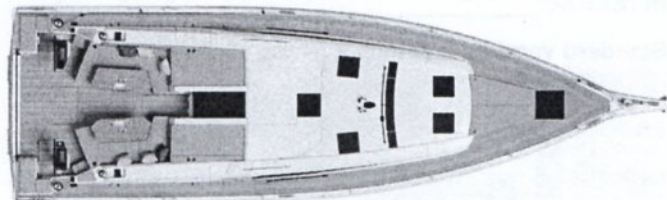

BENETEAU

Oceanis 52

Provisional Specifications - Europe

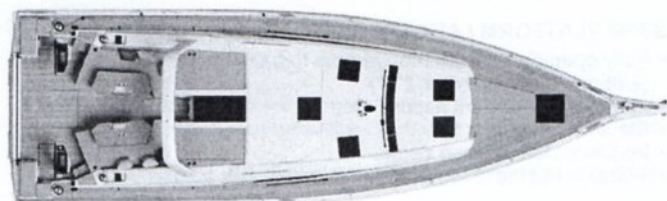
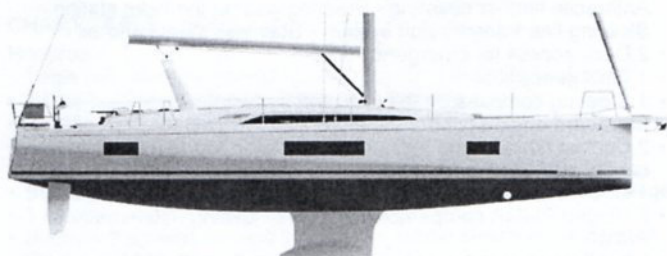

3 cabins 2 heads version:

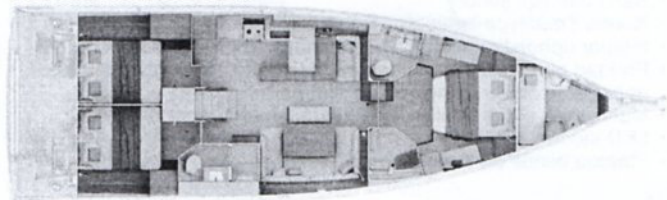

5 cabins 3 heads version:

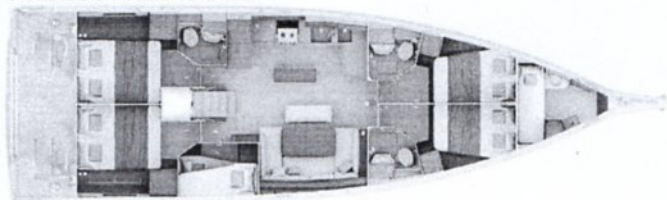

GENERAL SPECIFICATIONS *

• L.O.A (with bowsprit)	16,28m	53'5"
• L.O.A (standard)	15,75m	51'8"
• Hull length	15,31m	50'3"
• L.W.L.	14,67m	48'2"
• Beam	4,84m	15'11"
• Deep draft (Cast iron)	2,36m	7'9"
• Deep ballast weight	3 396kg	7,485 lbs
• Shallow draft (Cast iron)	1,92m	6'4"
• Shallow ballast weight	3 604kg	7,943 lbs
• Air draft:		
- Mast 2 spreaders	22,00m	72'
- Mast Performance	23,85m	78'
• Light displacement	14 476kg	31,905 lbs
• Fuel capacity (standard)	200L	53 US Gal
• Fuel capacity (Option)	200L	53 US Gal
• Fresh water capacity (standard)	420L	111 US Gal
• Fresh water capacity (Option)	300L	79 US Gal
• Engine power (Sail drive)	110 HP	110 HP

ARCHITECTS / DESIGNERS

- Naval Architect: Biscontin Yacht Design
- Outside & interior design: Nauta Design

EC CERTIFICATE REQUIRED *

- Category A - 13 people
- Category B - 14 people
- Category C - 16 people

STANDARD SAILS DIMENSIONS *

• Furling mainsail (standard)	46,50m ²	500 sq/ft
• Self-tacking jib (standard)	47,50m ²	511 sq/ft
• Classic mainsail	59,50m ²	640 sq/ft
• Genoa - 105 %	67,50m ²	727 sq/ft
• Code 0	143,00m ²	1,539 sq/ft
• Asymmetric spinnaker	187,00m ²	2,012 sq/ft
• I	19,00m	62'4"
• J	6,30m	20'8"
• P - Roller furling mast	18,00m	59'1"
• P - Mast 2 spreaders	18,18m	59'8"
• E	5,50m	18'1"

PERFORMANCE (3 spreaders mast, +1,80m / 5'11")

• Classic mainsail	66,50m ²	716 sq/ft
• Genoa	76,50m ²	823 sq/ft
• I	20,90m	68'7"
• J	6,30m	20'8"
• P	20,00m	65'7"
• E	5,50m	18'1"

seanapps

CONNECT YOUR BOAT FREE YOUR MIND

* Provisional specifications, boat in process of certification.



BENETEAU

Oceanis 52

Provisional Specifications - Europe

STANDARD EQUIPMENT

CONSTRUCTION

- Design in accordance with European Directive requirements and according to CE certification
- Vacuum infused hull (GRP / Sandwich balsa wood)
- Vacuum infused structural inner liner (Fabrics - resin) bonded to the hull
- Injected deck construction in glass fiber and Saerform foam sandwich, covered with non-slip diamond pattern
- Cast iron keel fixed with bolts and stainless steel backing plates
- Twin rudders hung with stainless steel stock
- White coloured hull - Grey metal hull graphics
- 8 Hull portholes

DECK EQUIPMENT

RIGGING

- Anodised aluminum mast, deck stepped with in-mast furling system, 2 Aft swept spreaders
- Anodised aluminum boom
- Discontinuous stainless steel standing rigging
- Split backstay
- Rigid boom vang with tackle
- Self-tacking jib with on-deck furler
- Mainsail stay rope on the roof
- 1 Self-tacking jib track with traveller
- All lines brought back to the helm stations (except boom topping lift and genoa halyard)
- Complete running rigging: Mainsail halyard, Genoa halyard with on-mast tensioner, Boom topping lift with cleat on mast, Mainsheet, 1 Self-tacking jib sheet
- 6 Clutches
- Halyard covers
- 2 Flag halyards

WINCHES

- 1 Self tailing halyard winch (H46.2 STA) at each helm station
- 1 Aluminum Speed Grip winch handle
- 2 Winch handle holders

SAILS (Incidence)

- Furling mainsail Dacron, with UV protection Silver, horizontal cut
- Self-tacking jib Dacron with UV protection Silver, horizontal cut

MOORING LINES - MOORING

- Self-draining chain locker - Clench bolt - Hatch cover
- Single roller stainless steel bow fitting with offset roller
- 12 V - 1 500 W vertical electrical windlass - Remote control
- 6 Aluminum mooring cleats, Length: 400mm / 15³/₄ - Stainless steel chafing plate

SAIL LOCKER

- Access through deck hatch T70, Passage width: 62 cm / 2'
- Stainless steel ladder
- Shelving unit
- Lighting

SAFETY ON DECK

- 1 Open stainless steel pulpit
- 2 Stainless steel pushpits
- 2 Stainless steel handrails on coachroof
- 1 Lifebuoy support bracket
- Welded ring on pushpit for flag
- Double guard lines and stainless steel stanchions, 650mm / 2'2"
- Emergency ladder on pushpit

COCKPIT

- Self-draining cockpit
- 4 Watertight lockers under the cockpit benches
- 1 Locker in cockpit bottom
- 1 Gas compartment under port helmsman seat
- 2 Iro-Deck slatted cockpit benches
- 2 Halyard lockers under the cockpit benches
- Iro-Deck slatted helm seats, with starboard storage locker
- 2 Foldaway helmsman foot chock
- 1 Starboard steering console with electric engine control
- Stainless steel steering wheels (900mm diameter / 2'11") - Anthracite leather covering - Steering gear at the helm station - Steering line transmission system - Stainless steel handrail
- 2 Deck access for emergency tiller
- 1 Emergency tiller
- 1 Steering compass on the port side pedestal
- Starboard engine control panel
- 2 Cockpit tables: fixed legs, folding wooden top with 2 cup holders, central stowage (for the 3 cabin 2 head version)
- 1 Cockpit shower with mixer tap
- 2 Hinged PMMA companionway doors - Sliding hatch made of PMMA
- Liferaft location in front of companionway (Length 900mm / 2'11" x Beam 365mm / 1'2" x Deep 535mm / 1'9")

SWIM PLATFORM / AFT TRANSOM

- Fully opening transom, convertible to bathing platform (2.65m x 0.80m / 8'8" x 2'7")
- Intermediate cockpit access step
- Electrically operated
- Iro-Deck slatted swim deck
- 1 Stainless steel fixed swimming ladder with handrails

INTERIOR

Standard version: 3 cabins 2 heads version

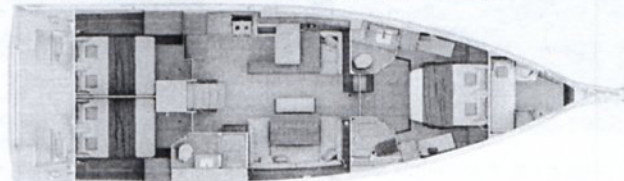

- Sand oak alpi joinery
- Nordic Teak type laminated floorboards
- Interior upholstery: Noah 05 (thickness: 150mm / 6")
- Padded upholstery in the saloon, cabins, at the base of the open upper cupboards in the saloon and galley (Chalk)
- Mattresses in the cabins, HR35kg/m3 foam
- LED indirect lighting
- Pleated blinds on the coachroof windows



BENETEAU

Oceanis 52

Provisional Specifications - Europe

COMPANIONWAY

Headroom: 2,03m / 6'8"

- Wooden saloon companionway with moulded wood suspended steps with non-slip surface
- 2 Écru leather covered stainless steel handrails

SALOON - STARBOARD

Headroom: 2,03m / 6'8"

- U shaped saloon bench (double density foam) - Fusion RA210 with internal/external speakers
- 2 Flexible and adjustable reading light with built-in USB-C socket
- Table in the saloon: solid Alpi wood edges, central stowage
- Lower cupboard on starboard side of companionway for: 12 electrical panel, Navicolor 3.5" screen, Mirror on bulkhead
- Storage under bench seats
- Bottle rack behind the bench against the forward bulkhead
- 2 Hull portholes
- 1 Opening portlight with curtains in the coachroof side window + Mosquito screens
- 3 Opening deck hatches with mosquito screen/blinds

CHART TABLE - PORT

Headroom: 1,97m / 6'6"

- Table with storage- moulded wood fiddle - Laminated covering
- 1 Low-level stowage accessible from the side
- 2 Open high shelves
- 1 Valet tray
- Seat (adjustable to compensate for heel) with backrest
- Stowage under seat with power socket for vacuum cleaner stowage
- 1 Flexible and swivelling reading light
- Bookshelf against forward bulkhead + Bottle stowage with PMMA door
- 1 Hull porthole

GALLEY - PORT

Headroom: 1,96m / 6'5"

- C-shaped galley
- Corian Rain Cloud countertop
- 2 Rectangular stainless steel sinks - 1 Mixer tap with hot/cold water under pressure
- 1 Gas cooker 2 burners - Stainless steel oven on gimbal - Stainless steel protection handrail
- 1 12 V 176 L/46 US Gal fridge, front door, 1 43 L/11 US Gal icebox (for sub-zero storage) with front door
- Fitted lockers and closed shelving
- 2 High shelves with doors, 2 Open high shelves
- 1 Central cupboard with:
 - Sliding double 2 x 27 L/2 x 7 US Gal bin
 - Large lower cupboard with 2 doors, 1 drawer accessible from the saloon
- 1 Stowage for 6 bottles accessible from the worktop (or position for dishwasher option) + 1 Closed upper stowage
- 1 Closed cabinet on worktop for coffee machine (with 230 V socket)
- 1 Lower cabinet: 1 door, 2 drawers
- 1 Lower cabinet: 4 drawers
- 1 Opening portlight with curtains in the coachroof side window + Mosquito screens
- 1 Hull porthole

OWNER'S CABIN

Headroom: 1,99m / 6'6"

- Central double bed Island bed type, mounted on gas struts (2,05m x 1,60m x 1,39m / 6'9" x 5'3" x 4'7")
- 2 Hanger closets, Open storage compartment along the hull, 6 Upper lockers, 1 Storage space under bed (Drawer under the bed + Central stowage under bed)
- 1 Seat on each side of bed
- 2 Bedside tables
- 2 Flexible and adjustable bedside lights with built-in USB-C socket
- 1 Bookcase with 2 bottom drawers and indirect lighting
- Underfloor storage to starboard - Piston-assisted hinges opening mechanism
- 2 Flush deck hatches with mosquito screen/blind
- 2 Hull portholes with sliding blind

2 PRIVATE HEADS:

Headroom: 1,85m / 6'1"

to port:

- Manual toilet
- 1 64 L / 17 US Gal rigid holding tank
- White polyester basin built into the Corian Rain Cloud work top, Mixer tap
- 1 Cabinet - Mirror
- Toilet accessories
- 1 Deck hatch with mosquito screen/blind

To starboard:

- Shower with wooden seat, white polyester shower base
- 2 storage closets
- 1 Deck hatch with mosquito screen/blind

PORT AFT CABIN

Headroom: 1,97m / 6'6"

- Double bed (2,10 x 1,60 m/6'11" x 5'3") with stowage and foot of the bed under the mattress for baggage
- 2 Hanger closets - 1 Cupboard - Closed shelving
- 1 Bed access sideboard
- 2 flexible and multi-directional reading lights at bedhead
- 1 Hull porthole with sliding blind
- 1 Cockpit opening window with curtain under cockpit seats + Mosquito screens
- 1 Opening porthole in the cockpit (on the coaming) + Mosquito screens
- 1 Fixed cockpit window with curtain on the coaming

STARBOARD AFT CABIN

Headroom: 1,97m / 6'6"

- Double bed (2,10 x 1,60 m/6'11" x 5'3") with stowage and foot of the bed under the mattress for baggage
- 1 Hanging locker - 1 Cupboard - Closed shelving
- 1 Bed access sideboard
- 2 flexible and multi-directional reading lights at bedhead
- Access door to aft head
- 1 Hull porthole with sliding blind
- 1 Cockpit opening window with curtain under cockpit seats + Mosquito screens
- 1 Opening porthole in the cockpit (on the coaming) + Mosquito screens
- 1 Fixed cockpit window with curtain on the coaming

AFT HEAD - STARBOARD

Headroom: 1,89m / 6'2"

- Access from the saloon or the starboard aft cabin
- Separate shower - 1 Mixer tap - White polyester shower base
- Corian Clay Cloud work top with self-draining storage
- 1 Manual toilet
- 1 80 L / 21 US Gal rigid holding tank
- Washbasin - 1 Mixer tap
- 1 Cabinet + Mirrors + Storage space under the basin
- Toilet accessories
- 1 Opening portlight with curtains in the coachroof side window + Mosquito screens



BENETEAU

Oceanis 52

Provisional Specifications - Europe

CHARTER VERSION:

- Laos Teak laminated woodwork
- Nordic Teak type laminated floorboards
- Interior upholstery Marlin Brilliant White PVC (thickness: 120mm / 5")
- Padded lining in saloon (Silvertex Aluminium)

5 cabins 3 heads version



Starboard saloon and aft cabins are identical to the 3 cabin version
2 Symmetrical forward cabins with private head
The aft head of the standard version is replaced with a cabin with bunk beds

Large galley with central island unit to port (replaces the chart table and the bookcase)

1 Port side aft head with 2 access

GALLEY - PORT

Large galley with central island unit

- Work top in Clay compact with Corian fiddles
- 2 Rectangular stainless steel sinks - 1 Mixer tap with hot/cold water under pressure - Storage cupboard below
- 1 Gas cooker 2 burners - Stainless steel oven on gimbal - Stainless steel protection handrail
- Cool box 85 L / 22 US Gal top opening
- 1 12 V 176 L/46 US Gal fridge, front door, 1 43 L/11 US Gal icebox (for sub-zero storage) with front door
- 2 High shelves with doors, 2 Open high shelves
- 1 Lower cabinet: 4 drawers
- Lower open stowage space with beading
- 1 Stowage for 6 bottles accessible from the worktop (or position for dishwasher option) + 1 Closed upper stowage
- 1 Central cupboard with:
 - Sliding double 2 x 27 L/2 x 7 US Gal bin
 - Large lower cupboard with 2 doors, 1 drawer accessible from the saloon
- 1 Opening portlight with curtains in the coachroof side window + Mosquito screens
- 1 Hull porthole

2 SYMMETRICAL FORWARD CABINS

Headroom: 1,91m / 6'3"

- Double bed (2,05 x 1,34 x 1,17 m/6'9" x 4'5" x 3'10") with stowage and foot of the bed under the mattress for baggage
- 1 Hanging locker - 2 Closed high shelves, 1 Open shelving
- 2 Swivelling reading lights
- 1 Deck hatch with mosquito screen/blind
- 1 Hull porthole with sliding blind
- Access door to the private head

SIDE CABIN

Headroom: 1,83m / 6'

- 2 Bunk beds:
 - Top bunk (1,95 x 0,79 - 0,54m / 6'5" x 2'7" - 1'9")
 - Bottom bunk (1,93 x 0,60 - 0,43m / 6'4" x 2' - 1'5")
- Storage
- 1 Opening porthole with curtain

2 AFT CABINS

Identical to the standard 3 cabin, 2 head version

AFT HEAD - PORT

Headroom: 1,96m / 6'5"

- Access through saloon and port aft cabin
- Separate shower - 1 Mixer tap - White polyester shower base
- Corian Rain Cloud work top with self-draining storage
- 1 Manual toilet
- 1 80 L / 21 US Gal rigid holding tank
- 1 Sink unit - 1 Mixer tap
- 1 Cabinet + Storage space under the basin
- 2 Mirrors
- Toilet accessories
- 1 Opening portlight with curtains in the coachroof side window

The 5 cabin, 3 head Charter version includes the following as standard:

- 2 Cockpit tables: fixed polyester table top with 2 cup holders, central storage
- Bow stainless steel protection
- Aft transom protection
- Double berth in saloon
- Galley: Sea water/fresh water foot pump
- Fans in the saloon and cabins
- Additional water tanks (2 x 165L / 2 x 44 US Gal) in the saloon
- 1 500 W Electric windlass - LOFRANS, in lieu of standard



BENETEAU

Oceanis 52

Provisional Specifications - Europe

ENGINE

- Engine Yanmar Diesel:
 - 110 HP, Sail Drive, Common Rail
- Engine throttle and control panel on starboard
- Engine compartment: Soundproofing foam - Ventilation: 6 air intakes and 1 forced air outlets
- 1 Alternator 12 V / 125Ah
- 1 Rotomoulded diesel tank 200 L / 53 US Gal (under starboard aft berth) - Electronic gauge - Low level alarm - 1 Deck filler
- Filters: Seawater - Diesel - Water separator
- Foldable three-blade propeller
- 1 Engine access through companionway (opening with 2 gas struts) - 2 Engine access through aft cabins

ELECTRICITY

- 12V circuit
- 5 AGM service batteries (140Ah)
- 1 AGM engine battery (50Ah)
- 1 40 Amperes battery charger
- 1 60 Amperes battery charger
- 1 Power distributor
- Battery charge display (Navicolor 3.5" screen)
- IBS sensor (only for the 3 cabin 2 head version)
- 12 V Electrical panel (Fuses - Voltmeter - Water gauge - Fuel gauge - Battery warning - Fuel warning - Water warning)
- 13 230V Sockets:
 - 3 in galley
 - 3 in the saloon
 - 1 at chart table
 - 3 in the forward cabin
 - 1 in the owner head
 - 1 in the aft cabins
- 6 Dual USB socket (USB-A / USB-C):
 - 1 in the saloon
 - 1 at chart table
 - 2 in the forward cabin
 - 1 in the aft cabins
- 1 Shore power socket (230V)
- LED lighting: Overhead lights - Reading lights - Indirect lighting
- LED navigation lights: 1 Masthead light - 1 Steaming light - 1 Anchor light on masthead - 1 Deck searchlight
- LED cockpit lighting

PLUMBING

- 1 Rotomoulded freshwater tank 380 L / 100 US Gal, under berth in forward cabin - 1 Deck filler
- Pressurised electric water pump - Expansion tank - Inline filter
- 40 L / 11 US Gal Electric water heater (engine use)
- 1 80 L / 21 US Gal rigid holding tank (Aft head)
- 1 64 L / 17 US Gal rigid holding tank (Forward head)
- Electrical shower drain pumps
- 1 Electric bilge pump
- 1 Manual bilge pump
- 1 Electric pump for the ice box drain

GAS

- 1 Box for 2 gas bottles in the cockpit, under port side helmsman's seat (Diameter: 0,28m/ 11" x Height: 0,44m/ 1'5")
- Regulator and safety tap
- Gas leak detector

SMART BOARD

"SEANAPPS" smart technology:

- For monitoring the boat's status and receiving alerts as well as maintenance advice via the associated mobile application.
- The type of information collected (GPS position, batteries, engine info, navigation data, etc.) varies according to the boat's configuration.

seanapps

CONNECT YOUR BOAT FREE YOUR MIND

MISCELLANEOUS ITEMS

- Smoke detector
- Cleaning kit: eco-friendly cleaning products kit



BENETEAU

Oceanis 52

Provisional Specifications - Europe

PACKS

ELECTRONICS PACKS: RAYMARINE

	COASTAL	OFFSHORE
<ul style="list-style-type: none"> • 1 Axiom 2 Pro 9" multi-function touchscreen (GPS, Chart plotter, Chart reader - Navionics® + Blank cartography included), on the starboard console • Port side helm station: 1 i70s display, on deck • Windex Windvane • Wind Sensor (Windvane, Anemometer) • Sensor (Log, Speedometer, Temperature) • P70s autopilot + Starboard helm console control • Chart table: RAY73 VHF, AIS receiver function • Protective cover (Silver): Steering wheel + Starboard console 	<ul style="list-style-type: none"> ▪ ▪ ▪ ▪ ▪ ▪ ▪ 	<ul style="list-style-type: none"> ▪ ▪ ▪ ▪ ▪ ▪ ▪
<ul style="list-style-type: none"> • 1 Steering console to port • 1 Axiom 2 Pro 9" multi-function touchscreen • 1 i70s display, on the starboard console • S100 Wireless autopilot remote control • Induction charging station for smartphones • Protective cover (Silver): Port side console 		<ul style="list-style-type: none"> ▪ ▪ ▪ ▪ ▪ ▪

OFFSHORE UPGRADE PACK

- 2 Axiom + 12" screens replacing the Axiom 2 Pro 9" screens

RIGGING PACKS (Incompatible with First Line Pack)

	DOWNWIND PACK	UPWIND PACK	DOWNWIND + UPWIND PACK
<ul style="list-style-type: none"> • 2 Genoa winches (H 60.2 STA) + 1 Winch handle • Polyester bowsprit with integrated anchoring gear and bobstay (for Code 0 and asymmetric spinnaker) • Asymmetrical spinnaker rigging / Code 0 • German system (Two-way mainsheet at the helm station) + 2 Additional jammers • Genoa sheet track in catwalks (pulls back the traveller on the self-trimming jib rail) + Complete genoa rigging (Genoa sheets, Return pulleys) + 2 Additional jammers • Furling Dacron genoa (to replace the standard self-tacking jib) 	<ul style="list-style-type: none"> ▪ ▪ ▪ ▪ 	<ul style="list-style-type: none"> ▪ ▪ ▪ ▪ 	<ul style="list-style-type: none"> ▪ ▪ ▪ ▪

CLASSICAL MAST PACK

- Classical $\frac{9}{10}$ anodised aluminum mast, 2 Spreaders
- Mainsail semi full batten with sliders (the standard self-tacking jib track remains)
- 2 Additional halyard clutches
- Lazy Jack and Lazy Bag in Silver colour

PERFORMANCE PACK

(Incompatible with mainsail arch option - Not compatible with the shallow draught keel)

Boast supplied without sail (optional extra: Performance Sails)

FIRST LINE ALU PACK

- Performance Classical aluminum mast (Z Diffusion), 3 Aft swept spreaders (+ 1,80m / 5'11") - Track + Main sail ball traveller - Lazy-jacks
- Polyester bowsprit with integrated anchoring gear and bobstay (for Code 0 and asymmetric spinnaker)
- Discontinuous stainless steel standing rigging
- Hydraulic backstay replacing to standard version
- Flatdeck genoa furler
- Performance running rigging, Dyneema (Mainsail, Genoa, Code 0, Asymmetric spinnaker, Halyards)
- German system (Two-way mainsheet at the helm station) + 2 Additional jammers
- 2 Additional halyard clutches
- Genoa sheet tracks on side decks + Complete genoa rigging (Genoa sheets, Return pulleys) + 2 Additional jammers
- Harken winches: 2 Electric H50.2 STAEH rigging winches to replace the winches included in the standard + 2 Manual H60.2 STA genoa sheet winches + 1 Aluminum Speed Grip winch handle
- Black composite Y-shaped steering wheels
- First Line hull decoration (red)



BENETEAU

Oceanis 52

Provisional Specifications - Europe

TENDER PACK

- Retractable davits (Max. tender length: 3,10m / 10'2", Maximum load: 180kg / 397 lbs)
- Electric inflater / deflater
- Outboard engine bracket

ESCAPE PACK (Requires electronic pack)

- Savane Nimbus cockpit upholstery
- Electric legs for 2 cockpit tables with Savane Nimbus mattress for sundeck function
- Tunnel bow thruster
- Bow thruster control on the starboard console
- Windlass control with chain counter on starboard console
- Remote control for opening the swim deck
- Side gate openings

CLOSED COCKPIT PACK - STORAGE

- 1 Aft central seat with storage locker
- 2 Additional lifting aft seats
- 2 access steps to the platform (in place of 1 full width)
- Large aft storage accessible from the platform

CLOSED COCKPIT PACK - GALLEY

- Aft central seat including:
 - 1 Gas plancha
 - 1 30 L drawer fridge
- 2 Additional lifting aft seats
- 2 access steps to the platform (in place of 1 full width)
- Large aft storage accessible from the platform

ELEGANCE PACK (for the 3 cabin 2 head version)

- Wooden Venetian blinds on the 4 hull portholes of the saloon
- Sunbrella Natté Natural padded headboard in the forward cabin
- Smoked mirror at the back of the saloon bookcase
- Saloon table with electronic legs and table top that transforms into saloon table version or lounge space (upholstery optional)
- Artesian covering on forward cabin bedside tables, companionway cupboards, top of chart table, bookcase

OPTIONS

NAVIGATION ELECTRONICS: RAYMARINE

- 700 AIS
- Quantum Doppler radar
- RAY90 wireless VHF handset

RIGGING - SAILS

- Performance mainsail and genoa (First Line Pack / Incidence, Palma-Tec): Silver colour UV protection band, Silver colour Lazy bag, Full batten mainsail
- Mainsail Palma-Tec semi full-batten tri-radial cut for classic mast 2 spreaders
- Palma-Tec tri-radial cut mainsail for in-mast furling
- Palma-Tec self-tacking jib on furler, tri-radial cut, in lieu of standard (Compatible with traditional mast and mast with in-mast furling, Incompatible with First Line Pack)
- Palma-Tec furling genoa (105%), tri-radial cut, Silver colour UV protection band, replacing the Dacron self-tacking jib (Compatible with traditional mast and mast with in-mast furling, Incompatible with First Line Pack)
- Code 0 with "Top Down" furling system (Incompatible with First Line Pack)
- GRP mainsail arch with 2 Stand-up mainsheet blocks (Incompatible with First Line Pack)
- Self-tacking staysail rigging (Halyard sheave with block + Releasable forestay chainplate + 1 Self-tacking staysail sheet)

WINCHES

- 1 Port electric primary winch - H50.2 STAEH, in lieu of standard (Incompatible with First Line Pack)
- 1 Starboard electric primary winch - H50.2 STAEH (Incompatible with First Line Pack)
- 2 Electric genoa winches - H60.2 STAEH (Requires a rigging or First Line pack)



BENETEAU

Oceanis 52

Provisional Specifications - Europe

HULL - DECK - COCKPIT

- Pearl grey gel-coat
- Iro-Deck slatted cockpit floor
- Iro-Deck slatted side decks
- Iro-Deck slatted on companionway sunbeds
- Central wood extension for the 2 cockpit tables (3-cabin layout)
- Polyester central extension for the 2 cockpit tables (5-cabin layout)
- Savane Nimbus aft cockpit upholstery (for closed cockpit pack)
- 2 Companionway sunbeds with tilting backrests and built-in cup holder, Savane Nimbus
- Helmsman upholstery: seat and backrest, Savane Nimbus
- 4 folding blades propeller
- White or black composite steering wheels (Incompatible with First Line Pack)
- Outboard engine bracket (Not available with Pack Tender)
- Shore fresh water supply
- Fresh/sea water pump for deck cleaning
- Solar panels on the coachroof (430 W)
- Solar panels for fixed bimini top (680 W) - Compatible with solar panels on the roof

MOORING LINES - MOORING

- Mooring kit:
 - Delta 25 kg/55 lbs anchor (galvanized steel)
 - Chain (Diameter: 12mm / 1/2" - Length: 40m / 131')
 - Line (Diameter: 22mm / 7/8" - Length: 50m / 164')
 - 6 Fenders:
 - 2 L (Diameter: 250mm / 10" - Length: 700mm / 2'4")
 - 4 XL (Diameter: 300mm / 12" - Length: 880mm / 2'11")
 - 4 Moorings lines (Diameter: 18mm / 11/16" - Length: 15m / 49')
 - Anchor positioner
- Aft fairleads (Aluminium mooring cleats on transom)

OUTSIDE PROTECTIONS

- Silver coachroof sprayhood, Windows in Strataglass (2 Versions: with and without mainsail arch)
- Folding cockpit bimini top with sunshades and LED lighting, Windows in Strataglass, Silver (2 Versions: with and without mainsail arch) - sprayhood option required
- Fixed cockpit bimini with sunshades and LED lighting, Silver - sprayhood option required
- Folding bimini for helm stations, Silver + Aft sunshade, LED lighting on battery (Requires the cockpit bimini top option)
- Sunshade on foredeck, Silver
- Sunshade for the cockpit, Silver
- Cockpit table covers, Silver

INTERIOR EQUIPMENT

LAYOUT VERSIONS

- 5 cabin 3 head charter version
- Forepeak cabin (In place of the sail locker):
 - Access through T70 deck hatch, Passage width: 62 cm/2' - Stainless steel ladder
 - Headroom: 1,80m / 5'11", beneath deck hatch
 - 1 Bed (2m x 0,66m / 6'7" x 2'2") Foam mattress - PVC cover
 - 2 Storage lockers, Under the bed - Cupboard and shelves
 - Manual toilet + Rigid holding tank (50L / 13 US Gal) - Washbasin - Mirror - Shower head mixer tap - Shower tray with curtain
 - 1 LED ceiling light, 1 LED reading light
 - 1 Fan, 1 230 V socket

AMBIANCE

- Brown oak laminated floors (3 cabins 2 heads version)
- Interior upholstery, according to swatches
- Upholstery padding (Saloon, Cabins, Bottom of open cupboards in the saloon and galley): Glacier or Rock
- Lounge upholstery for Elegance pack (cushion for low table) matching boat upholstery (3 cabins 2 heads version)
- Double berth in the saloon (short legs, Brilliant White PVC mattress) (3 cabins 2 heads version) - Incompatible with Elegance Pack
- 2 Mirrors in the saloon on the forward bulkhead (not compatible with the TV pre-fitting option in the saloon of the 3 cabin, 2 head version)
- Pleated blinds on the saloon portholes (Incompatible with Elegance Pack)

MULTIMEDIA

- TV pre-fitting on forward bulkhead in the saloon *
- Fusion Signature speaker upgrade in the saloon
- * Not including antenna and wiring in mast

DOMESTIC APPLIANCES

- Dishwasher for 6 sets
- 20L microwave oven
- Stainless steel cooker 3 burner oven/grill on gimbal
- Additional fridge (130L / 34 US Gal) for the 3 cabin 2 head version - not compatible with the washer-dryer option
- Washer dryer (8-5kg / 18-11 lbs / 230V)

ON BOARD COMFORT EQUIPMENT

- Berth in saloon (3 cabins 2 heads version)
- Electronic safe
- Premium mattress (great comfort with memory foam layer) for forward cabin (3 cabins 2 heads version)
- Premium mattress (great comfort with memory foam layer) for aft cabin (3 cabins 2 heads version)
- Additional water tanks (2 x 150L / 2 x 40 US Gal), in the saloon (3 cabins 2 heads version)
- Extra diesel tanks (200L / 53 US Gal), under starboard aft berth
- 9 kVA Generator (230V / 50Hz) Fischer Panda
- Watermaker (60 l/h / 16 US Gal/h)
- Water purifier (UV filtration for the cold water tap in the galley)
- 36 000 BTU air conditioning full boat (only for use via shore power supply), for the 3 cabins version (40 000 BTU, for the 5 cabins version) + Shore socket extension cord 15m / 49'3"
- Forced air heating fuel
- 12/230 V, 2 kVA inverter
- Quiet flush electric toilets - Fresh water/Seawater
- Electric seawater/fresh water foot pump (Galley)
- Fans in the saloon and cabins (3 cabins 2 heads version)
- Tableware kit - 6 people