

GENERAL DIMENSIONS.

Sails shall be made and measured in accordance with the current IYRU sail measurement rules.

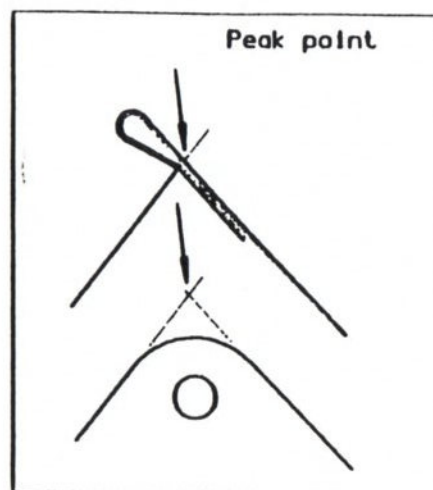

Corner measurement points

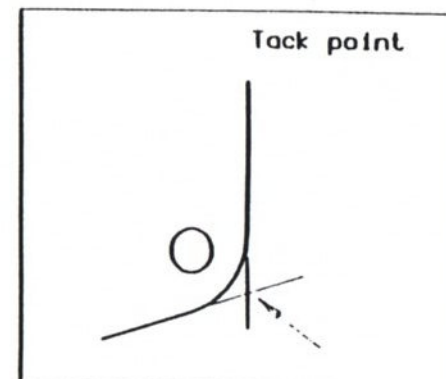
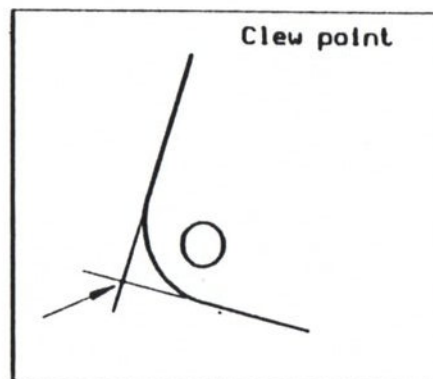
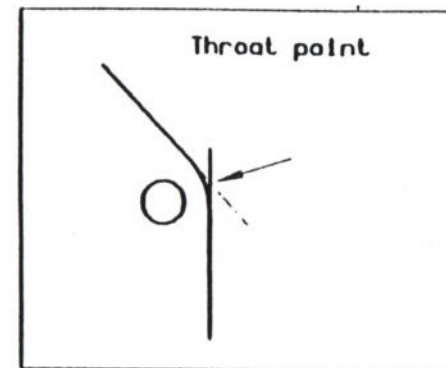

INTERNATIONAL OPTIMIST.

Sail plan sheet: 1/5

Date: March 1994

THIS PLAN SHALL BE READ IN CONJUNCTION WITH THE LATEST CLASS RULES.

© 1994 INTERNATIONAL YACHT RACING UNION

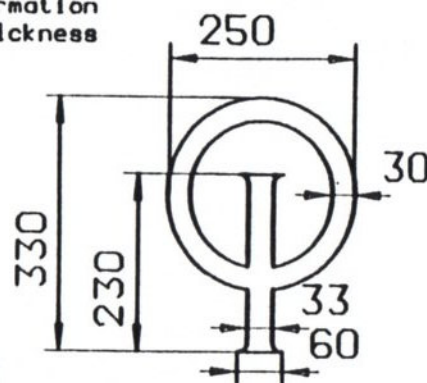
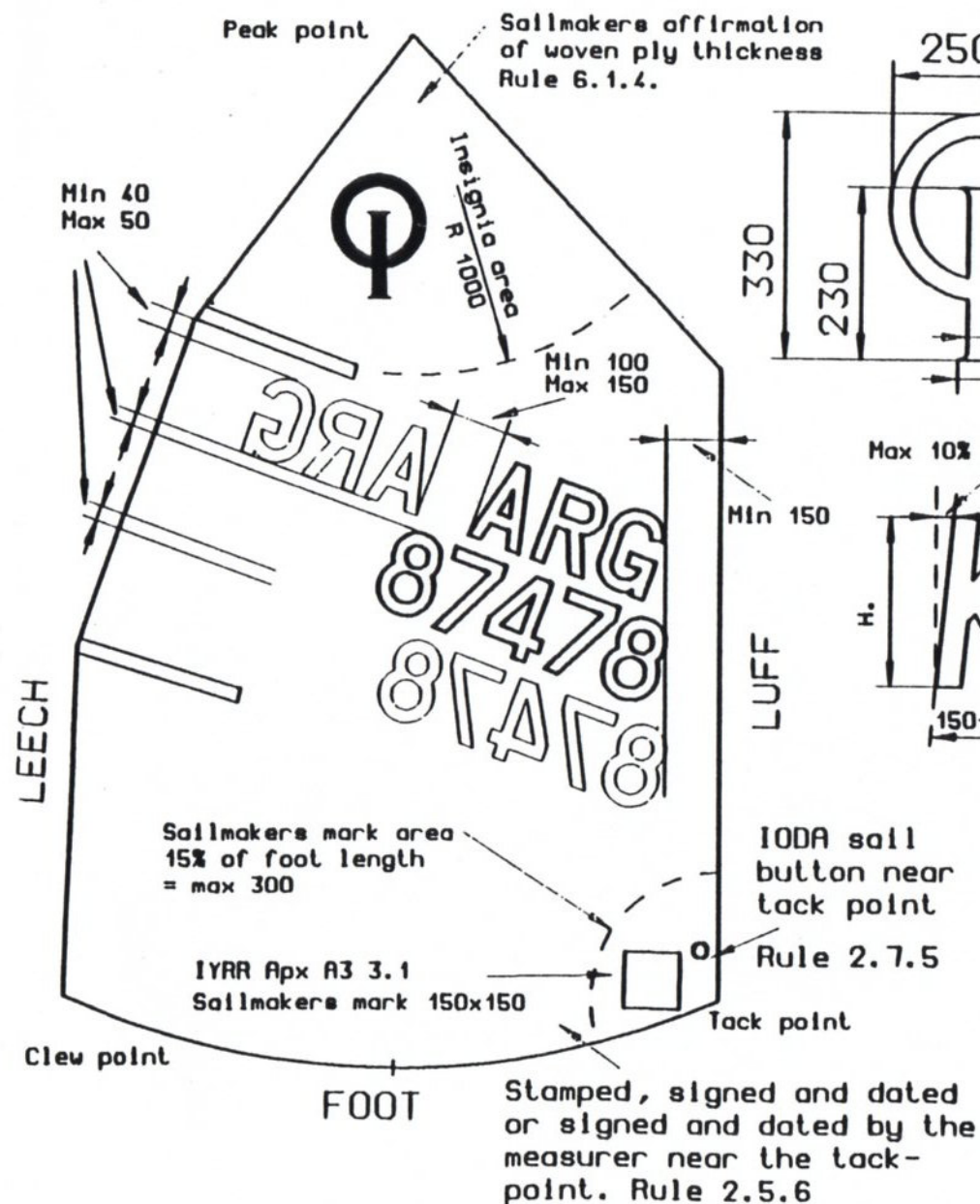

Minimum dimensions of insignia.

Dimensions of letters & numbers.

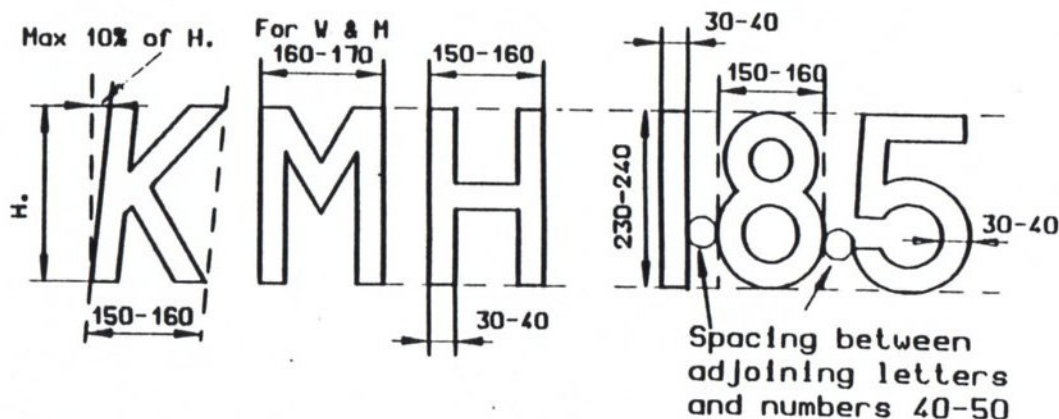

LETTERS AND NUMBERS SHALL BE:
clearly visible, legible, of a single style and a single color that strongly contrasts with the sail. Capital letters and arabic numerals with lines that are continuous and without serifs.
See also IYRR Apx B3 1.2

SAILNUMBERS INSIGNIA & BUTTONS. Rule 6.5.

| | | | |
|---|----------------------|---|--|
| INTERNATIONAL OPTIMIST. | Sail plan sheet: 4/5 | Date: March 1994 | |
| THIS PLAN SHALL BE READ IN CONJUNCTION WITH THE LATEST CLASS RULES. | | © 1994 INTERNATIONAL YACHT RACING UNION | |