

Pearson 37

37'

The new Pearson 37 is something quite exciting in yacht design. It represents a quantum leap forward in the level of comfort and ease of handling that today's cruising sailor can expect.

Here is a 37-footer that is a pure joy for two people to cruise due to her clean deck layout, fully battened mainsail, and optional self-tacking jib, but that is only half the story. Imagine a sailboat that is a pleasure to go below on. The 37's interior is bright and inviting with colored fabrics and plush carpeting throughout. The owner's stateroom is forward with an easily accessible island-type double berth. The main saloon is spacious and homey; it includes a standard entertainment center with a color tv, video cassette player, and complete four-speaker stereo system. There are even swivel chairs to sit in and the L-shaped dinette con-

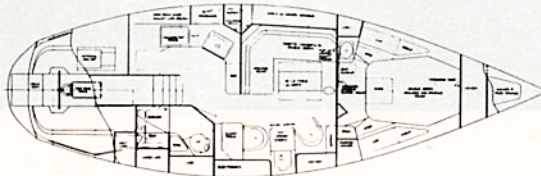
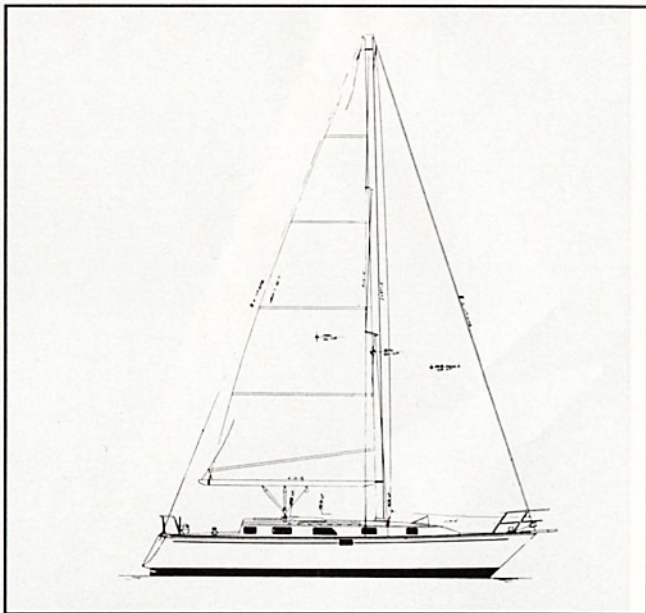

verts to another large double berth for guests.

The galley is nicer than most kitchens with its spacious icebox, electric stove, microwave oven, and minibar. Opposite the galley aft is a roomy head with separate stall shower.

The Pearson 37 is for the boating enthusiast looking for a whole new level of comfort in a quality sailing yacht.

L.O.A.....	37' 5"
L.W.L.....	29' 7"
Beam.....	12' 4"
Draft.....	4' 8"
Ballast.....	6,000 lbs.
Displacement.....	16,000 lbs.
Sail Area.....	665 sq. ft.
No. of Berths.....	4-5
Auxiliary 30 H.P. Yanmar Diesel Designer.....	Shaw, Richards, & Pearson Team

Pearson Yachts Corp.
West Shore Road
Portsmouth, RI 02871
(401) 683-0100