



SABRE YACHTS

SAILMAKER FACT SHEET FOR SABRE 34 - SERIES II

October, 1985

NOTE: See separate fact sheet for Sabre 34 - Series I
Hull Numbers 001 - 255
Hull No. 256 has special rig

Sabre 34 - Series II Basic Rig Dimensions:

Hull Nos. 257 to present:

P = 39.14'	I = 44.71'
E = 11.92'	J = 13.75'

Mainsail Data:

- | | |
|-------------------------|---|
| 1. Main mast track: | - ½" I.D. groove - use Aquabatten #A017 3/8" slugs for best results |
| 2. Main boom track: | - #6 Metalmast flat internal slides |
| 3. Headboard shackle: | - Schaefer #93-45 |
| 4. Main tack shackle: | - Jaw opening 1", distance below pin 1", pin diameter ½" |
| 5. Set-back of tack: | - 2¼" from aft face of mast |
| 6. Set-up of tack: | - 1½" above top of boom track |
| 7. Clew outhaul: | - Schaefer #95-55 car, set up 2" |
| 8. Luff slide stop: | - Fitted 4½" above black band |
| 9. Gooseneck: | - Fixed |
| 10. Mast circumference | - 1' 6-1/8" |
| 11. Boom circumference | - 1' - 1½" |
| 12. Jiffy reefing: | - Two sets of jiffy reefing hardware are provided standard with each boat. Use external rings for reef tacks. |
| 13. Reef hook set-back: | - 2¼" from aft face of mast |

Headsail Data:

- | | |
|---|---|
| 1. Headstay diameter: | - 9/32" wire standard, -10 rod optional |
| 2. Headstay length: | - Hull Nos. 257 to present: 46'-6" |
| (pin to pin including turnbuckle 2/3 open) | |
| 3. Maximum headsail luff length (does not allow for stretch): | - 45' 9" |
| 4. Turnbuckle length extended: | - 1' 7" |
| 5. Halyard shackle: | - Schaefer #45-05 |
| 6. Tack shackle: | - Nicro Fico NF 11000 P |
| 7. Set back of tack: | - 1½" aft of headstay |
| 8. Genoa tracks:
(1½" x 3/16" T-track) | - 12' 0" inboard and toerail tracks with after ends 6'-3" forward of transom corner.
(See Series II sail plan) |

NOTE: All genoas must be cut to lead within the track lengths indicated on the sail plan. This permits use of the required genoa sheet turning blocks and other standard hardware.

SABRE 34 II SPECIFICATIONS

LOA	34' 2"
LWL	28' 3"
Beam	11' 2"
Draft	
Keel	6' 0"
Centerboard - up	4' 0"
Centerboard - down	7' 8"
Displacement	
Keel	11,500 lbs.
Centerboard	11,900 lbs.
Ballast	
Keel	4,600 lbs.
Centerboard	4,900 lbs.
Total Sail Area	540 sq. ft.
Rig Dim: P	39.39'
E	11.92'
I	44.38'
J	13.75'
Cockpit Length	7' 2"
Headroom	6' 3"
Mast Ht. from W.L.	49' 3"
Westerbeke Aux.	27
Cylinders	4
Fresh Water Cooled	Yes
Self-Bleeding	Yes
Fuel Tank	20 gal.
Water Tanks	76 gal.
Holding Tanks	30 gal.
Batteries - #/Amps	2/100
Berths - #/Size	7/6' 4"
Winch size - Main Halyard	16c
Jib Halyard	16c
Main Sheet	16c
Primary	42c
Secondary	30c
Spinnaker Halyard	16c
Hatches	3
Dorades	4
Opening Ports	2
Hull Speed	7.1 knots

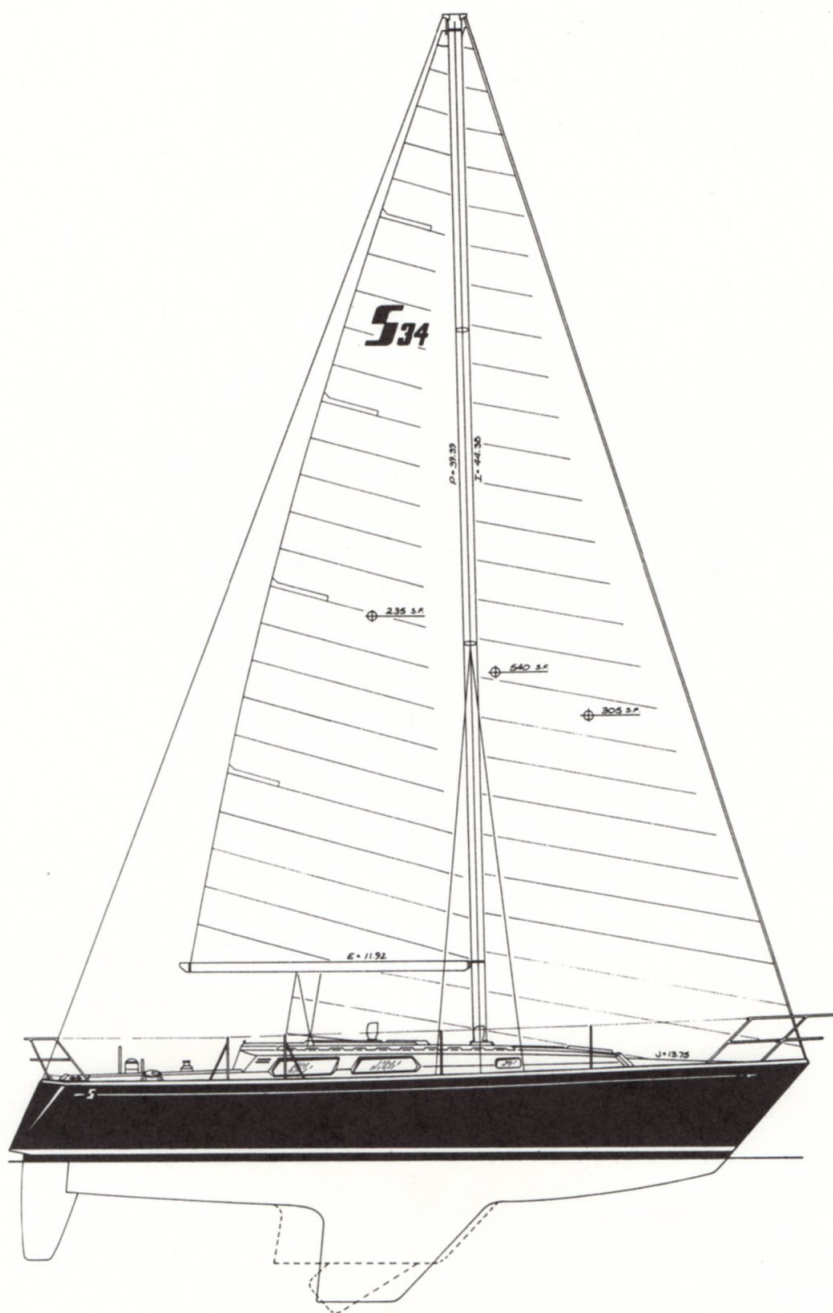

SABRE 34 II SAIL PLAN

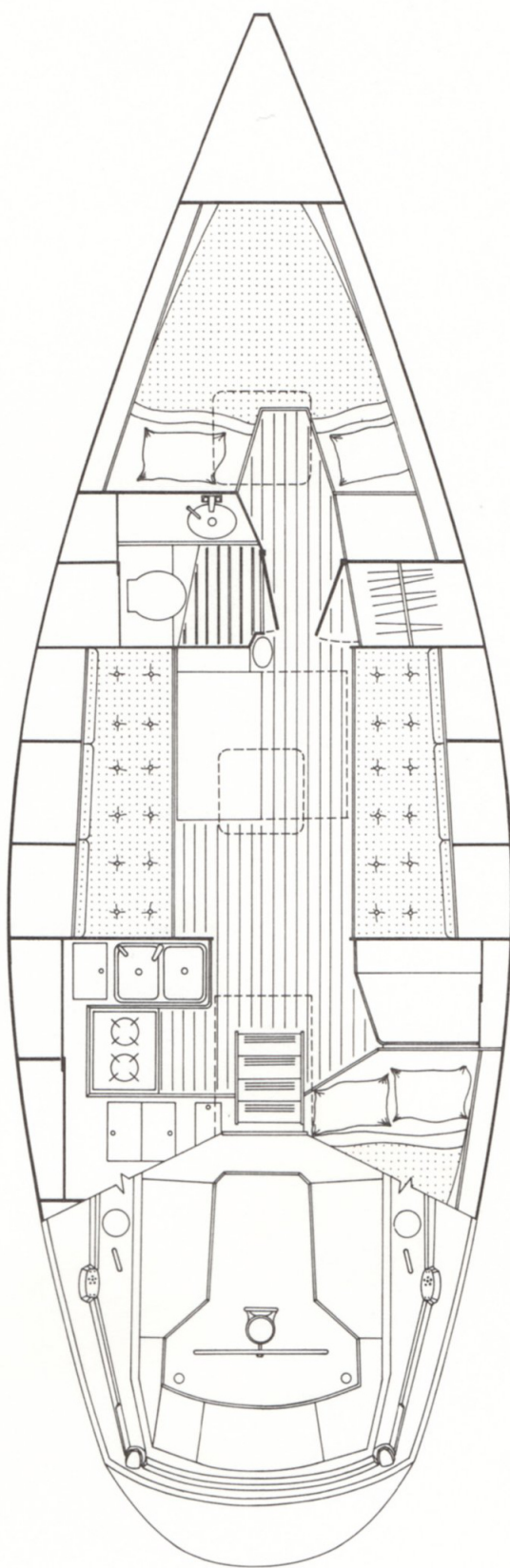
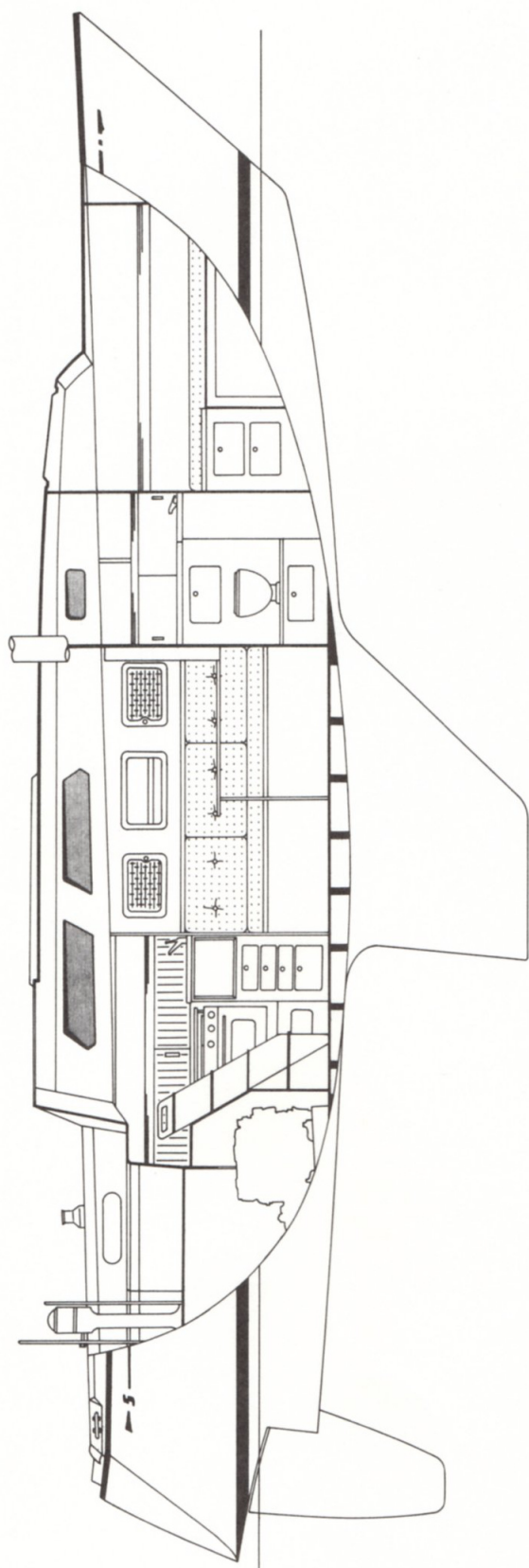

SABRE 34 II INTERIOR PLAN

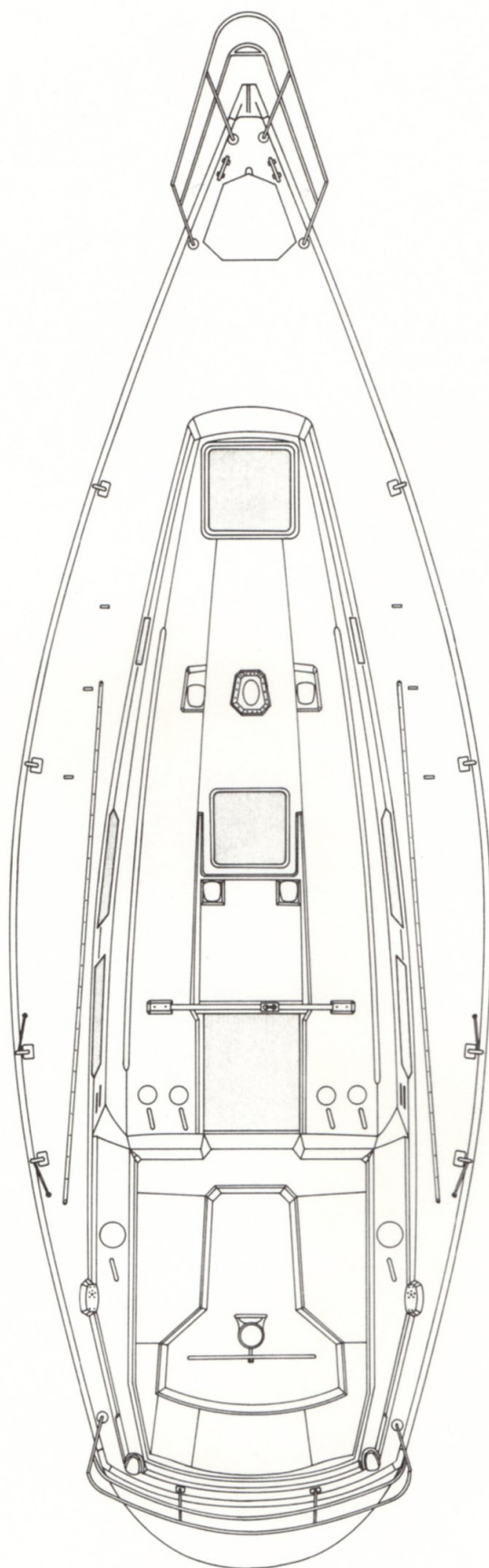

SABRE 34 II DECK PLAN