

THE FACTS YOU WANT TO KNOW ABOUT...

# SEAFARER 34

**Shoal draft that goes anywhere comfortably... advanced design that gets there first!**

**SLOOP RIG**  
S.A. 529 sq. ft.



**YAWL RIG**  
S.A. 578 sq. ft.



A high performance design from McCurdy & Rhodes. Aerfoil centerboard and aerfoil fin-and-rudder combination plus low wetted surface hull sections contribute to superior speed. "T" cockpit and SeaFlair™ spray rail will appeal to the racing man. Yet she is ideal for cruising with her truly spacious, comfortable interior and shoal draft. The Seafarer-34 is a yacht that will appeal to all members of the family and be a proud possession for years to come.

33'9" x 24'1½" x 10'0" x 3'9" (c/b up). DESIGNER McCurdy & Rhodes. DISPLACEMENT 12,300 lbs. BALLAST 4,800 lbs. lead. SAIL AREA 529 sq. ft. (sloop) 578 sq. ft. (yawl). POWER gas or diesel. I.O.R. RATING 23.0 (est.) HEADROOM 6'3½". BERTHS 4-5-6 plus convertible dinette (6-7-8 total). VERTICAL CLEARANCE 44'6": HULL LAMINATE alternating layers 1½ oz. mat and 24 oz. woven roving fiberglass, maximum 14 layers on centerline, 7/8" thickness.





**Newest and finest keel centerboarder in her size range. Every element of her design and specification was chosen to make no compromise with quality.**

*Choose the plan that suits you best . . .*

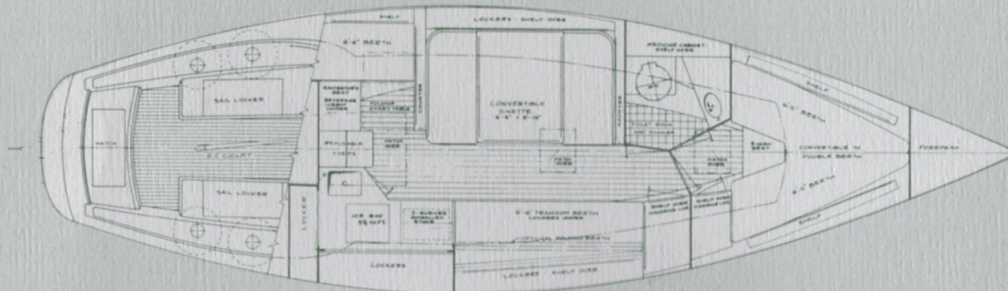

**Interior Option #1.** You can race or cruise anywhere in the Seafarer 34 . . . comfortably. This plan provides 6 berths, including the convertible dinette. There are 2 additional optional folding berths to port and starboard in the main cabin. The hull outboard of all berths is double panelled to provide an attractive appearance and effective insulation. Excellent ventilation is provided by a transparent topped amidships hatches over the main and forward cabins and by all-weather Dorade ventilators to port over the toilet room and to starboard over the main cabin. The huge cockpit is 8'3" long. The cockpit seats are deep with high backrests for all-day sailing comfort and all-weather protection. The cockpit coamings incorporate a wraparound spray rail forward. There are lockers under the coamings accessible from the cockpit and three large lockers under the cockpit seats.

**\$17,850**

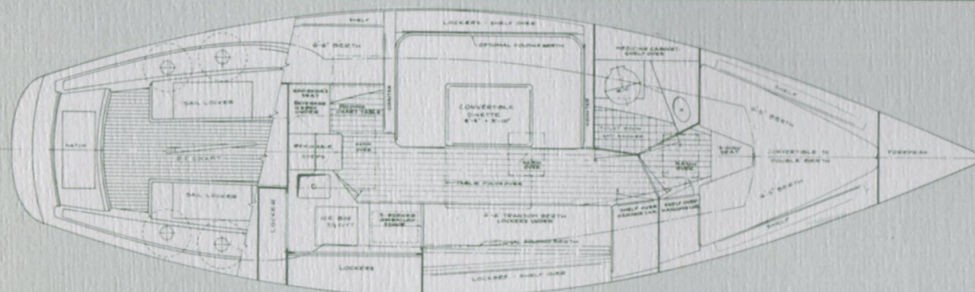

**Interior Option #2.** The table arrangement in the main cabin is altered to a U-shaped layout. This makes the most of the spacious main cabin and, with the optional fold-over table top, provided comfortable seating for 6 around the table. As in the other plans there are very useful lockers and shelves port and starboard flanking the main cabin. There are also lockers under the berths to make the most of all available storage space. A toilet-shower-dressing room has separate entry doors from the main cabin and forward stateroom. Another door provides access to the forward cabin.

**\$17,950**

## STANDARD SPECIFICATION

**Construction** Solid, one-piece fiberglass construction using high tensile wover roving engineered for stress distribution, impact resistance and flexural strength. Entire hull, deck and complete interior accommodation structure of reinforced fiberglass, Unit-Bonded™ into a monocoque structure permanent strength. Hull molded with an integral fiberglass "back-bone" to resist bending of race-taut head/back stays. Sandwich construction deck using end grain balsa core for lightness and maximum stiffness. Deck structurally laminated to hull. Fiberglass overhead liner for smooth appearance and effective insulation. Seafarer easy clean non-skid pattern on all walked-on surfaces. Dorade vent boxes, wide cockpit coamings and SeaFlair™ wraparound spray rail molded integrally with deck. Recessed cove stripe. ColorSpectrum™ choice of unlimited cove stripe and boot top colors.

**Ballast** 4,800 lbs. cast lead, custom cast and individually weighed by Seafarer, structurally laminated to hull.

**Centerboard Trunk and Centerboard** Fiberglass centerboard trunk integral with hull. Hydrodynamically streamlined, reinforced fiberglass centerboard. Stainless steel pennant tube. Centerboard is winch operated.

**Rig** Modern, powerful masthead rig. Sloop rig standard, yawl rig optional.

**Chainplate and Tracks** Chainplates 1/2" polished type 304 stainless steel through bolted to hull. Genoa tracks and traveller track, if installed, hard anodised 6061-76 aluminum alloy with stainless steel bolts.

**Deck Fittings** Solid bronze and stainless steel throughout. No chrome plate or aluminum alloys. Two 10" bow cleats, two 8" stern cleats, two 8" jib sheet cleats, two working jib sheet blocks on bronze deck eyes, main sheet block. Two Dorade ventilators on cabin top. All hardware through-bolted.

**Joinerwork** Yacht quality joinerwork in selected Burma teak throughout. Teak toerails, taffrail, cabin top trim, hatch trim and hand rails. Lockers under winch bases accessible from cockpit. All exterior teak parts joined to deck with stainless steel fastenings. Sea-Luxe™ interior bulkheads, cabin doors, locker doors, drawer fronts, counter and shelf rims, hand rails, etc, in teak grain with wood surfaces protected by vinyl locked to wood with heat and pressure. Interiors of all lockers insulated from hull and isolated from dirt and damp by mirror smooth fiberglass liners. Dinette table, galley counter, chart table and bureau tops teak grain with teak rims. Stowage traps, lockers and drawers under berths. Interior joiner hardware chrome plated.

**Upholstery** Unlimited choice of Herculon ScotchGuard tweed upholstery for the berths. Berth cushions and dinette seat backs are polyfoam and the covers have zippers. Dinette fill cushion and double berth conversion cushion for the forward cabin are standard.

**Hatches and Ports** Reinforced fiberglass main companion hatch sliding on aluminum tracks. Aluminum forward and amidships hatches with rubber compression gasket, cam lock and opening adjuster. Teak grain closure boards on main entry. Aluminum entry sill strip. Three large, well-scuppered sail locker hatches in cockpit. ABS rim plexiglass ports. All cabin hatches lockable.

**Spars and Rigging** Mast, boom and spreaders 6061-T6 aluminum—the strongest most weather resistant alloy available—custom made in our own shops. All mast fittings, including masthead, type 304 stainless steel. Heavy duty crank roller reefing gooseneck on boom. Standing rigging 1/4" 1 x 19 stainless steel, custom swaged by Seafarer. Turnbuckles 1/2" forged bronze open type with positive lock. Halyards 5/32" 7 x 19 stainless steel, with Da-



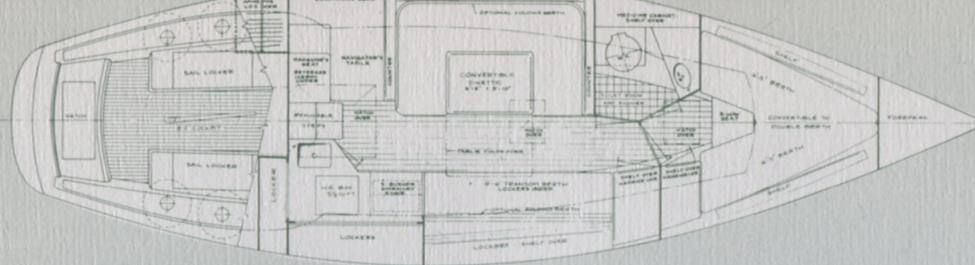

**Interior Option #3.** This layout adds a fixed chart table aft to port with an additional hanging locker aft of that. There is a large shelf for navigation gear outboard of the chart table. A top opening icebox is located to starboard aft of the stove. 8 feet of lockers with sliding doors surround the galley which is L-shaped and located so that it is convenient to both the cockpit and the dinette. More lockers are under the galley. The sink is close to the centerline where it will drain quickly on all points of sailing. An entirely separate icebox for beverages is located to port of the companion steps.

**\$18,050**

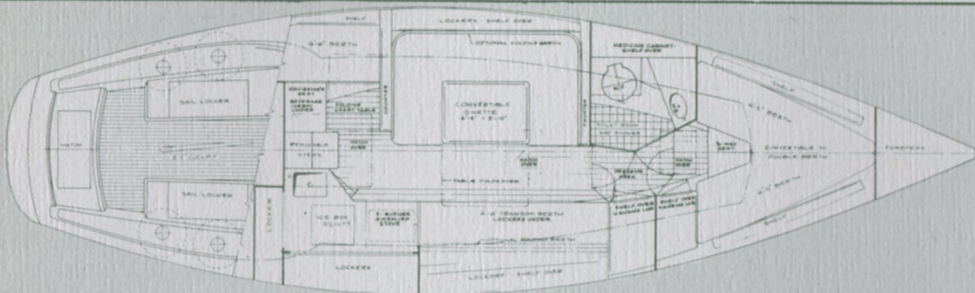

**Interior Option #4.** A re-arrangement of doors makes possible enlargement of the toilet room to provide a private dressing room/toilet room combination, located between the cabin. A hanging locker is included within the dressing room. Yet, provision is made so that there is a passage between the cabins when the toilet room only is required. As in the other plans, the forward cabin includes a hanging locker, 2 single berths which convert to a huge double berth by raising a center seat to berth height position, lockers under the berths and shelves port and starboard over the berths.

**\$18,500**

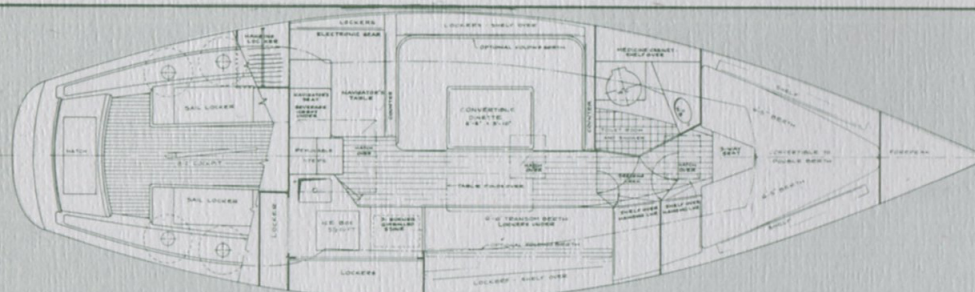

**Interior Option #5.** This plan combines the fixed chart table/extra hanging locker features of the #3 interior with the toilet room/dressing room arrangements of the #4 layout. The toilet room is equipped with a teak grating, a horizontal 30" long medicine cabinet with sliding doors outboard and a shelf over the medicine cabinet. The entire toilet room structure is one-piece, easy-clean fiberglass. All berths are well over 6' long. Headroom in the main cabin is 6'2" yet the cabin trunk is low and sleek. The helmsman has excellent visibility over the cabin trunk from the cockpit.

**\$18,600**

iron tails. Dacron mainsheet, jib sheet, boom lift, outhaul and downhaul with all necessary blocks. Flag halyard to masthead. Blocks maintenance-free lightweight black anodized aluminum or stainless steel.

**Rudder and Tiller** "Intrepid" type rudder of reinforced fiberglass—will never rot, split or warp. Stainless steel rudder post and bronze top bearing. Stainless steel heel fitting weldment. Custom bronze hinged tiller fitting. Tiller beautifully laminated in woods of contrasting color. All underwater parts carefully faired to minimize drag. Wheel steering optional.

**Plumbing** Quick-action bronze seacocks on all below line openings. All hose clamps stainless steel. Heavy braided outlet and cockpit scupper hoses. Installed marine toilet. Water tank 60 gallons under the cabin sole and directly above the ballast where its weight is located for best advantage. Fresh water piping clear plastic throughout. Automatic water pressure system to faucets in galley and toilet room. Stainless steel sink in galley. Wash basin in toilet room integral with fiberglass vanity top. Shower sump integrally molded under toilet room sole which is fitted with a teak grating. Top loading 150 lb. galley icebox with drain. Navy type bilge pump. Cockpit self-bailing through large diameter scuppers.

**Electric System** Starting system is 12v. The engine has a 35 amp alternator which charges a 96 amp heavy duty battery. Switches and fuses for each circuit. All cabin lights have individual switches. International navigation lights are installed: Port and starboard running lights, stern light, bow light and 360° masthead light, 6 interior lights.

**Auxiliary Power** Universal Atomic 4 or Palmer M-60 engine located in accessible position under entry steps. Water cooled exhaust. Bronze shaft fitted with narrow 2 blade propeller (Martec folding propeller optional). Rubber Cutless stern bearing and self aligning stuffing box. Fuel tank 20 gallons (optional larger capacity). Morse engine controls. Instrument panel accessible from cockpit. Engine compartment ventilation in accordance with Coast Guard requirements.

**PURCHASE CONTRACT** The Seafarer purchase contract requires a 15% down payment (for contract totals over \$20,000), 15% when hull is molded, 15% when entire fiberglass structure is assembled, and 45% when the yacht is completed as notified by Seafarer. As purchaser you are requested, if at all possible, to visit the Seafarer plant at time of completion to personally inspect your yacht. The final 10% is due on delivery, at delivery point specified in contract. Moorings are available in Huntington harbor at no charge for 10 days after delivery for owners taking sailaway delivery. Financing can be arranged at low bank rates for up to 7 years and up to 85% of contract price.

**DELIVERY** All prices are f.o.b. Huntington, N.Y. plant. Sailaway delivery includes launching, rigging, delivery sailaway at Seafarer mooring in Huntington harbor. For overland delivery, Seafarer maintains a fleet of trucks and trailers which operate anywhere in the continental United States. Rates include complete insurance up to delivery. If no crane is available at destination Seafarer can off load using trailer mounted equipment. Overseas delivery can be arranged to any destination world-wide through the Port of New York. Also available: Welded steel shipping and storage cradle; Botton preparation and painting in your choice of Woolsey Vinelast colors.

**WARRANTY** The Seafarer warranty is for 2 years on the fiberglass structure and for six months on other parts. Any warranty problem can be notified to Seafarer by telephone, or otherwise. Repair authorization, if appropriate, is prompt.



# Visit Seafarer and "Custom Plan" Your New Seafarer-34 ...

As the purchaser of a new Seafarer yacht, you have a special invitation to visit our shop. We will be glad to help you plan all details to your exact requirements. Experience has shown that installing custom equipment during construction will save you time and expense in the long run. You also keep your entire yacht covered under one warranty and secure delivery of all equipment at one time. *On this page is a listing of some of the most popular options for the Seafarer 34. Your Seafarer will be built exactly the way you specify.*

**STANDARD EQUIPMENT . . .** Standard specification includes all equipment necessary to sail boat, excluding sails. Unit-Bonded™ double strength fiberglass construction • Fiberglass hull and deck • One-piece molded fiberglass headliner • Interior accommodation structure in one unit of reinforced fiberglass (in effect a second hull) permanently bonded to the hull itself • Recessed cove stripe in hull • Custom made teak toerails, taffrail, hand rails, cabin top trim, and entry trim • All exterior joinerwork teak • Sea-Luxe™ teak grain divider bulkheads, forward cabin and two toilet room doors and interior trim • Complete deck hardware, solid seagoing bronze and stainless steel • Large reinforced fiberglass sliding main hatch, lockable • Aluminum forward and amidships hatches with transparent tops, lock from inside • Laminated tiller of contrasting color woods for strength and beauty • 6061-T6 aluminum mast, boom and spreaders • Heavy duty worm drive crank operated roller reefing • Complete Dacron running rigging • Halyards stainless steel with Dacron tails • Complete stainless steel standing rigging • Forged bronze open turnbuckles • Stainless steel chainplates • Exclusive design rimless portlights recessed into cabin trunk, 8 total • Solid teak hand rails on cabin top • Lockers under sheet winch bases • Three teak hatches over cockpit seat lockers • Cast lead ballast 4,800 lbs. • Quick action bronze seacocks on all below line through-hull fittings • Navy type bilge pump • Two Dorade water trap vents on cabin top • Automatic pressure water system to latest design single lever faucets at galley and in toilet room • Complete toilet room fixtures • Forward stateroom berths convertible to double berths (optional) • Teak grain galley counter and dinette table • Top opening icebox, 75 lb. capacity • Teak grating in toilet room • Complete lighting system including navigation lights and 6 cabin fixtures • Masthead light • Universal Atomic 4 or Palmer M-60 engine installation (diesel optional).

**YOUR CHOICE OF SAILS . . .** Choose your sails according to the use to which you will put your boat. Either standard or specially designed sails are available, from leading U.S. sail makers, or imported. The following is a basic list for the sloop rig:

Mainsail (252 sq. ft. ft.) 7 oz. Dacron  
Working jib (233 sq. ft.) 7 oz. Dacron  
#1 Genoa (415 sq. ft.) 3.8 oz. Dacron (150%)  
#3 Genoa (295 sq. ft.) 7 oz. Dacron  
Spinnaker (996 sq. ft.) 1.2 oz. Nylon  
Mainsail cover Dacron

**YOUR CHOICE OF AUXILIARY POWER** Volvo MD-2 diesel engine 54 cu. in., 1.9:1 reduction, installed (instead of standard gasoline engine)

**YOUR CHOICE OF RIG AND STEERING SYSTEM . . .** Yawl rig aluminum mizzen spars, manual roller reefing on mizzen boom, mizzen standing and running rigging, stainless steel mizzen chainplates, modified main boom and divided main backstay, installed Jib boom and rigging for club foot jib aluminum jib boom with quick release fitting, chocks to stow boom against rail, necessary blocks and rigging Roller furling jib Merriman #2 furling gear, 3/8" 7 x 19 stainless steel halyard, installed Wheel steering pedestal mounted, 23" stainless steel Destroyer wheel, including emergency tiller.

**YOUR CHOICE OF RACING EQUIPMENT . . .** Jib sheet winches Merriman #3 top action ratchet, pair, installed, including handles #5 single speed geared, pair, installed, including handles Barient #22 two speed geared, pair, installed Halyard winch #2 top action, each, installed, including handles Barient #3 reel, installed, each #1 top action (mizzen), installed, Barient winch handle each. Genoa gear 8' stainless steel tracks P/S, 4 track slides, 2 snatch blocks, Dacron genoa sheet Spinnaker gear aluminum spinnaker pole, pole chocks, stainless steel mast track, track slide, blocks for halyard lift, foreguy, sheet and afterguy, complete Dacron rigging with necessary snapshackles, installed Main Sheet Traveller roller bearing slide, "X" track with adjustable stops.

**YOUR CHOICE OF CRUISING EQUIPMENT . . .** Cowl ventilator on forward deck 4" dia., including water tight cover Extra opening port in cabin trunk, installed (instead of standard fixed port) Swimming ladder folds compactly when not in use, stainless steel hull mounts installed Fold-over dinette table fold over leaf is teak wood grain surfaced both sides, with teak trim (instead of one piece table top) (not applicable interior #1) Extra berth folding berth port or starboard main cabin, matching upholstery, installed Cockpit cushions wide choice of colors, to match berth cushions if desired Main Hatch dodger Dacron folding sea-hood, with forward and side windows, to provide protection for cockpit, installed Full length cockpit/cabin top awning Dacron with battens and bridle Main hatch box keeps hatch watertight in rough conditions, fiberglass, installed

**YOUR CHOICE OF SAFETY EQUIPMENT . . .** Bow pulpit, polished stainless steel, custom made with center leg forward to follow stem line, welded lifeline attachment eyes at safe height, installed Lifelines complete including polished stainless steel stanchions with stainless steel bases incorporating welded eyes, bolted through deck and screwed to rail with stainless steel fastenings, 3/8" diameter plastic coated stainless steel safety line with swaged stainless steel end terminals and turnbuckles, gate assembly starboard Double lifelines stainless steel wire, stainless steel turnbuckles Stern pulpit custom made polished stainless steel, welded lifeline attachment eye, installed Spreader lights, pair, switch and fuse on main panel

## YOUR CHOICE OF GALLEY AND ELECTRIC EQUIPMENT...

Galley stove Homstrand alcohol, 2 burner stainless steel, recessed, with stainless steel cover. Hiller alcohol, 3 burner with oven, gimbal mounted, remote tank. Princess 110v., 3 burner with oven, recessed or gimbal mounted. Refrigerator 110v. with remote compressor unit, 6 ice cube trays, thermostat controlled (instead of standard icebox) Hot water system two 110v. rapid heat 1000 watt heaters, one at galley and one in toilet room, thermostat controlled, supply to all faucets and shower (if installed) 10 gallon water heater, 110v. electric plus heat exchanger from main engine cooling system, to supply to all faucets and shower (if installed) Shower telephone handset shower head with shut-off valve and single lever control, 12v. overboard pump with automatic switch, installed Holding tank with recirculation feature and pump-out fittings 110 v. generator 4000 watt driven by main engine, actuated by electric clutch, constant-speed governor, completely installed 110v. shore power connection 3 wire grounded, 30 amp. cockpit receptacle, circuit breakers, polarity indicator, dual outlets to galley and toilet room, 50' 3-wire shore cable Stereo tape system installed complete with matched speakers, 12v. accommodates both 4 and 8 track cartridges

## YOUR CHOICE OF NAVIGATION EQUIPMENT... Compass

Omni 440VL. vertical flush mount, 12v red night lighting, 5" Constellation model C552B or Omni model 580 BID binnacle and dome-head (for pedestal mounting), 12v. red night lighting, installed Depth finder Danforth flush mount model T204C, completely installed Radio direction finder Columbian Aqua-Guide model CB-304 (excluding batteries) Speedometer Kenyon model KSI electronic speedometer, installed Radiotelephone Pearce-Simpson 25 watt pretuned VHF 6 channel with 12' antenna, installed and operating Removable chart table teak grain with teak trim (applicable to interiors #1, #2 and #4 only)

## YOUR CHOICE OF DECOR AND COLORS . . . Standard hull

color is white. Cove stripe and waterline stripe included at no extra cost no limit on colors. Standard deck and interior color oyster. Special hull or deck color any color specified SeaTeak™ hull bright varnished teak wood grain finish on hull Teak transom teak wood grain finish on transom (only) Two color deck any second color Marinium and chromium plated standard deck hardware instead of bronze Teak grain hull lining in forward cabin Teak sliding doors on lockers over dinette installed (instead of open shelf) Teak sliding doors on lockers in toilet room installed (instead of open shelf) Curtain rails above portlights main cabin, installed Carpeted cabin sole Acrilan outdoor carpet, choice of colors Teak cockpit grating to fit cockpit well

**SUBSTANTIAL PRICE REDUCTIONS IF YOU SELECT POPULAR OPTIONAL EQUIPMENT GROUPS! See separate sheet for further information.**

**Seafarer** FIBERGLASS YACHTS, INC.,

Visit our new showroom and plant: 760 Park Avenue, Huntington, L.I., N.Y. 11743 Phone 516-427-6670

All Seafarer sail area measurements are for main, mizzen (if any) and 100% of foretriangle. Prices are f.o.b. Huntington, N. Y. and exclude sails. Seafarer reserves the right to make styling, design, specification and equipment changes without notice. Prices shall be those in effect at time order is received. ©1972 by Seafarer Fiberglass Yachts, Inc.

