

SWALLOWCRAFT

40"

DIMENSIONS

LOA	39'1½"
LWL	31'0"
BEAM	13'4"
DRAFT	5'3"
DISPLACEMENT TO DWL	24,300 LBS
BALLAST	8,937 LBS
SAIL AREA - MAIN	303 SQ FT
- JIB (100%)	345 SQ FT
- MIZZEN	138 SQ FT
TOTAL	786 SQ FT

Lloyd's certification,

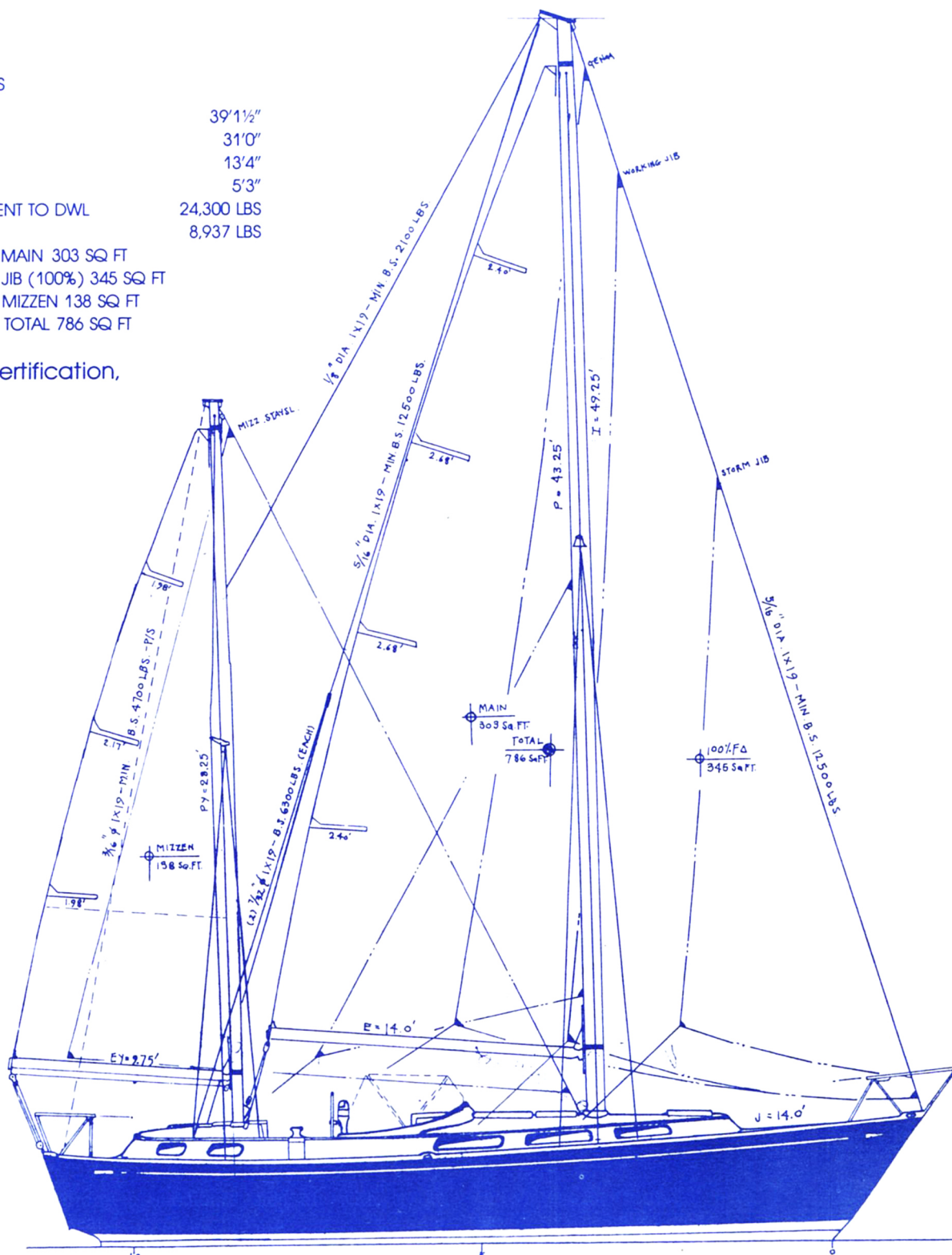

Distributed by:



Paul
LARSEN YACHT SALES
& Assoc., Inc.

301-269-0050
D.C. 261-1035

Port Annapolis Marina
Annapolis, Md. 21403

HULL

Gelcoated finish over fiberglass hand laminated hull shell.

Ballast 9,000 pounds (approximately) lead, one piece casting encapsulated.

DECK

Deck laminate is cored with closed cell vinyl foam or balsa wood, and incorporates cockpit and cabin trunks. Areas where gear and fittings attach have solid laminates for bolting strength. Standard color for the nonskid pattern is sand beige.

DECK GEAR

Cockpit sole and seats—teak.

Hatches—Bomar with lucite tops.

Toe Rail—teak.

Ventilation—two double Dorade boxes.

Winches—Barient or Lewmar.

Blocks and Fittings—Schaefer.

Aluminum—spars. Standing Rigging, Running Rigging, Steering Gear—Wagner or Yacht Specialties.

MECHANICAL

Engine—Perkins 4.108M (40 BHP) 2:1 reduction gear.

55 amp alternator, vibration mounts and lift-type exhaust system.

1¼" stainless steel propeller shaft with stuffing box and stern bearing.

Propeller—2 bladed. 17" diameter x 11" pitch.

TANKAGE

Potable water—100 U.S. gallons.

Bilge pump—gusher manual 15 GPM.

Fuel—50 U.S. gallons.

Hot water—6-gallon tank heated by 115V/220V AC element and/or by circulated engine fresh water coil.

Fresh water pressure pump.

ELECTRICAL

Engine starting battery—12V DC 150 AH.

Ships service battery—12V DC, 150 AH.

Shore power—115V AC receptables for shore cable.

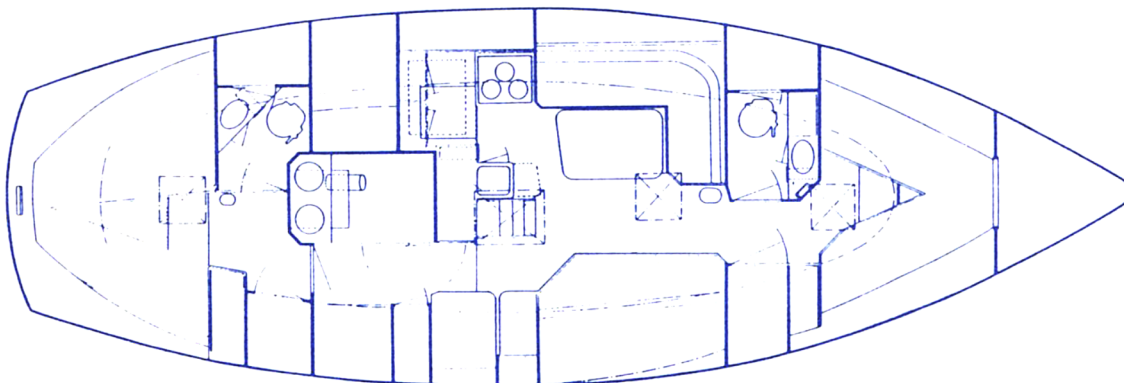

CABIN ARRANGEMENT

Forward Cabin—2 berths, each with one drawer and one drop door under. Traps under mattresses. One bureau and one hanging locker on starboard side. Headroom 6'6".

Toilet room with lavatory and shower on port side. Seat between berths.

Hatch over for light and ventilation.

25-gallon holding tank serves the toilet.

Hot and cold pressurized water in lavatory and shower.

Automatic shower sump pump.

Main Cabin—Port side L-shaped settee with removable backrest.

Fixed dining table.

Starboard side has pilot berth outboard.

Next inboard is a settee—PULL OUT section for berth.

Hatch over for light and ventilation.

U-shaped galley on port side aft with 3 burner propane stove/oven, with Marinetti's safety control, ice box, double sink with hot and cold water pressurized, drawers and lockers.

Headroom 6'6".

Navigation Station—On starboard side aft with chart table and seat.

Cabinets for electronics, books, etc.

Companionway to cockpit between passageway leading aft to after cabin and galley.

In passageway are a wet locker and large storage bin.

Aft Cabin—Port side forward is a toilet room with lavatory and shower.

Toilet is served by 25-gallon holding tank.