

RENOWNED BUILDER OF WORLD CRUISERS

CT PRESENTS THE NEW *Ta Chiao* 34

CT-34' CUTTER

LOA.....33'-3"
BEAM.....10'-3"
DRAFT.....5'-0"
L.W. L.....27'-8"
DISPLACEMENT.....16100 #
BALLAST.....5300 #
SAIL AREA MAIN 283 SQFT
WORKING JIB 200 SQFT.
STAYSAIL/124SQFT.

PEARSON NEWPORT CT LINES

Trans Oceanic Yachts

3400 Via Oporto

Newport Beach, Ca 92660

(714) 675-7674

NEW BROKERAGE USED



SPECIFICATION

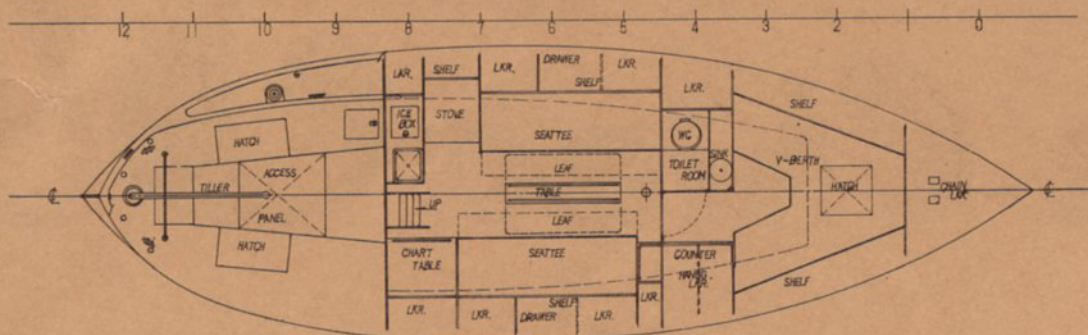

Hull and Deck

One piece heavy molded reinforced fiberglass hull and one piece molded fiberglass deck and cabin. Whole deck and cabin is built in sandwich construction with wooden core for extra strength and insulation. Nonskid finished deck and cabin top is standard. Teak deck is optional.

Spars

Selected spruce, hollow-box mast and booms with bronze and stainless steel fittings. Aluminum spar is optional.

Sails

Main sail is 8 OZ. dacron with two rows of reefing points.

Working jib is 7 OZ. dacron.

Staysail is 6 OZ. dacron with club jib boom and fittings.

Joinerwork and finishing

All exterior and interior to be teak trim, well matched for grain and color. Oiled or natural finish. Varnished finish is optional.

Electrical System

All wiring is done to international specification

12-volt electric power system for dome lights. Reading lights, navigation lights and spreader lights with fuses.

110-volt power system with shore power connector for outlets with circuit breakers.

Plumbing

Two 35 gal. stainless steel water tanks

One 50 gal black iron fuel tank

Hardware

Stainless steel and bronze fittings

Steering

Tiller steering is standard. Worm gear steering is optional.

Engine

Engine is optional. Volvo MD-2B. Volvo MD-3B or equivalent.

Standard equipment

1. Main sail 8 oz. dacron with two rows of reefing points
2. Working jib 7 oz. dacron
3. Staysail 6 oz. dacron
4. Sail covers for main and working jib
5. Necessary wooden blocks with shackles for main, working jib and staysail
6. Two #22 Barlow winches for main and working jib sheets
7. Two #15 Barlow winches for main and working jib halyard
8. Hardwood pinrails and belay pins
9. Two fresh water hand pumps in galley and toilet room.
10. One manual bilge pump
11. One manual toilet
12. Two 35 gal stainless steel water tanks
13. One 50 gal black iron fuel tank
14. Pulpit and stanchions with double lifeline and lifeline gates
15. Anchor roller chocks on bowsprit
16. Teak deck in cockpit area. Teak grating in cockpit
17. Tiller steering
18. Mushroom vent over galley
19. Dorade vent over toilet room
20. Chopping board
21. Vinyl cushions
22. Mirror in the toilet room



TA CHIAO BROS, YACHT BUILDING CO., LTD.