

# Ta Chou

# CT 38

**A world cruiser**

## CT-38' CUTTER

LOA. .... 37'-4"  
 LWL. .... 32'-6"  
 BEAM. .... 11'-9"  
 DRAFT. .... 6'-3"  
 SAIL AREA. .... 900  $\phi$   
 DISPLACEMENT. .... 29,400LBS  
 BALLAST. .... 9200LBS

## GOLDEN WEST YACHTS

14025 PANAY WAY  
 MARINA DEL REY, CA 90291  
 (213) 823-3838

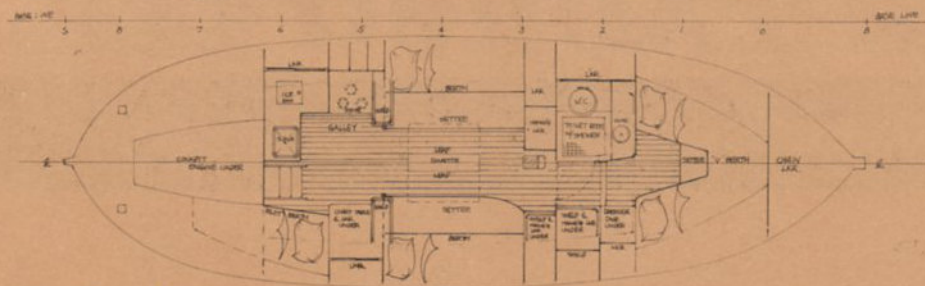
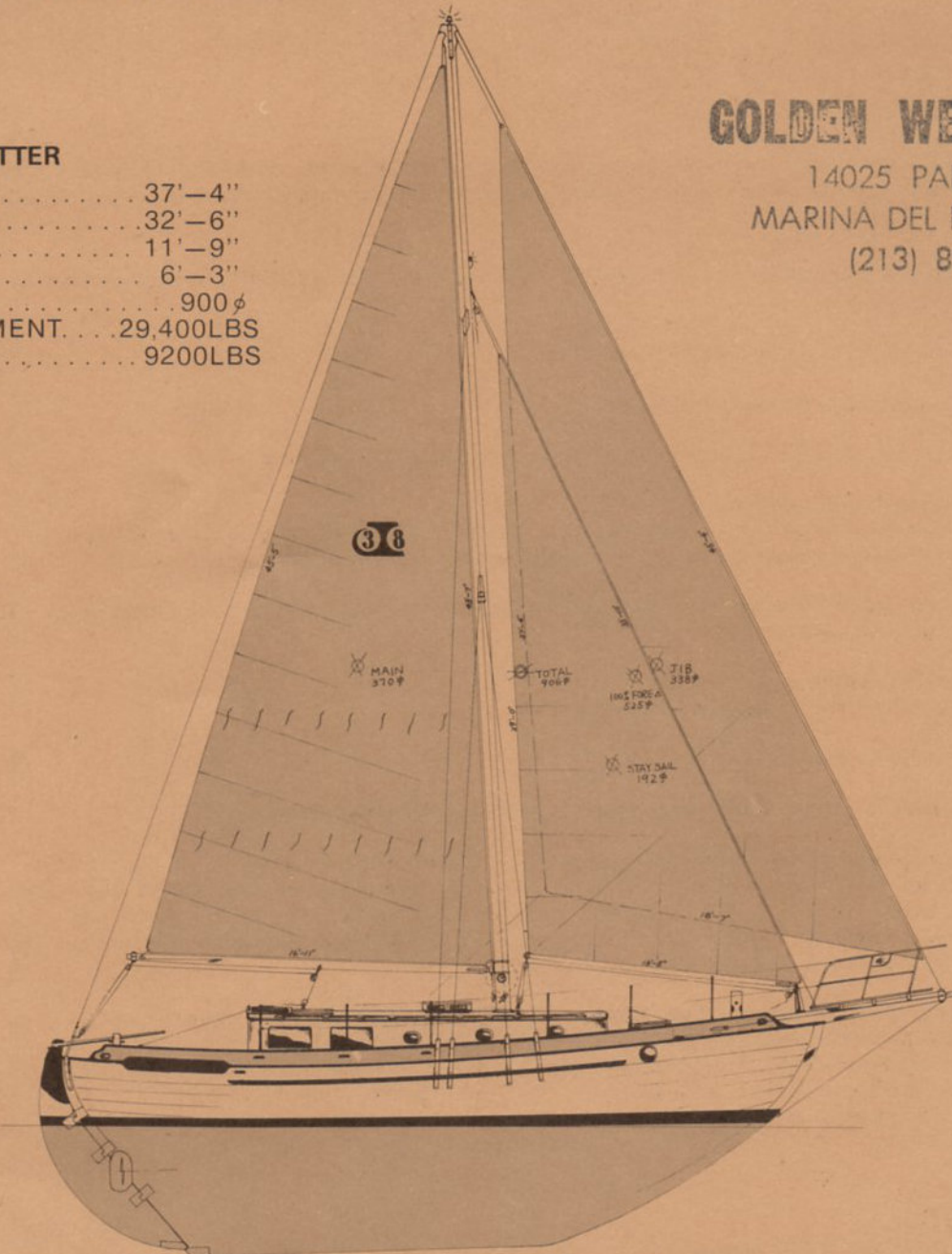

TYPE. A



Detailed floor plan of the boat 'D'. The plan shows a symmetrical layout with a cockpit at the stern, a central cabin area with a dinette and two berths, and a bow area with two berths. The plan is labeled with various rooms and features, including a cockpit, dinette, berths, and a central hallway. The boat is numbered '1' at the stern and '2' at the bow.

### Hull and deck

Spar

## Sails

Jib sail is 8 OZ. dacron.

### Joinerwork and finishing

All exterior and interior to be teak trim. Oiled or natural finish. Varnished finish is optional.

### Electrical System

All wiring is done to international specifications.

12-volt electrical power system for dome lights, reading lights, navigation lights and spreader lights, with fuses.

110-volt power system with shore power connector for hot water heater and outlets with circuit breakers.

## Plumbing

12-volt pressure pump for hot and fresh water system. One manual bilge pump and 12-volt electric bilge pump. 110-volt hot water heater. All thru-hull fittings with seacocks.

### Water and Fuel Tanks

Two 60 gallon stainless steel water tanks.

One 100 gallon black iron fuel tank. Outside primed and painted.

### Steering

Tiller steering. Worm gear is optional.

### Engine

Engine is optional. Suitable Diesel engines for this boat are Volvo MD-3B 36-HP or equivalent.

### Standard Equipment

1. Main sail is 8 oz. dacron with two rows of reefing points.
2. Jib sail is 8 oz. dacron.
3. Staysail is 7 oz. dacron.
4. Sail covers for main, and jib
5. Necessary wooden blocks with shackles for main, jib and staysail
6. Two #22 Barlow winches for jib and staysail sheet.
7. One #20 Barlow winch for main sheet
8. Two #15 Barlow winches for main and jib halyard
9. Pressure pump for hot and cold fresh water system
10. One manual bilge pump and one electric bilge pump
11. One hot water heater.
12. One manual toilet
13. Two 60-gallon stainless steel water tanks
14. One 100-gallon black iron fuel tank
15. Pulpit and stanchions with double lifeline with lifeline gates
16. Tiller steering
17. Dinghy with deck chocks
18. Chopping board
19. Vinyl cushions
20. Mirror in the toilet room
21. Carved name board



# TACHOU



**TACHOU SHIP BUILDING CO., LTD.**