

MAIN SAIL.
CUT. SLIGHT
SALES -
SLIGHT &
IN THE Y
LACED F

MIZZEN SAIL
CUT. SLIGHT
SLIGHT F
FOOT TO
FOOT W

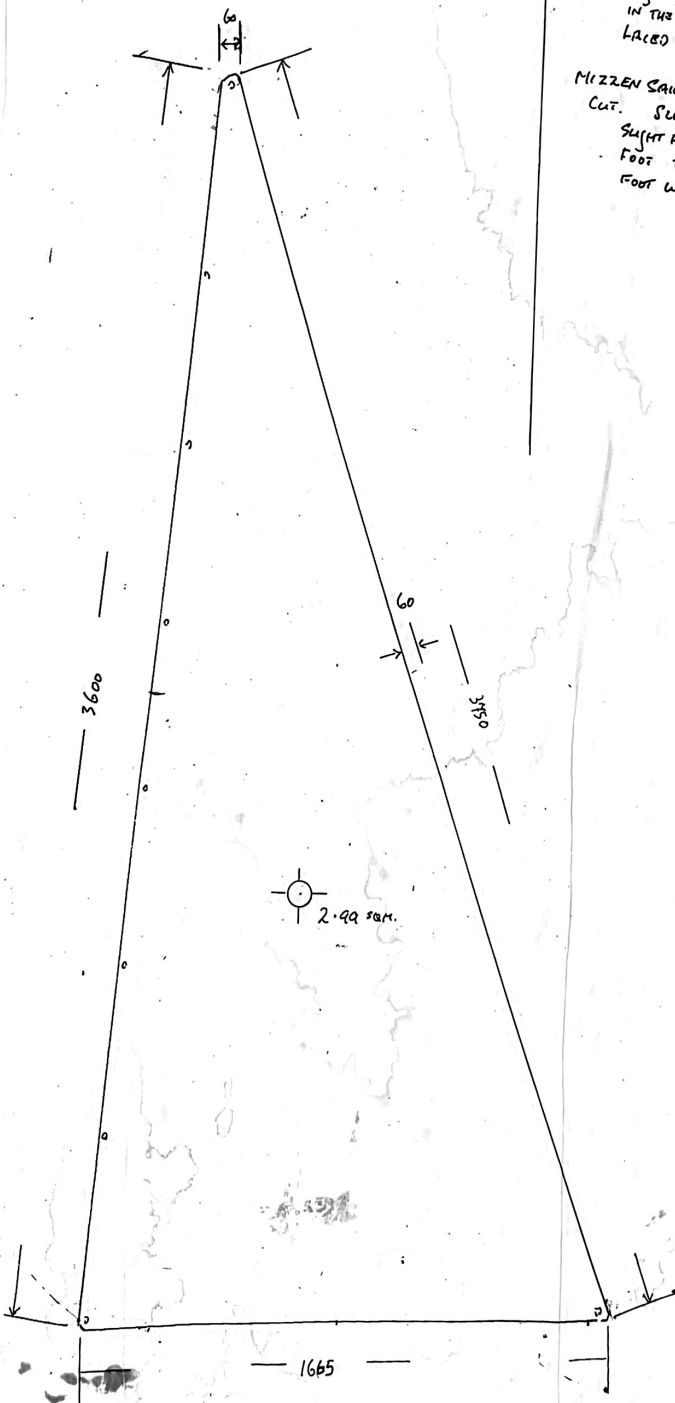

1665

3600

3450

60

87

2.99 SAM

SAILS. SAIL MAKERS NOTES.

MAIN & MIZZEN - CLOTH WEIGHTS.

US 5 1/4 oz UK 6 1/2 oz METRIC 220 gr

PER SQ YD. PER SQ. YD. PER SQ. M.

MAIN SAIL.

CUT. SLIGHTLY FULL. THIS IS THE FORWARD OF THE BOATS TWO
SAILS - DRAFT 55% AFT - FLAT FORWARD - FLAT LEACH.
SLIGHT EXTRA SHAPE IN HEAD TO ACCOMMODATE EYES
IN THE YARD TO FLATTEN THE SAIL WHEN NEEDED.
LACED FOOT AS SHOWN, WITH SHELF TO SHAPE.

MIZZEN SAIL

CUT. SLIGHTLY FLAT, ROUND LEAF TO ACCOMMODATE
SLIGHT EXCESS IN THE MAST UNDER LOAD.
FOOT TO BE CUT STRAIGHT - NO ROUND AT ALL. FIT
FOOT WITH HEAVY TAPE FOR TENSION.